

F.A.P. RTE.	SECTION	COUNTY	TOTAL SHEETS	SHEET NO.
1285	02-00075-00-PV	COOK	161	58
STA. _____ TO STA. _____		FED. ROAD DIST. NO. - ILLINOIS FED. AID PROJECT		
CONTRACT NO. 63083				

BEGIN PROJECT
STA. 51+35.35

END PROJECT
STA. 61+80.00

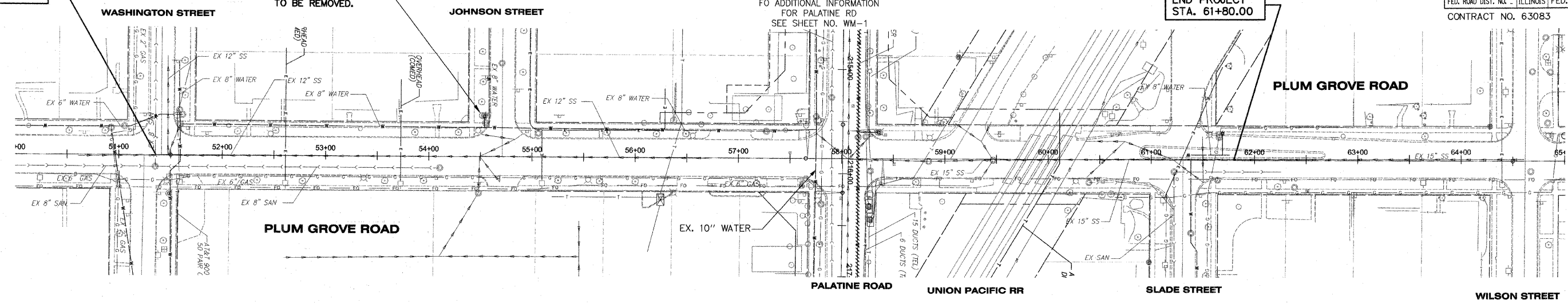

EXISTING CONDITIONS

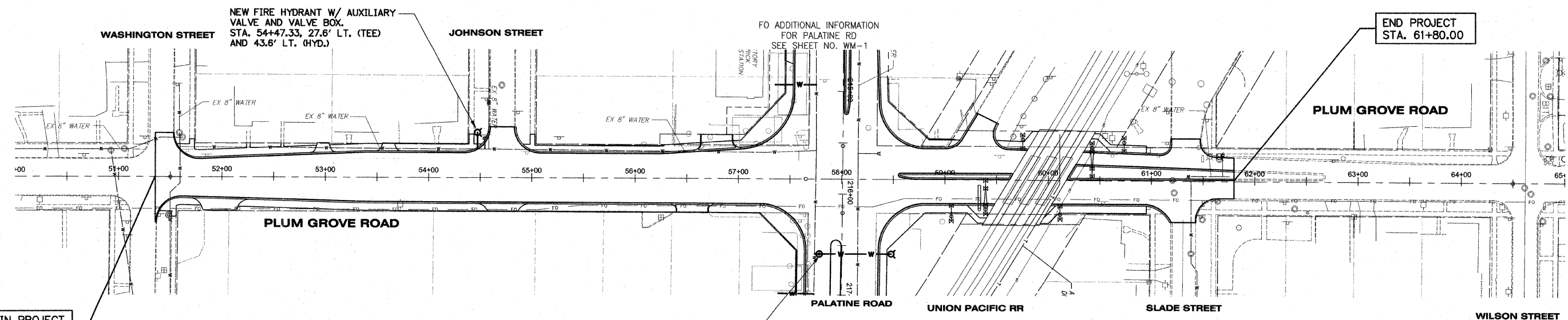

PROPOSED IMPROVEMENTS

BEGIN PROJECT
STA. 51+35.35

END PROJECT
STA. 61+80.00

NEW FIRE HYDRANT W/ AUXILIARY
VALVE AND VALVE BOX.
STA. 54+47.33, 27.6' LT. (TEE)
AND 43.6' LT. (HYD.)

8" GATE VALVE IN 5' Ø VAULT,
TAPPING VALVE AND SLEEVE
(PRESSURE CONNECTION 10"x8").
STA. 216+58.14, 32.1' LT.

REVISIONS	
NAME	DATE

ILLINOIS DEPARTMENT OF TRANSPORTATION
VILLAGE OF PALATINE
PALATINE ROAD & PLUM GROVE ROAD RECONSTRUCTION
SMITH STREET TO US 14 (NORTHWEST HIGHWAY)
WATER MAIN PLAN - PLUM GROVE ROAD
STA. 51+35.35 TO STA. 60+95.14
SCALE: VERT. _____
HORIZ. _____
DATE: OCTOBER 19, 2009
DRAWN BY _____
CHECKED BY _____