

PLAN	SURVEYED	BY	DATE
	PLOTTED		
	CHECKED		
	REVIEWED		
	DATE		
	NO.		
	FILE NAME		

PROFILE	SURVEYED	BY	DATE
	PLOTTED		
	CHECKED		
	REVIEWED		
	DATE		
	NO.		
	FILE NAME		

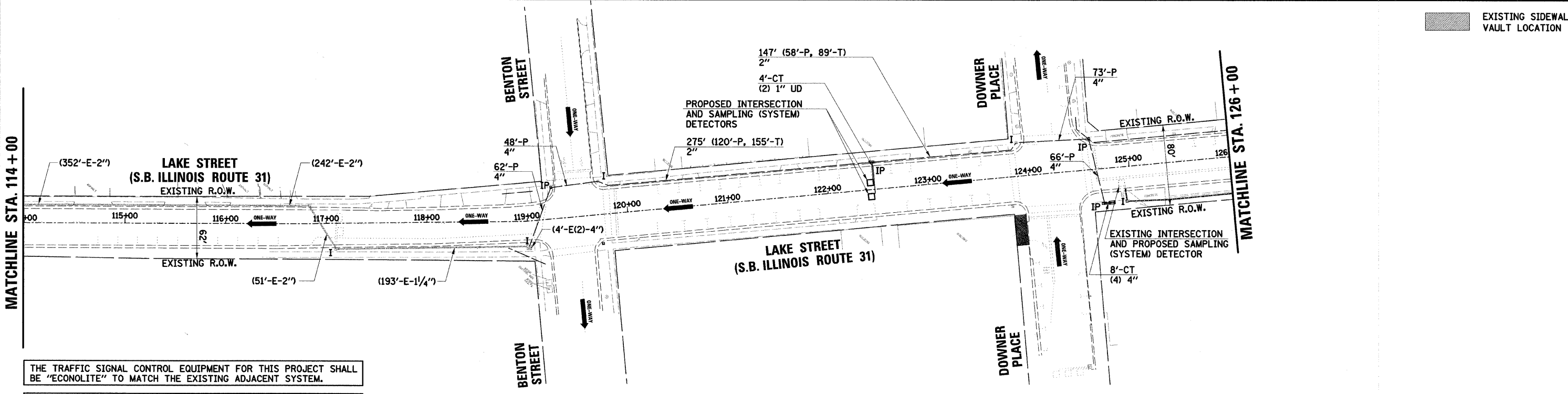
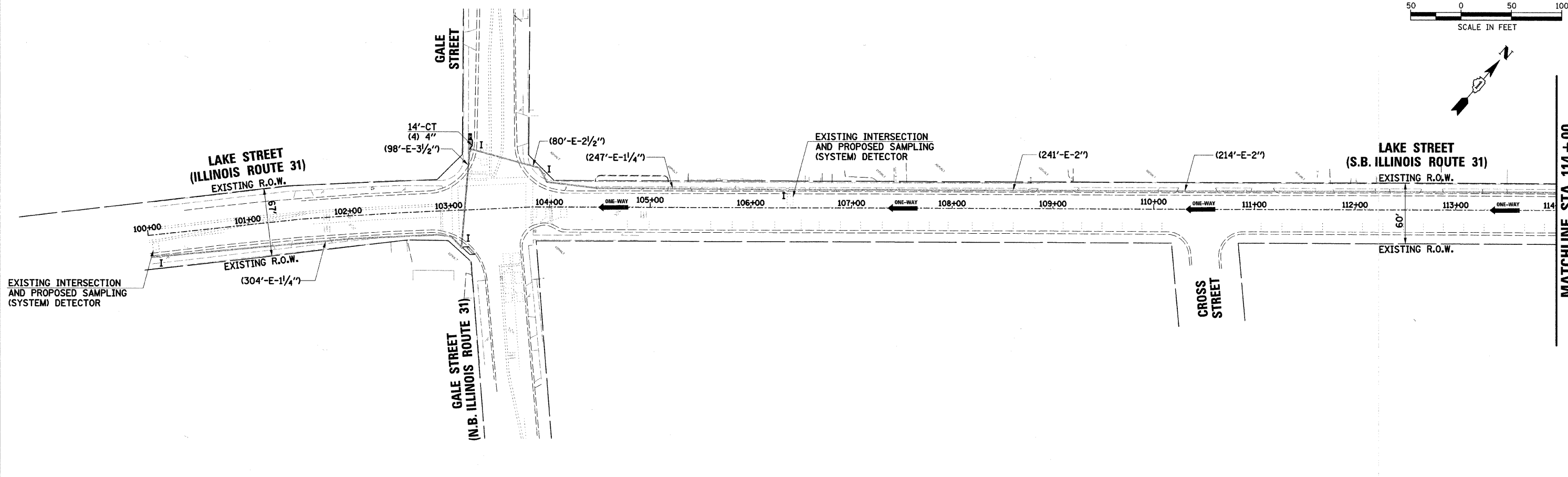
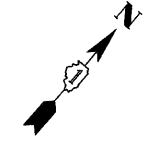
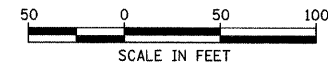

THE TRAFFIC SIGNAL CONTROL EQUIPMENT FOR THIS PROJECT SHALL BE "ECONOLITE" TO MATCH THE EXISTING ADJACENT SYSTEM.

**RESTORATION OF WORK AREA:**  
 RESTORATION OF THE TRAFFIC SIGNAL WORK AREA SHALL BE INCIDENTAL TO THE RELATED PAY ITEM SUCH AS FOUNDATION, CONDUIT, HANDHOLE, TRENCH AND BACKFILL, ETC., AND NO EXTRA COMPENSATION SHALL BE ALLOWED. ALL ROADWAY SURFACES SUCH AS SHOULDERS, MEDIANS, SIDEWALKS, PAVEMENT, ETC. SHALL BE REPLACED IN KIND. ALL DAMAGE TO MOWED LAWNS SHALL BE REPLACED WITH AN APPROVED SOD, AND ALL DAMAGE TO UNMOWED FIELDS SHALL BE SEEDED IN ACCORDANCE WITH STANDARD SPECIFICATIONS 252 AND 250 RESPECTIVELY.

FILE NAME = ...\\f:\in.dwg\890\_2.sigint.01.dgn

USER NAME = \_USER\_

DESIGNED -

REVISED -

DRAWN *JMR*

REVISED -

CHECKED *JRS*

REVISED -

DATE -

REVISED -

STATE OF ILLINOIS  
 DEPARTMENT OF TRANSPORTATION

INTERCONNECT PLAN  
 SHEET 1 OF 5

F.A.U. RTE.	SECTION	COUNTY	TOTAL SHEETS	SHEET NO.
3902	05-00258-00-TL	KANE	61	50
FED. ROAD DIST. NO.		ILLINOIS FED. AID PROJECT		CONTRACT NO. 63251

SCALE: SHEET NO. OF SHEETS STA. TO STA.