

MFT FIELD ENGINEER: MELCHOR MANGOBA 1-847-705-4408
 CONSULTANT: HOFFERLE BUTLER ENGINEERING, INC. 1-708-599-8980

STATE OF ILLINOIS

DEPARTMENT OF TRANSPORTATION

DIVISION OF HIGHWAYS

PLANS FOR PROPOSED
 FEDERAL AID HIGHWAY

FAU RTES. 1537 (71st STREET) & 2802 (SAYRE AVENUE)
 71st ST @ HARLEM AVE TO SAYRE AVE @ 73rd ST
 ROADWAY RESURFACING
 SECTION NO. 09-00032-00-RS
 PROJECT NO: M-9003 (388)
 JOB NO: C-91-750-09
 VILLAGE OF BEDFORD PARK
 COOK COUNTY

FAU RTE.	SECTION	COUNTY	TOTAL SHEETS	SHEET NO.
2802/1537	09-00032-00-RS	COOK	18	1
STA. 10+00		TO STA. 37+87.89		
FED. ROAD DIST. NO.		ILLINOIS	FED. AID PROJECT	
CONTRACT NO. 63410				

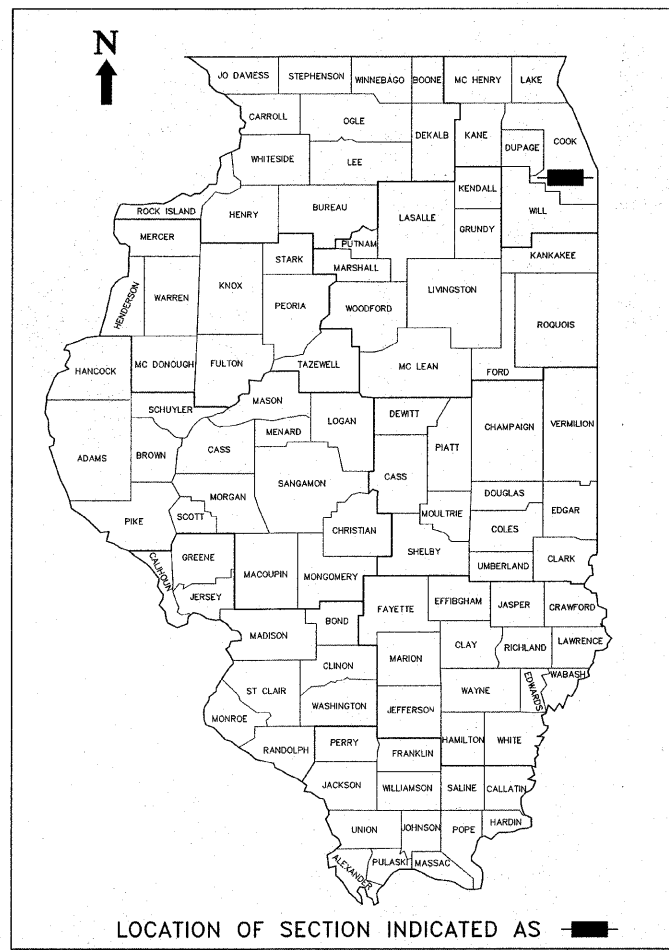

LOCATION OF SECTION INDICATED AS [black rectangle]

STATE OF ILLINOIS
 DEPARTMENT OF TRANSPORTATION
 DIVISION OF HIGHWAYS

APPROVED JANUARY 4, 2010
[Signature]
 VILLAGE OF BEDFORD PARK, PRESIDENT

PASSED FEBRUARY 1, 2010
[Signature]
 DISTRICT # ENGINEER OF LOCAL ROADS & STREETS

RELEASING FOR BID
 BASED ON LIMITED
 REVIEW FEBRUARY 2, 2010
[Signature]
 DEPUTY DIRECTOR OF HIGHWAYS/REGION 1 ENGINEER

INDEX TO SHEETS:

SHEET NO.	DESCRIPTION
1.	COVER SHEET
2.	GENERAL NOTES
3.	HMA MIXTURE CHART & SUMMARY OF QUANTITIES
4.	STRUCTURAL DESIGN INFO
4-5.	TYPICAL SECTIONS
6-9.	PLAN SHEETS
10.	TRAFFIC CONTROL PLAN - DETOUR ROUTE
11.	TRAFFIC CONTROL PLAN - STAGE I
12.	TRAFFIC CONTROL PLAN - STAGE II
13.	PAVEMENT MARKING PLAN
14.	DISTRICT 1 DETAIL-TC10-TRAFFIC CONTROL AND PROTECTION FOR SIDE ROADS
15.	DISTRICT 1 DETAIL-TC13-TYPICAL PAVEMENT MARKINGS
16.	DISTRICT 1 DETAIL-BD24-CURB OR CURB AND GUTTER R&R
17.	DISTRICT 1 DETAIL-BD32-BUTT JOINT AND HMA TAPER DETAIL
18.	DISTRICT 1 DETAIL-TS07-DETECTOR LOOP INSTALLATION DETAIL FOR ROADWAY RESURFACING

HIGHWAY STANDARDS:

STANDARD NO.	DESCRIPTION
000001-05:	STANDARD SYMBOLS, ABBREVIATIONS AND PATTERNS
424001-05:	SIDEWALK RAMPS ACCESSIBLE TO THE HANDICAPPED
602301-02:	INLET, TYPE A
604001-03:	FRAMES & LIDS, TYPE 1
606001-04:	CONCRETE CURB AND COMBINATION CONCRETE CURB AND GUTTER
701801-04:	LANE CLOSURE MULTILANE 1W OR 2W CROSSWALK OR SIDEWALK CLOSURE
701901-01:	TRAFFIC CONTROL DEVICES
780001-02:	TYPICAL PAVEMENT MARKINGS

ADT=9000 VPD (2009)
 DESIGN DESIGNATION - COLLECTOR
 SPEED LIMIT=30 MPH
 DESIGN SPEED = 30 MPH

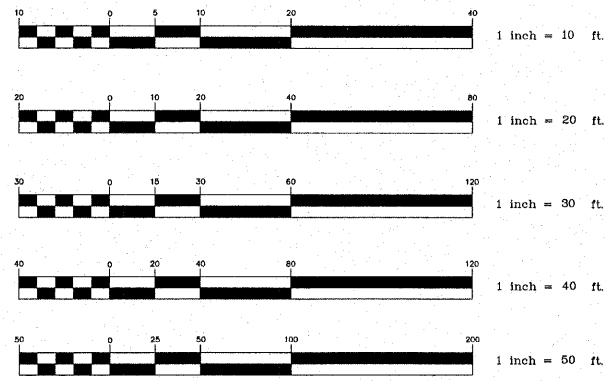

FULL SIZE PLANS HAVE BEEN PREPARED USING STANDARD ENGINEERING SCALES. REDUCED SIZED PLANS WILL NOT CONFORM TO STANDARD SCALES. IN MAKING MEASUREMENTS ON REDUCED PLANS, THE ABOVE SCALES MAY BE USED

J.U.L.I.E.
 JOINT UTILITY LOCATION FOR EXCAVATION
 1-800-892-0123 -OR- 811

CONTRACT NO. 63410

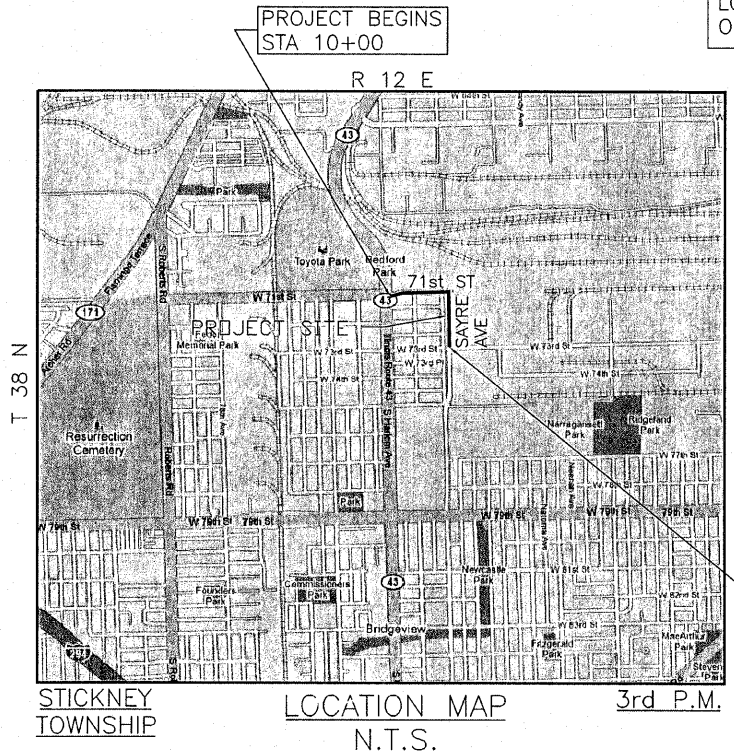

THE PROJECT IS
 LOCATED IN THE VILLAGE
 OF BEDFORD PARK

PROJECT ENDS
 STA 37+87.89

GROSS LENGTH OF PROJECT 2,787.89 FEET (0.53 MILES)
 NET LENGTH OF PROJECT 2,787.89 FEET (0.53 MILES)

hbe Hoefflerle-Butler Engineering, Inc.
 Consulting Civil Engineers Land Surveyors
 PROFESSIONAL DESIGN FIRM LICENSE NO. 084-008819
 8714 S. ROBERTS ROAD HICKORY HILLS, ILLINOIS 60457
 (708) 599-8900 FAX (708) 599-8790



[Signature]
 SIGNATURE
 1/14/10
 DATE

EXPIRES 11-30-11
 (PRINTED BY AUTHORITY OF THE STATE OF ILLINOIS)