

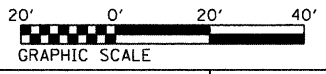

LEGEND:

- GAS PIPE
- ABANDONED GAS PIPE
- ELECTRIC AERIAL CABLE
- ELECTRIC CABLE
- TELEPHONE CABLE
- ABANDONED WATER PIPE
- WATER PIPE
- FIBER OPTIC
- MWRD SEWER
- SANITARY SEWER
- COMBINED SAN SEWER
- STORM SEWER
- STORM SEWER TO BE ABANDONED
- ROW LINE
- CATCH BASIN
- STORM MANHOLE
- STORM SEWER NUMBER
- STORM SEWER LATERAL NUMBER
- CB TO BE REMOVED
- CB TO BE FILLED
- CB TO BE ADJUSTED
- CB TO BE CLEANED
- STRUCTURES TO BE ADJUSTED
- CATCH BASIN
- MANHOLE
- STORM SEWER
- LIGHT POLE (FOR REFERENCE USE ONLY)

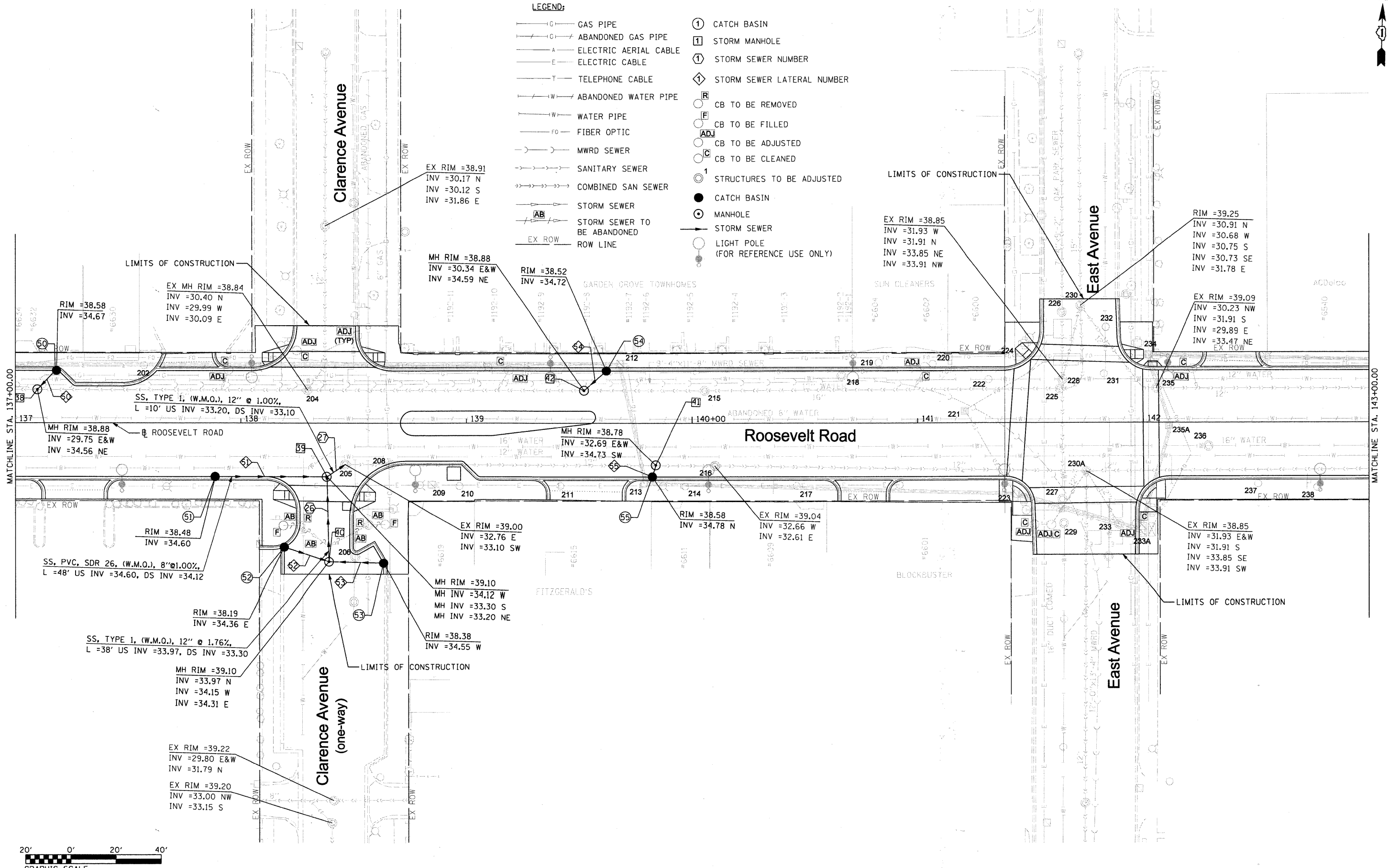

FILE NAME = DIRTE38-shst-drain08.dgn	USER NAME = 100T	DESIGNED - DA	REVISED -
		DRAWN - CC	REVISED -
		CHECKED - JB	REVISED -
		DATE	REVISED -
	PLOT SCALE = 20.0000' / IN.		
	PLOT DATE = 3/23/2010		

**STATE OF ILLINOIS
DEPARTMENT OF TRANSPORTATION**

DRAINAGE AND UTILITIES PLAN

SCALE: 1" = 20' SHEET NO. 8 OF 30 SHEETS STA. 137+00.00 TO STA. 143+00.00

F.A.P. RTE.	SECTION	COUNTY	TOTAL SHEETS	SHEET NO.
347	09-00248-00-RS	COOK	274	101
CONTRACT NO. 63432			ILLINOIS FED. AID PROJECT	