

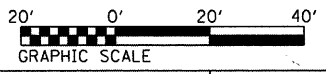

- LEGEND:**
- GAS PIPE
 - ABANDONED GAS PIPE
 - ELECTRIC AERIAL CABLE
 - ELECTRIC CABLE
 - TELEPHONE CABLE
 - ABANDONED WATER PIPE
 - WATER PIPE
 - FIBER OPTIC
 - MWRD SEWER
 - SANITARY SEWER
 - COMBINED SAN SEWER
 - STORM SEWER
 - STORM SEWER TO BE ABANDONED
 - EX ROW LINE
 - CATCH BASIN
 - STORM MANHOLE
 - STORM SEWER NUMBER
 - STORM SEWER LATERAL NUMBER
 - CB TO BE REMOVED
 - CB TO BE FILLED
 - CB TO BE ADJUSTED
 - CB TO BE CLEANED
 - STRUCTURES TO BE ADJUSTED
 - CATCH BASIN
 - MANHOLE
 - STORM SEWER
 - LIGHT POLE (FOR REFERENCE USE ONLY)

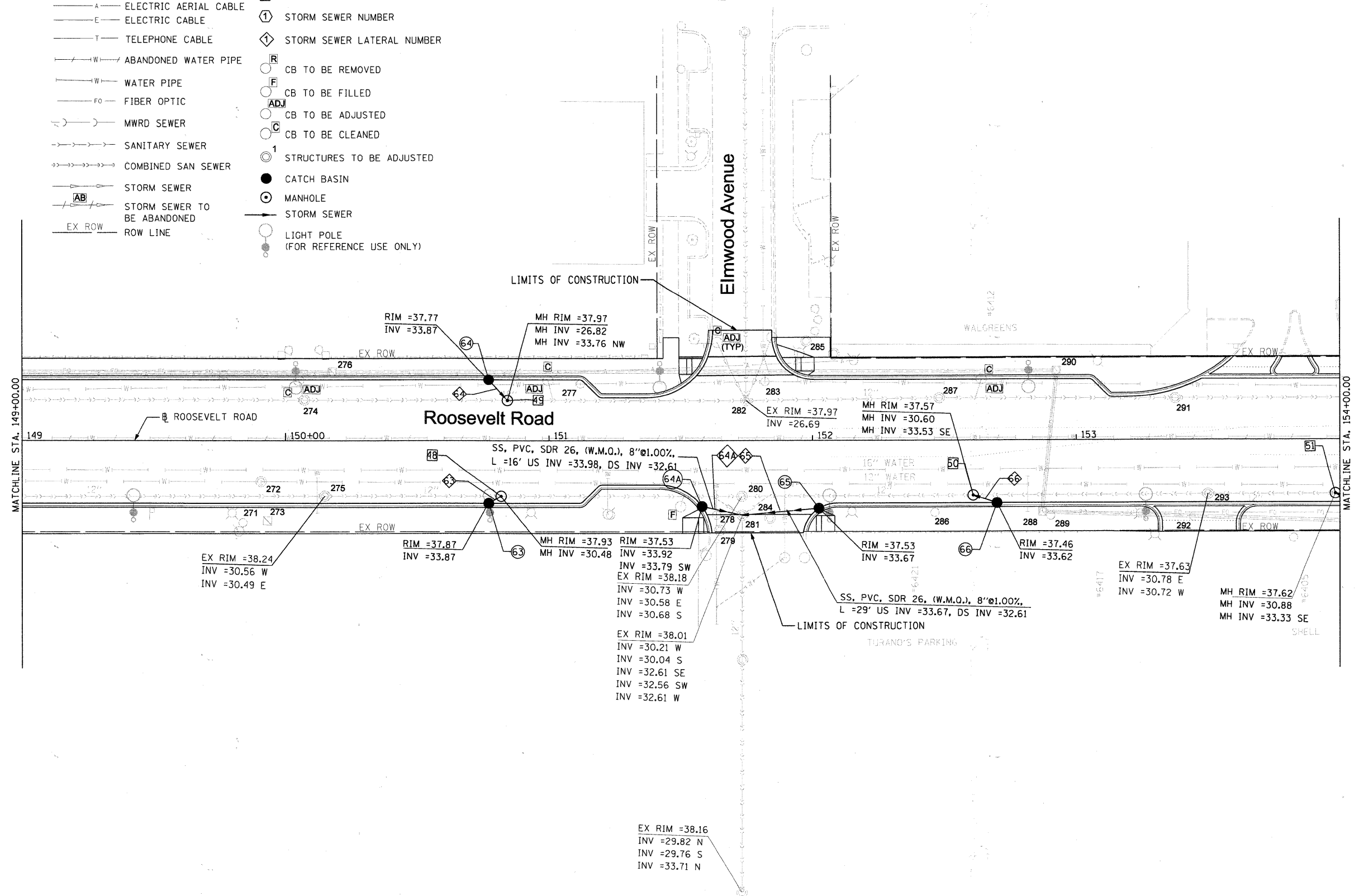

FILE NAME = DIRTE38-shd-drain10.dgn	USER NAME = IDOT	DESIGNED - DA	REVISED -	STATE OF ILLINOIS DEPARTMENT OF TRANSPORTATION	DRAINAGE AND UTILITIES PLAN	F.A.P. RTE. 347	SECTION 09-00248-00-RS	COUNTY COOK	TOTAL SHEETS 274	SHEET NO. 103		
PLOT SCALE = 20.0000' / IN.	CHECKED - JB	DATE -	REVISED -			SCALE: 1" = 20'	SHEET NO. 10 OF 30 SHEETS	STA. 149+00.00 TO STA. 154+00.00	CONTRACT NO. 63432			
PLOT DATE = 3/23/2010	DATE -	REVISED -	REVISED -			ILLINOIS FED. AID PROJECT						