

PAVEMENT MARKING LEGEND

- ① 2-4" THERMOPLASTIC YELLOW SOLID LINES @ 11" C-C
- ② 6" THERMOPLASTIC WHITE SOLID LINE
- ③ 4" THERMOPLASTIC YELLOW SOLID LINE
- ④ 4" THERMOPLASTIC WHITE SKIP DASH LINE (10' DASH, 30' SKIP)
- ⑤ 4" THERMOPLASTIC YELLOW SKIP DASH LINE (10' DASH, 30' SKIP)
- ⑥ THERMOPLASTIC WHITE LETTERS AND SYMBOLS
- ⑦ 12" THERMOPLASTIC WHITE SOLID LINE
- ⑧ 12" THERMOPLASTIC YELLOW SOLID LINE
- ⑨ 24" THERMOPLASTIC WHITE SOLID LINE

PAVEMENT MARKING NOTES

1. FOR PAVEMENT MARKING DETAILS, SEE SPECIAL DETAIL SHEET FOR "DISTRICT ONE TYPICAL PAVEMENT MARKINGS."
2. FOR DETAILS AND SYMBOLS OF RAISED REFLECTIVE PAVEMENT MARKERS, SEE SPECIAL DETAIL FOR "TYPICAL APPLICATION OF DUAL DIRECTIONAL SNOWPLOWABLE RAISED PAVEMENT MARKERS." DOUBLE LANE LINE MARKERS WILL BE USED.
3. THE PAVEMENT MARKING FOR THE DECORATIVE CROSSWALKS SHALL BE PLACED IMMEDIATELY ADJACENT TO THE CROSSWALK ON THE HMA PAVEMENT.

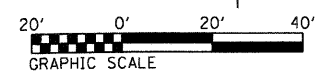
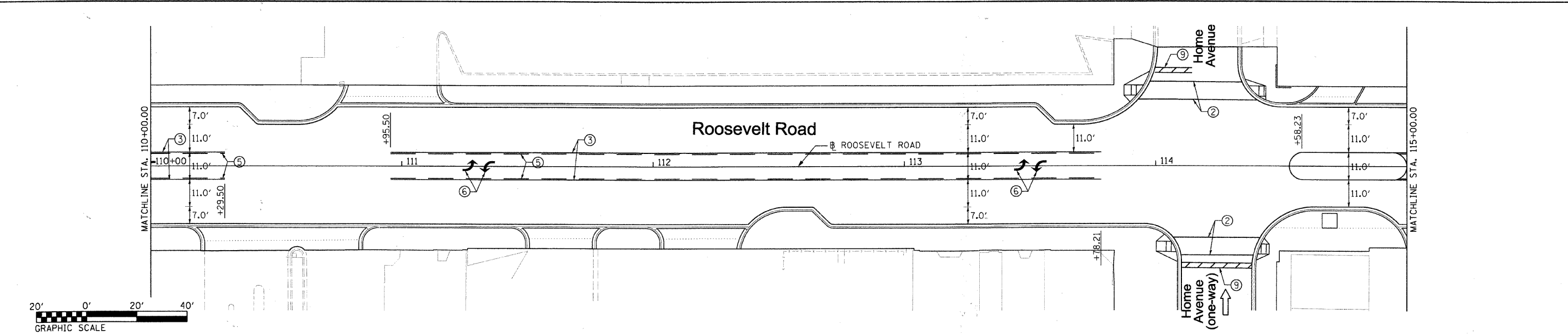
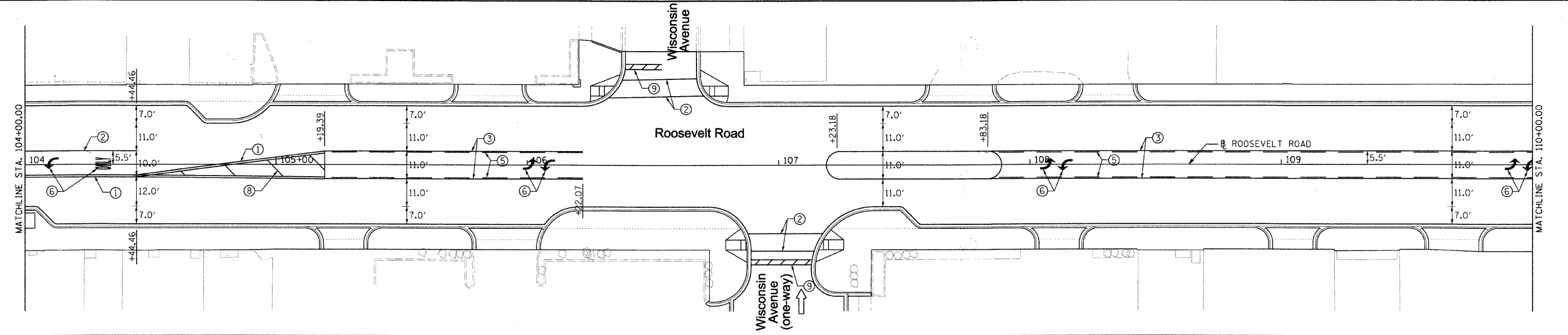
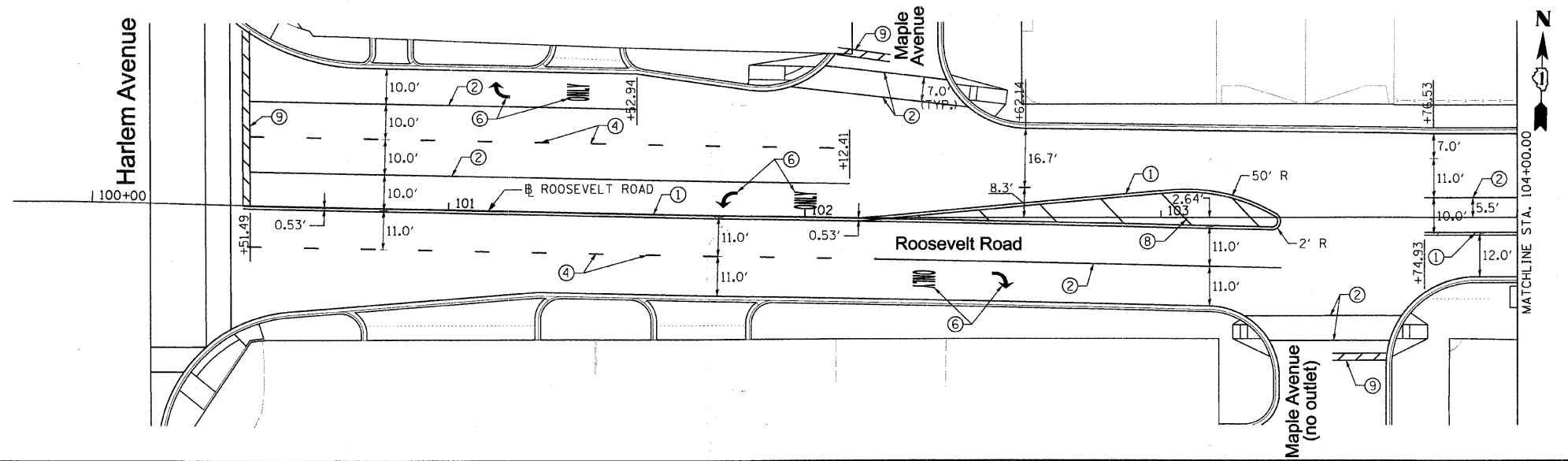

FILE NAME = DIRTE38-shs-pnk01.dgn	USER NAME = 100T	DESIGNED - BB	REVISED -	STATE OF ILLINOIS DEPARTMENT OF TRANSPORTATION	PAVEMENT MARKING PLAN			F.A.P. RTE. = 347	SECTION = 09-00248-00-RS	COUNTY = COOK	TOTAL SHEETS = 274	SHEET NO. = 153	
	PLOT SCALE = 20.0000' / IN.	CHECKED - JB	REVISED -		SCALE: 1" = 20'			SHEET NO. 1 OF 5 SHEETS	STA. 100+16.20 TO STA. 115+00.00	CONTRACT NO. 63432			
	PLOT DATE = 3/11/2018	DATE =	REVISED -		ILLINOIS FED. AID PROJECT								