

PROPOSED PLAN

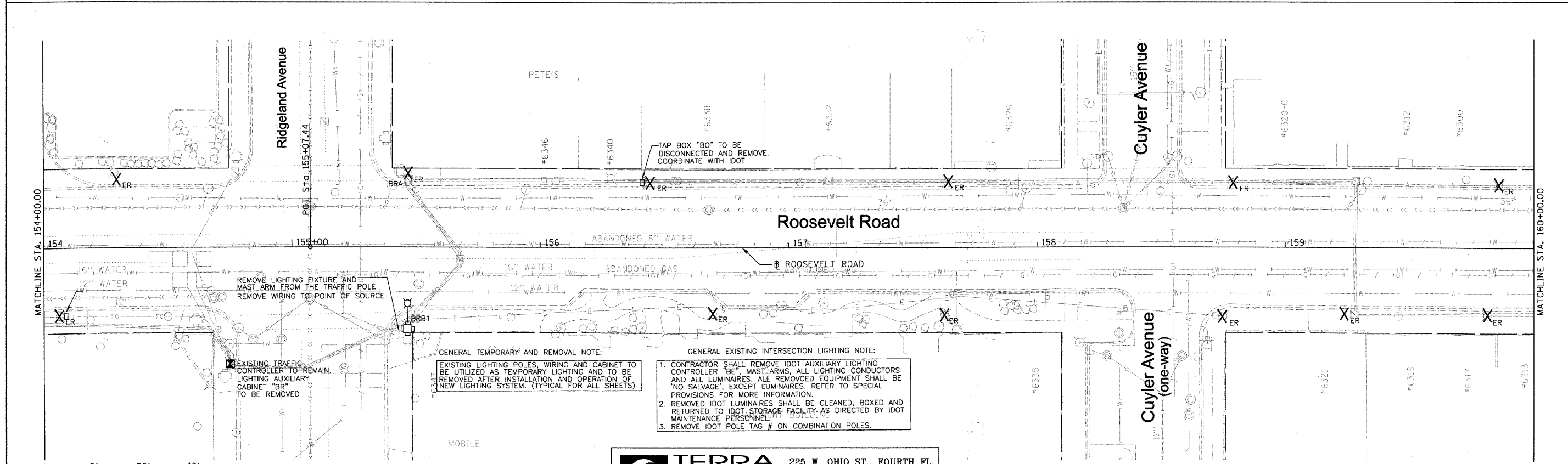

REMOVAL PLAN

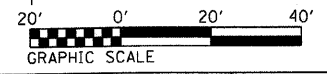

FILE NAME - DIR\E38-sht-light17.dgn	USER NAME - IDOT	DESIGNED - EE	REVISED -
	PLT SCALE = 20,000' / IN.	DRAWN - PY	REVISED -
	PLT DATE = 3/11/2018	CHECKED - JB	REVISED -
		DATE -	REVISED -

TERRA ENGINEERING LTD.
 225 W. OHIO ST., FOURTH FL.
 CHICAGO, IL 60654
 (312)467-0123

**STATE OF ILLINOIS
 DEPARTMENT OF TRANSPORTATION**

**LIGHTING INSTALLATION
 AND REMOVAL PLAN**
 SCALE: 1" = 20' SHEET NO. 17 OF 29 SHEETS STA. 154+00.00 TO STA. 160+00.00

F.A.P. RTE. 347	SECTION 09-00248-00-RS	COUNTY COOK	TOTAL SHEETS 274	SHEET NO. 237
CONTRACT NO. 63432				
ILLINOIS FED. AID PROJECT				

GENERAL TEMPORARY AND REMOVAL NOTE:
 EXISTING LIGHTING POLES, WIRING AND CABINET TO BE UTILIZED AS TEMPORARY LIGHTING AND TO BE REMOVED AFTER INSTALLATION AND OPERATION OF NEW LIGHTING SYSTEM. (TYPICAL FOR ALL SHEETS)

GENERAL EXISTING INTERSECTION LIGHTING NOTE:
 1. CONTRACTOR SHALL REMOVE IDOT AUXILIARY LIGHTING CONTROLLER "BE", MAST ARMS, ALL LIGHTING CONDUCTORS AND ALL LUMINAIRES. ALL REMOVED EQUIPMENT SHALL BE "NO SALVAGE", EXCEPT LUMINAIRES. REFER TO SPECIAL PROVISIONS FOR MORE INFORMATION.
 2. REMOVED IDOT LUMINAIRES SHALL BE CLEANED, BOXED AND RETURNED TO IDOT STORAGE FACILITY AS DIRECTED BY IDOT MAINTENANCE PERSONNEL.
 3. REMOVE IDOT POLE TAG # ON COMBINATION POLES.

REMOVE LIGHTING FIXTURE AND MAST ARM FROM THE TRAFFIC POLE
 REMOVE WIRING TO POINT OF SOURCE

EXISTING TRAFFIC CONTROLLER TO REMAIN
 LIGHTING AUXILIARY CABINET "BR" TO BE REMOVED

TAP BOX "BO" TO BE DISCONNECTED AND REMOVE. COORDINATE WITH IDOT

MOBILE