

NOTES:
 1.) CROSS SLOPE OF PROPOSED BIKE PATH TO DRAIN TOWARD COM-ED EASEMENT PROPERTY, UNLESS SPECIFIED OTHERWISE.
 2.) TYPICAL DITCH IS 1.0 FOOT BELOW EDGE OF 3 FOOT EARTH SHOULDER WITH 3:1 SIDE SLOPES AND A 2 FOOT DITCH BOTTOM UNLESS OTHERWISE SPECIFIED.

F. A. U. NO.	SECTION	COUNTY	TOTAL SHEETS	SHEET NO.
1600	06-00008-00-BT	WILL	73	49
STA. 138+00		TO STA. 143+00		
FED. ROAD DIST. NO. 1	ILLINOIS	FED. AID PROJECT	CMM-0001 (673)	

CONTRACT #63440

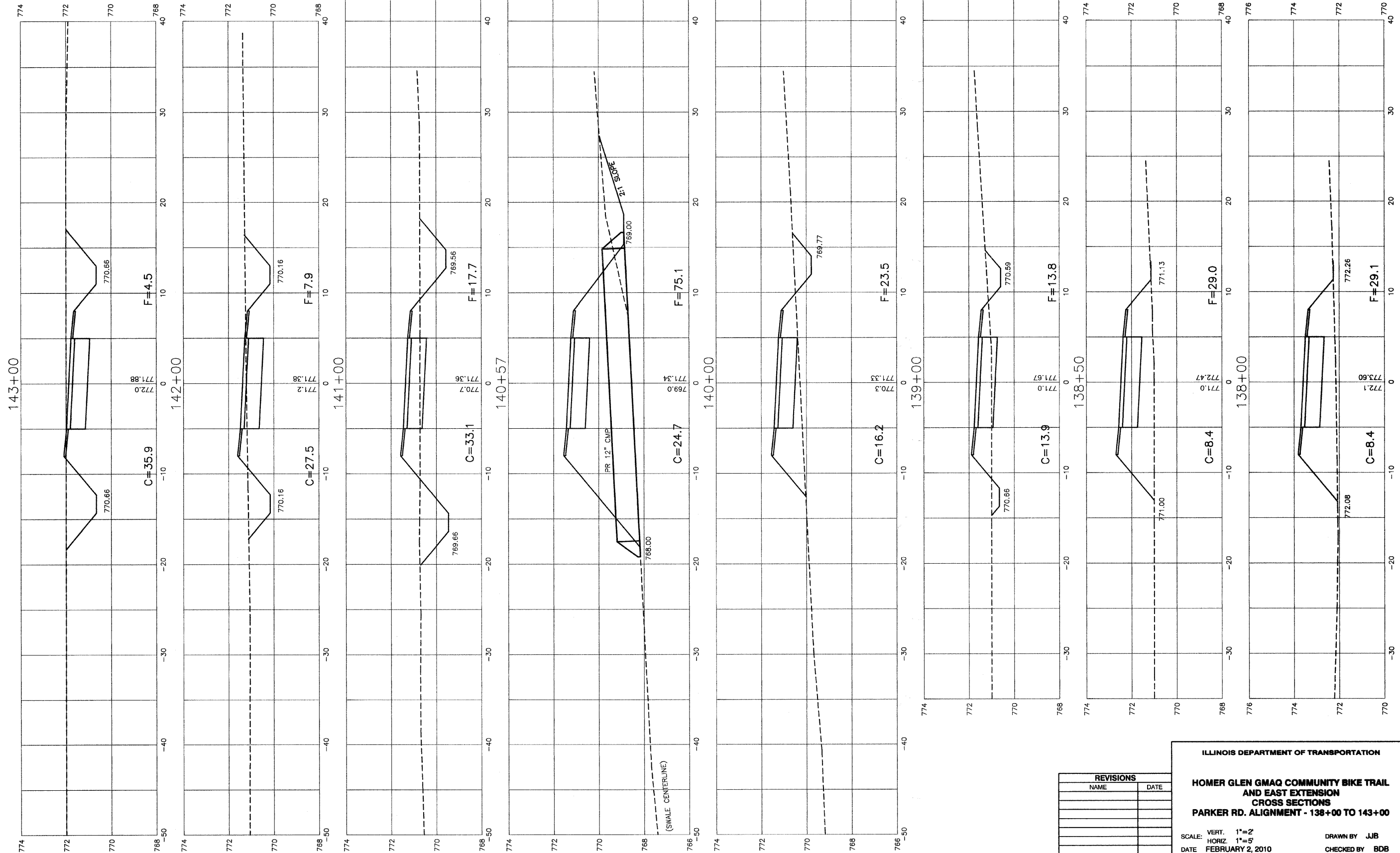

REVISIONS	
NAME	DATE

ILLINOIS DEPARTMENT OF TRANSPORTATION
HOMER GLEN GMAQ COMMUNITY BIKE TRAIL AND EAST EXTENSION CROSS SECTIONS
PARKER RD. ALIGNMENT - 138+00 TO 143+00
 SCALE: VERT. 1"=2'
 HORIZ. 1"=5'
 DATE: FEBRUARY 2, 2010
 DRAWN BY: JJB
 CHECKED BY: BDB
ROBINSON ENGINEERING, LTD.
 1700 SOUTH PARK AVENUE, SOUTH HOLLAND, ILLINOIS 60473
 (708) 321-6700 FAX (708) 321-9888
 ILLINOIS DESIGN FIRM REGISTRATION NO. 19602728 06231-XSCT-01-P2