

NOTES:
 1.) CROSS SLOPE OF PROPOSED BIKE PATH TO DRAIN TOWARD COM-ED EASEMENT PROPERTY, UNLESS SPECIFIED OTHERWISE.
 2.) TYPICAL DITCH IS 1.0 FOOT BELOW EDGE OF 3 FOOT EARTH SHOULDER WITH 3:1 SIDE SLOPES AND A 2 FOOT DITCH BOTTOM UNLESS OTHERWISE SPECIFIED.

F. A. L. ETC.	SECTION	COUNTY	TOTAL SHEETS	SHEET NO.
1600	06-00008-00-BT	WILL	73	50
STA. 144+00	TO STA. 154+00			
FED. ROAD DIST. NO. 1	ILLINOIS	FED. AID PROJECT	CMM-0001 (873)	

CONTRACT #63440

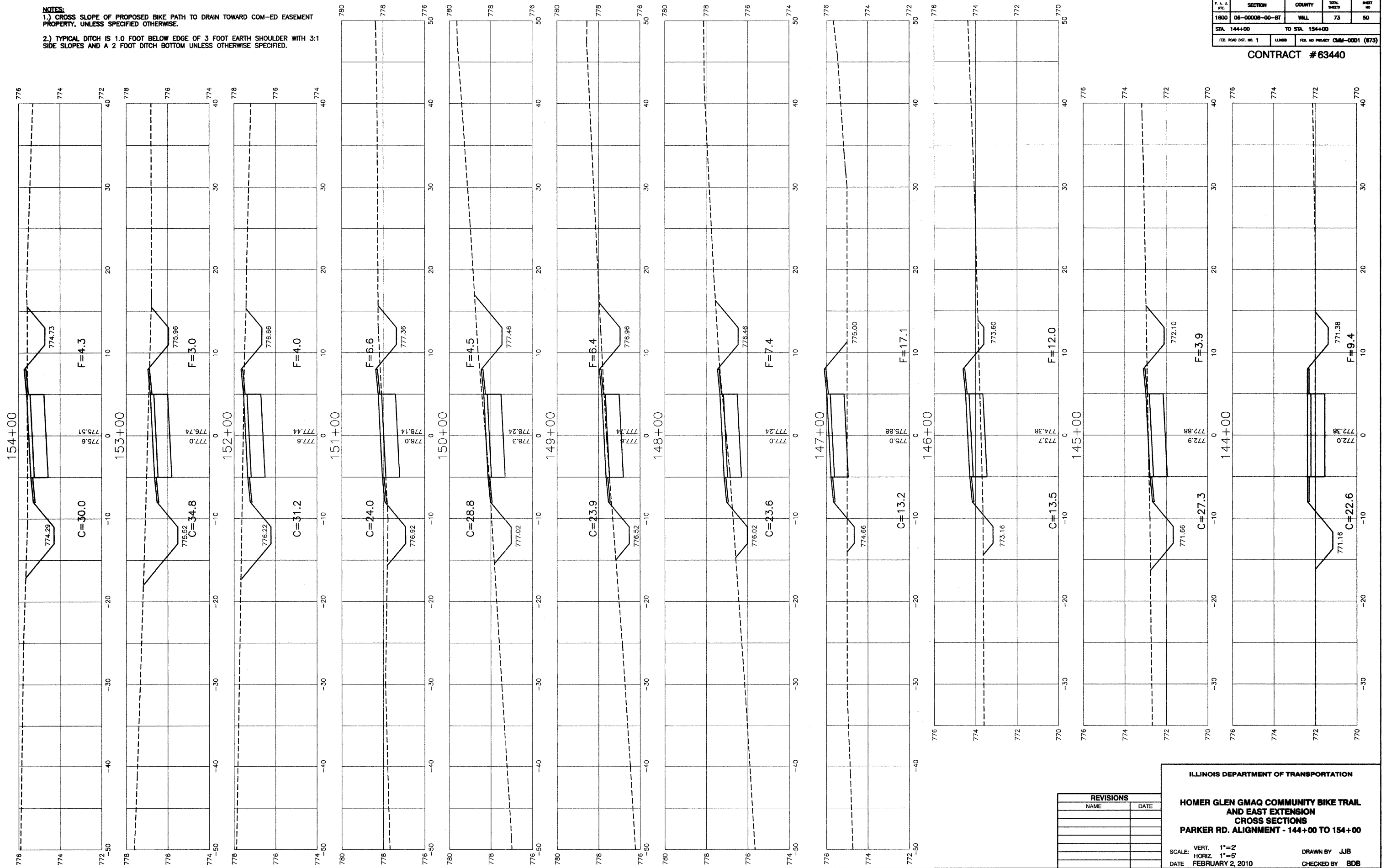

REVISIONS	
NAME	DATE

ILLINOIS DEPARTMENT OF TRANSPORTATION
**HOMER GLEN GMAQ COMMUNITY BIKE TRAIL
 AND EAST EXTENSION
 CROSS SECTIONS
 PARKER RD. ALIGNMENT - 144+00 TO 154+00**
 SCALE: VERT. 1"=2'
 HORIZ. 1"=5'
 DATE: FEBRUARY 2, 2010
 DRAWN BY: JJB
 CHECKED BY: BDB