

F. A. U. NO.	SECTION	COUNTY	TOTAL SHEETS	SHEET NO.
1600	06-00008-00-BT	WILL	73	58
STA. 222+44.54		TO STA. 232+00		
FED. ROAD DIST. NO. 1	ILLINOIS	FED. AID PROJECT	CMM-0001 (673)	

CONTRACT #63440

NOTES:
 1.) GROSS SLOPE OF PROPOSED BIKE PATH TO DRAIN TOWARD COM-ED EASEMENT PROPERTY, UNLESS SPECIFIED OTHERWISE.
 2.) TYPICAL DITCH IS 1.0 FOOT BELOW EDGE OF 3 FOOT EARTH SHOULDER WITH 3:1 SIDE SLOPES AND A 2 FOOT DITCH BOTTOM UNLESS OTHERWISE SPECIFIED.

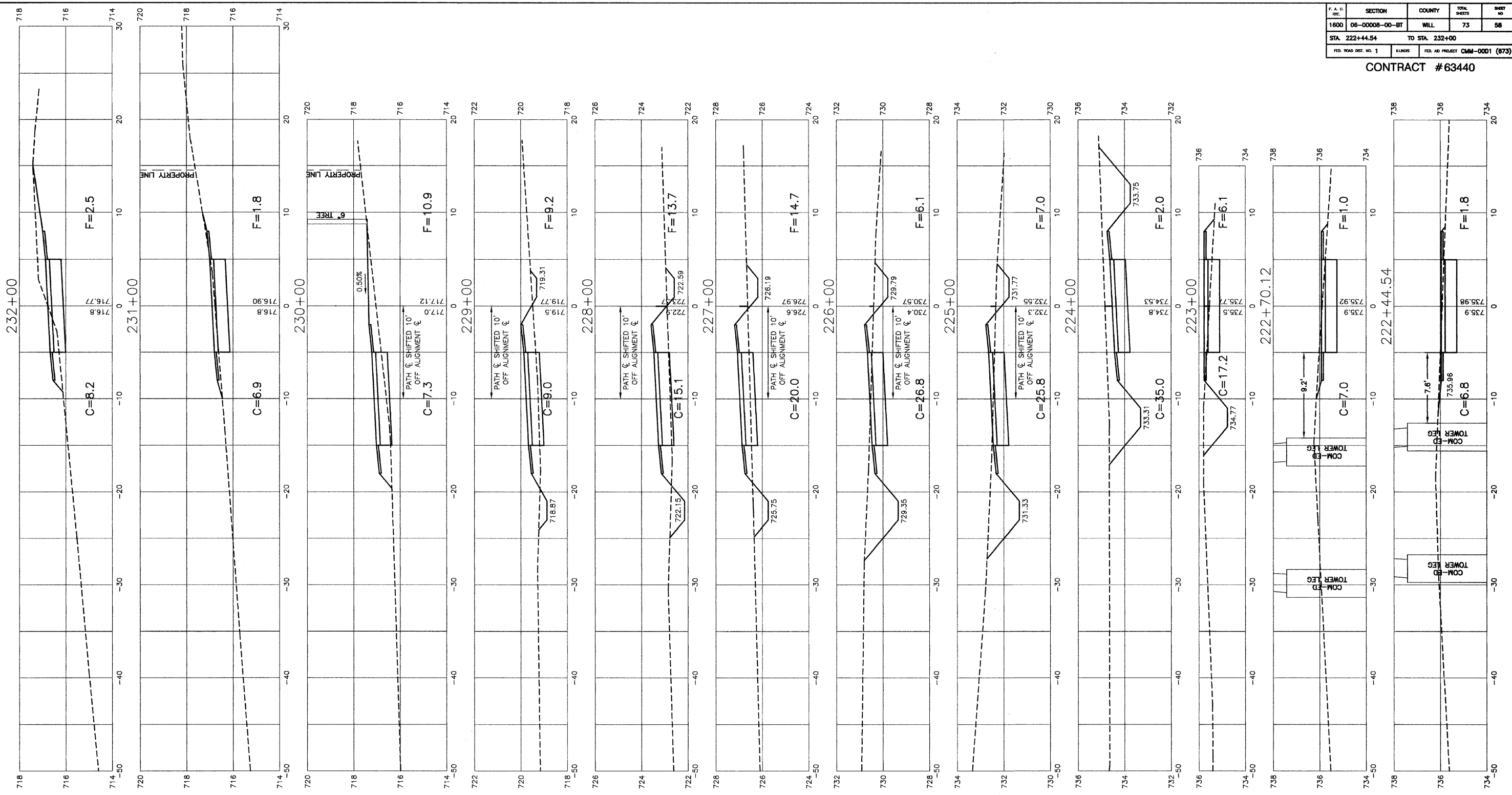

REVISIONS	
NAME	DATE

ILLINOIS DEPARTMENT OF TRANSPORTATION

HOMER GLEN GMAQ COMMUNITY BIKE TRAIL AND EAST EXTENSION CROSS SECTIONS

MUSTANG DR. ALIGNMENT - 222+44.54 TO 232+00

SCALE: VERT. 1"=2'
 HORIZ. 1"=5'

DATE: FEBRUARY 2, 2010

DRAWN BY: JJB
 CHECKED BY: BDB

ROBINSON ENGINEERING, LTD.
 1700 SOUTH PARK AVENUE, SOUTH HOLLAND, ILLINOIS 60486
 (708) 331-6700 FAX (708) 331-8828
 ILLINOIS DESIGN FIRM REGISTRATION NO. 194601128