

F. A. U. NO.	SECTION	COUNTY	TOTAL SHEETS	SHEET NO.
1800	08-00008-00-8T	WILL	73	66
STA. 275+70		TO STA. 278+26.80		
FED. ROAD DIST. NO. 1	ILLINOIS	FED. AID PROJECT	CAM-0001 (873)	

CONTRACT # 63440

NOTES:
 1.) CROSS SLOPE OF PROPOSED BIKE PATH TO DRAIN TOWARD COM-ED EASEMENT PROPERTY, UNLESS SPECIFIED OTHERWISE.
 2.) TYPICAL DITCH IS 1.0 FOOT BELOW EDGE OF 3 FOOT EARTH SHOULDER WITH 3:1 SIDE SLOPES AND A 2 FOOT DITCH BOTTOM UNLESS OTHERWISE SPECIFIED.

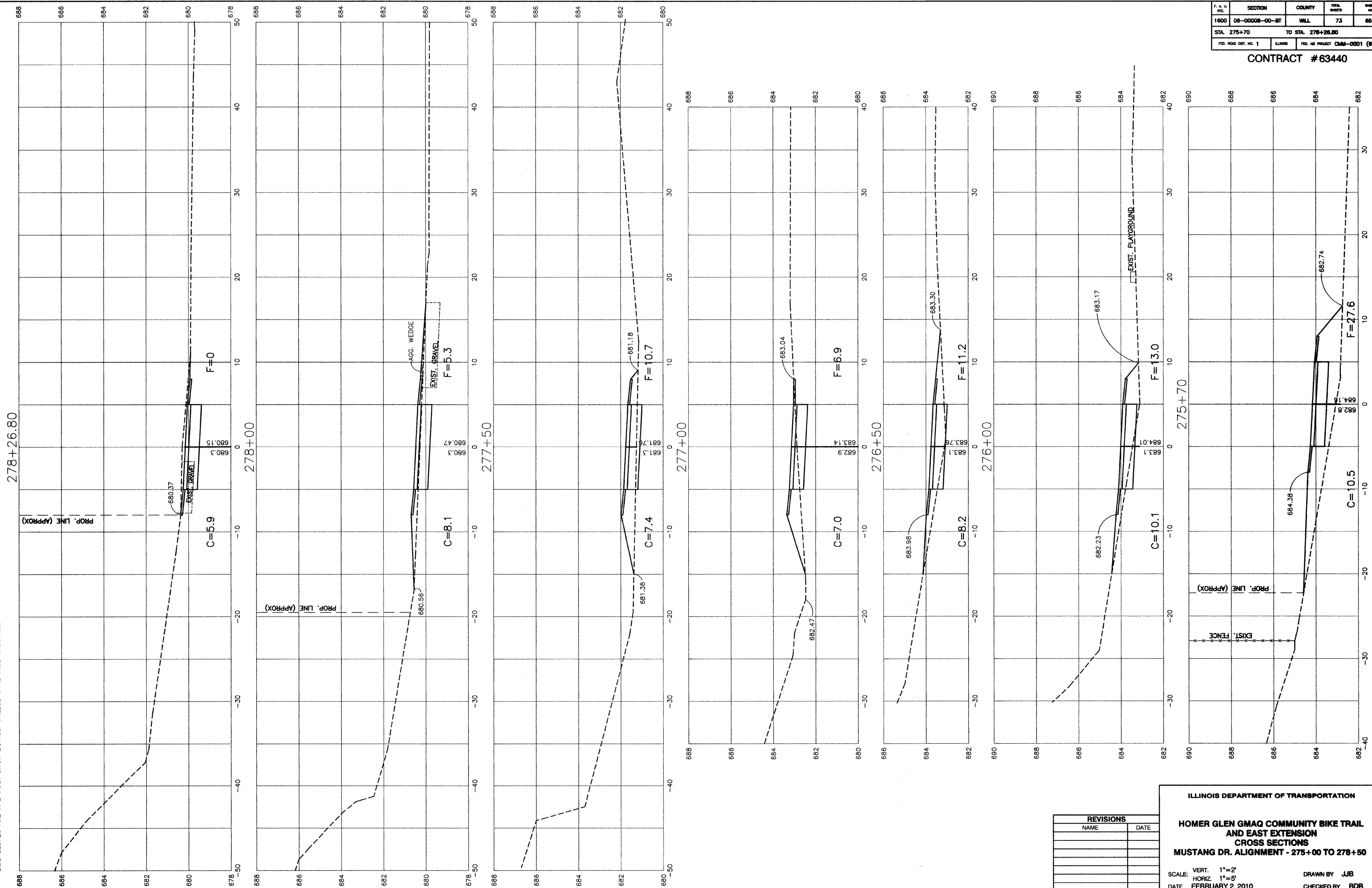

REVISIONS	
NAME	DATE

ILLINOIS DEPARTMENT OF TRANSPORTATION
HOMER GLEN GMAQ COMMUNITY BIKE TRAIL AND EAST EXTENSION
CROSS SECTIONS
MUSTANG DR. ALIGNMENT - 275+00 TO 278+50
 SCALE: VERT. 1"=2'
 HORIZ. 1"=5'
 DATE: FEBRUARY 2, 2010
 DRAWN BY: JJB
 CHECKED BY: BDB