

STATE OF ILLINOIS
DEPARTMENT OF TRANSPORTATION

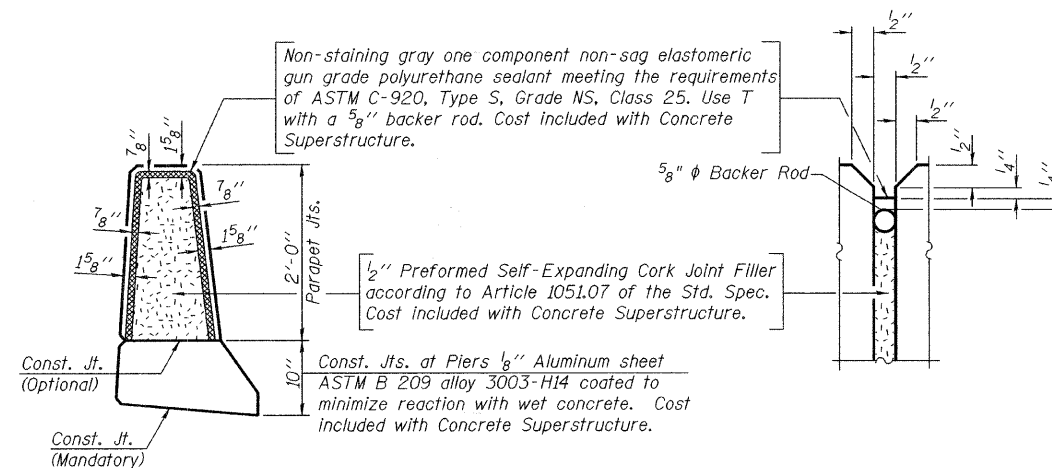
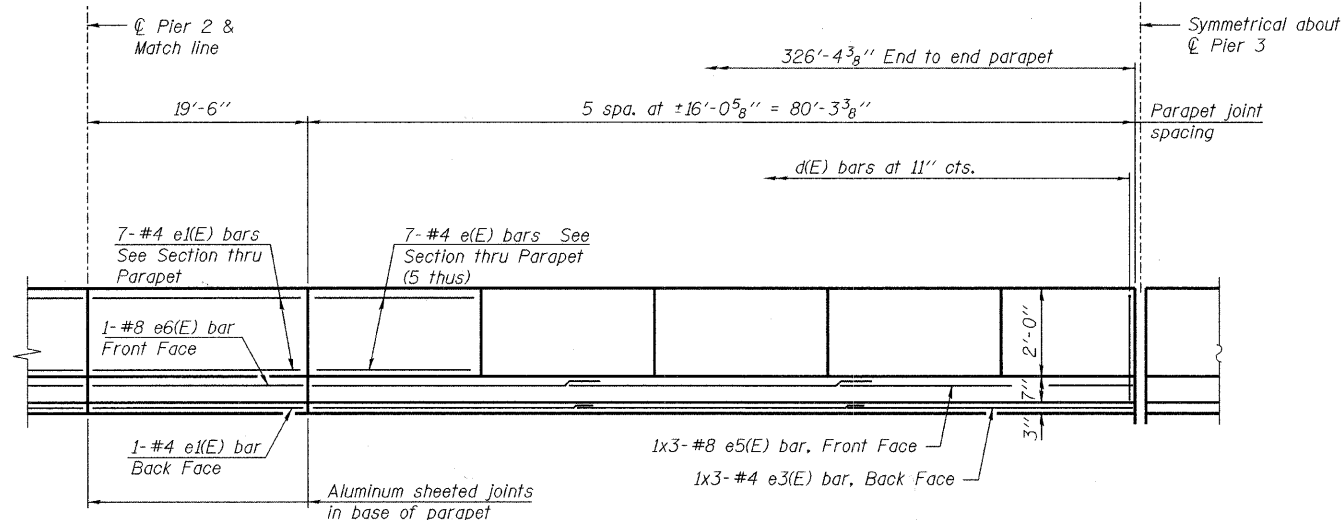
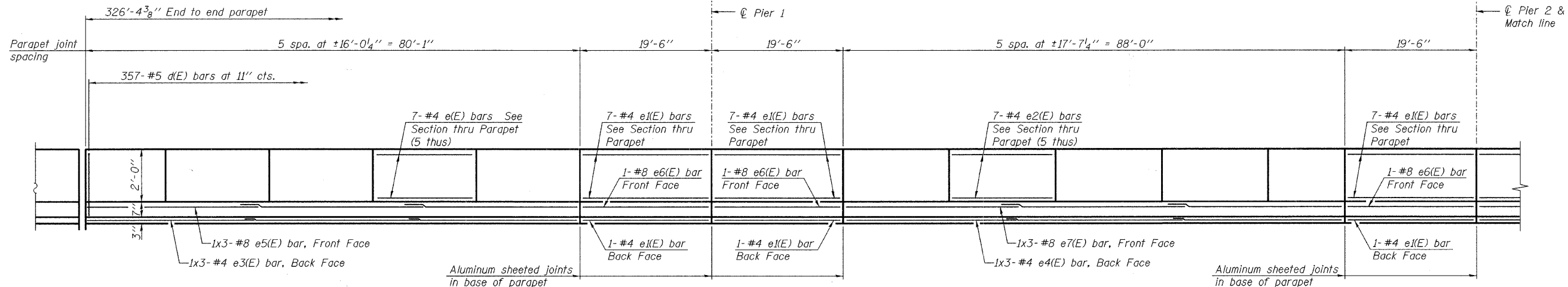

PARAPET JOINT DETAILS

MINIMUM BAR LAP

(Parapet)
#4 bar = 2'-0"
#8 bar = 5'-2"

NOTES:

1. Bars indicated thus 1x3-#8 etc. indicates 1 line of bars with 3 lengths per line.
2. For Section Thru Parapet, Bill of Material and Reinforcement schedule see sheet S17.
3. The joint opening at the Abutments and Pier 3 shall match the deck opening.

INSIDE ELEVATION OF EAST PARAPET
REFLECTED INSIDE ELEVATION OF WEST PARAPET

DESIGNED -	JLS
CHECKED -	MRB
DRAWN -	VH
CHECKED -	KWS

benesch

alfred benesch & company
Engineers • Surveyors • Planners
205 North Michigan Avenue, Suite 2400
Chicago, Illinois 60601
312-565-0450 Job No. 3808.02

SHEET NO. S16 S47 SHEETS	F.A.U. RTE.	SECTION	COUNTY	TOTAL SHEETS	SHEET NO.
	341	04-00090-07-BR	WILL	57	24
CONTRACT NO. 63442					
FED. ROAD DIST. NO.		ILLINOIS	FED. AID PROJECT		

1/22/2010 10:03:46 AM x:\3800s\3808.02\engineering\ng_documents\phase.11\brandon_road_bridge\line\0993298-63442-016-prp.tal1.dgn