

PLAN	SURVEYED	DATE
	PLOTTED	
	CHECKED	
	BY	
	NOTE BOOK	
	NO.	
	STRUCTURE	
	NOTATION	
	CHKD	

PROFILE	SURVEYED	DATE
	PLOTTED	
	CHECKED	
	BY	
	NOTE BOOK	
	NO.	
	STRUCTURE	
	NOTATION	
	CHKD	

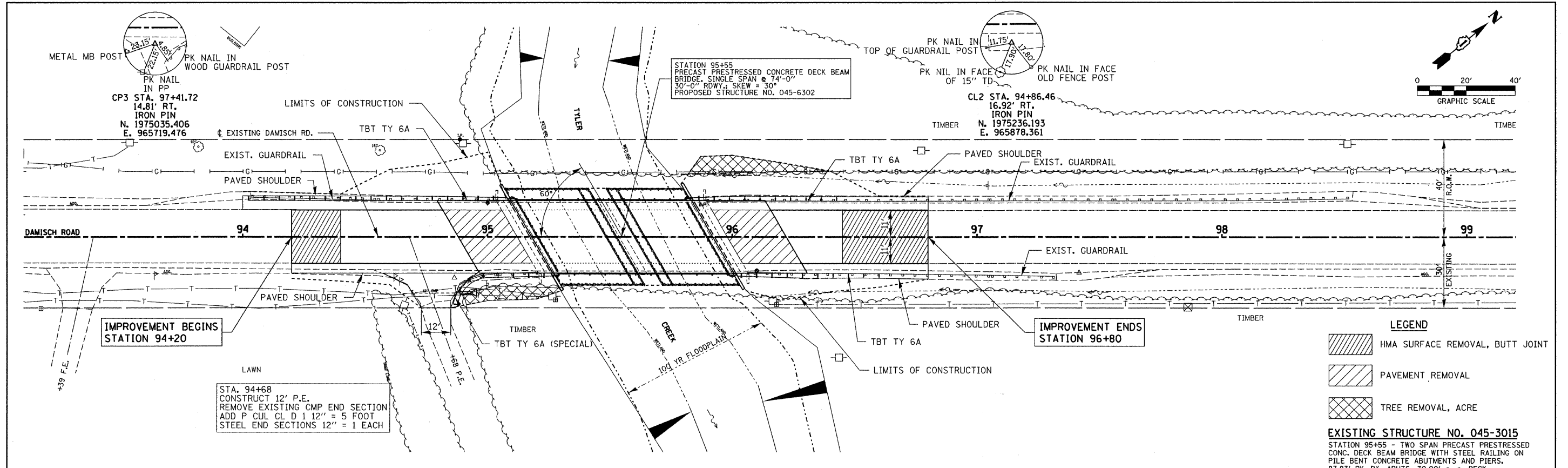

**EXISTING STRUCTURE NO. 045-3015**  
STATION 95+55 - TWO SPAN PRECAST PRESTRESSED  
CONC. DECK BEAM BRIDGE WITH STEEL RAILING ON  
PILE BENT CONCRETE ABUTMENTS AND PIERS.  
87.83' BK.-BK. ABUTS; 30.00' o.-o. DECK

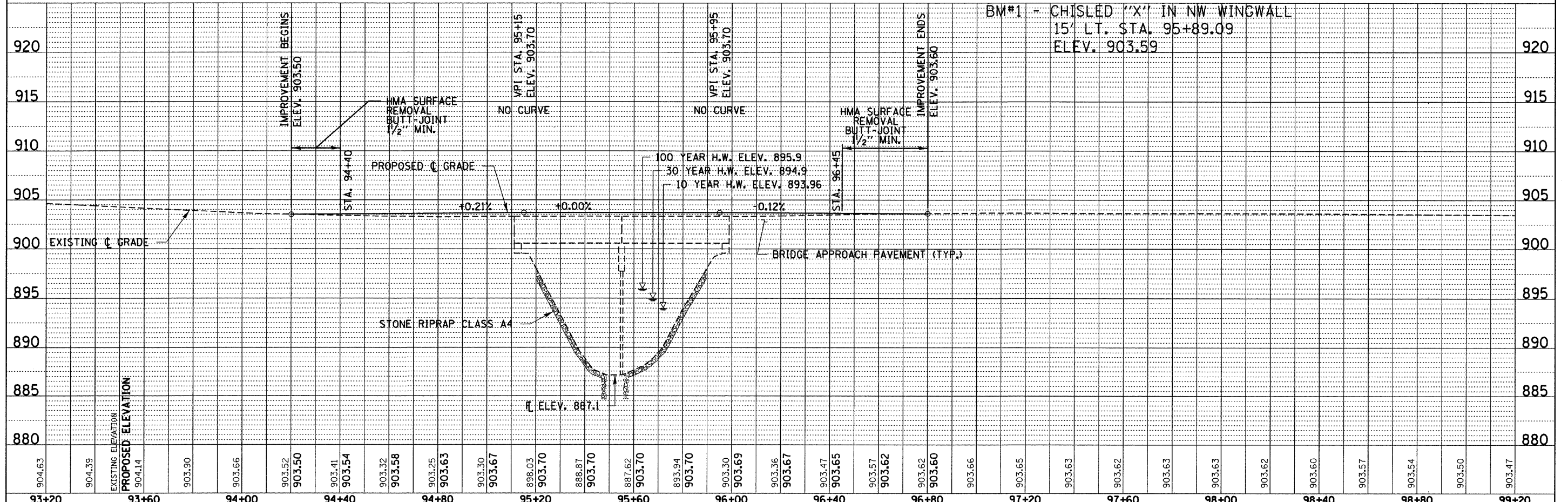

93+20	93+60	94+00	94+40	94+80	95+20	95+60	96+00	96+40	96+80	97+20	97+60	98+00	98+40	98+80	99+20																													
904.63	904.39	903.90	903.66	903.52	903.50	903.41	903.54	903.32	903.58	903.25	903.63	903.30	903.67	898.03	903.70	888.87	903.70	887.62	903.70	893.94	903.70	903.30	903.69	903.36	903.67	903.47	903.65	903.57	903.62	903.62	903.60	903.66	903.65	903.63	903.62	903.63	903.63	903.62	903.62	903.60	903.57	903.54	903.50	903.47
FILE NAME =	USER NAME =	DESIGNED - L.F.S.	REVISOR -	STATE OF ILLINOIS	SCALE: 20	SHEET NO. 1 OF 1 SHEETS	STA. 104+00 TO STA. 110+00	KANE COUNTY DIVISION OF TRANSPORTATION		PLAN & PROFILE		DAMISCH ROAD / C.H. 7		F.A.P. 132	SECTION 07-00358-00-BR	COUNTY KANE	TOTAL SHEETS 33	SHEET NO. 6	CONTRACT NO. 63444	FED. ROAD DIST. NO.	ILLINOIS FED. AID PROJECT																							