

Notes:  
See sheet 26 for Sections C-C and D-D.  
q<sub>1</sub>(E) and q<sub>2</sub>(E) bar spacings measured along  $\perp$  Rdwy.

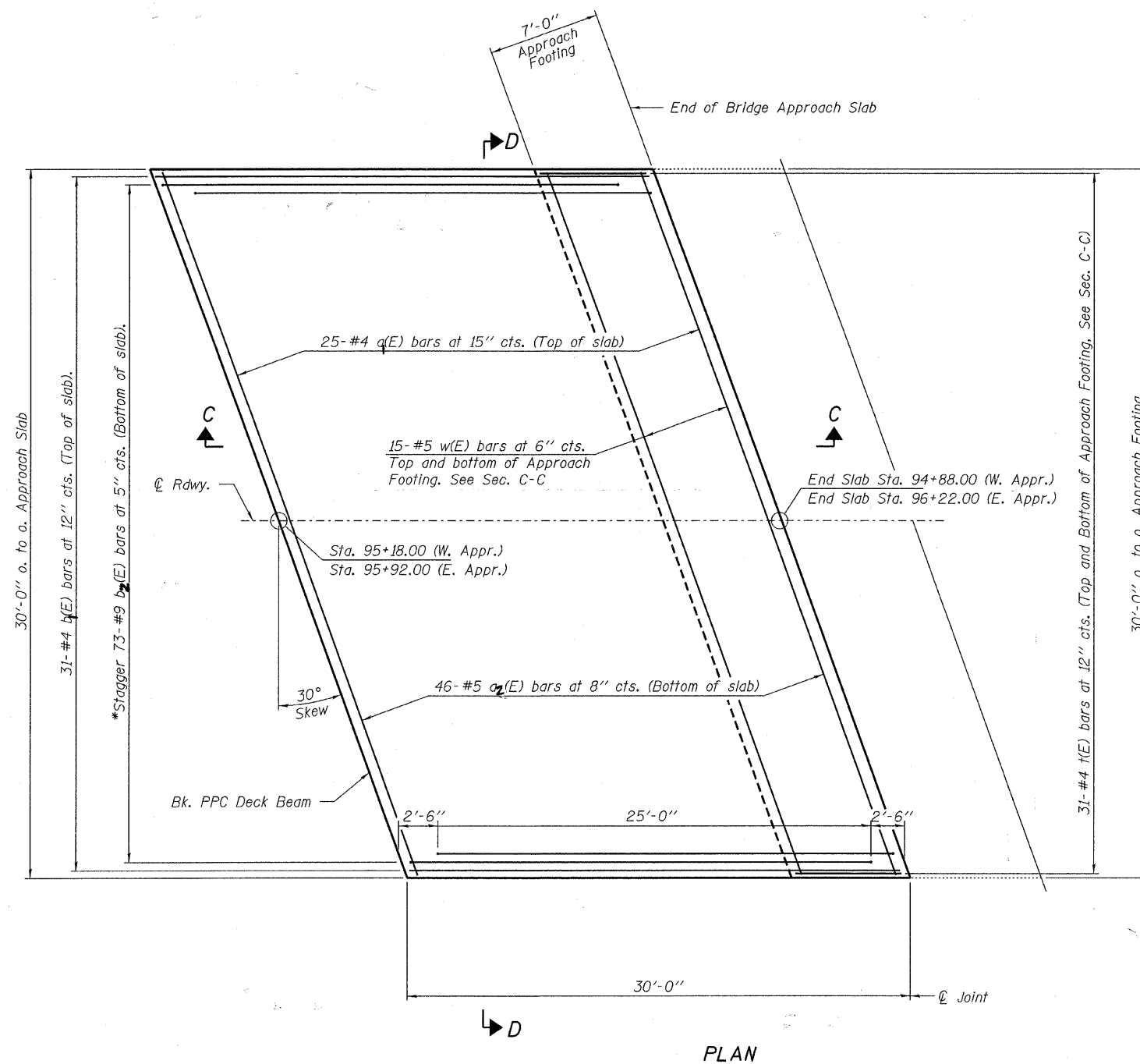

\*Tilt #9 b<sub>2</sub>(E) bars as required to maintain clearance.

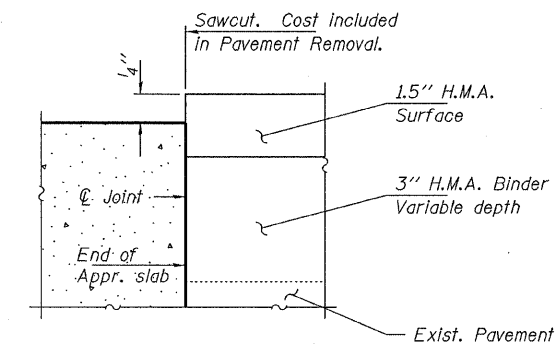

**FLEXIBLE PAVEMENT**  
**DETAIL A**

|                   |
|-------------------|
| DESIGNED - S.W.M. |
| CHECKED - A.S.L.  |
| DRAWN - D.A.B.    |
| CHECKED - S.W.M.  |

**HAMPTON, LENZINI & RENWICK, INC.**  
CIVIL & STRUCTURAL ENGINEERS  
LAND SURVEYORS

**HLR** 3085 STEVENSON DRIVE, SUITE 201  
SPRINGFIELD, ILLINOIS 62703  
(217) 546-3400

PROJECT NUMBER: 08.0043.130 DATE: 01/07/10

| FAS                           | SECTION        | COUNTY                    | TOTAL SHEETS       | SHEET NO. |
|-------------------------------|----------------|---------------------------|--------------------|-----------|
| 132                           | 07-00358-00-BR | KANE                      | 33                 | 26        |
| DAMISCH ROAD OVER TYLER CREEK |                |                           | CONTRACT NO. 63444 |           |
| FED. ROAD DIST. NO.           |                | ILLINOIS FED. AID PROJECT |                    |           |

(Sheet 1 of 2)  
**BRIDGE APPROACH SLAB DETAILS**  
**STRUCTURE NO. 045-6302**