

FAU RTE	SECTION	COUNTY	TOTAL SHEETS	SHEET NO.
2798	03-00193-00-FP	COOK	51	7
F.H.W.A. REG.	ILLINOIS	PROJECT	M-9003(488)	

CONTRACT NO. 63455

**STRUCTURE SCHEDULE**

- |   |   |
|---|---|
| 1 PROPOSED INLET<br>TYPE A, 2' DIA.,<br>TYPE 1 FR. & O.L.<br>RIM=603.30<br>INV(W)=600.10            | 11 PROPOSED CATCH BASIN<br>TYPE C, 2' DIA.,<br>TYPE 1 FR. & O.L.<br>RIM=603.85<br>INV(E)=598.89                   |
| 2 PROPOSED CATCH BASIN<br>TYPE A, 4' DIA.,<br>TYPE 1 FR. & O.L.<br>RIM=603.30<br>INV(E)=601.25      | 12 MANHOLE RECONSTRUCTION<br>NEW TYPE 1 FR. & C.L.<br>RIM=604.20<br>INV(SE)=598.86<br>INV(NW)=598.78              |
| 3 CATCH BASIN ADJUSTMENT<br>NEW TYPE 1 FR. & O.L.<br>RIM=603.60<br>INV(NW)=599.85                   | 13 PROPOSED CATCH BASIN<br>TYPE A, 4' DIA.,<br>TYPE 1 FR. & O.L.<br>RIM=603.75<br>INV(NW)=600.31<br>INV(N)=600.41 |
| 4 CATCH BASIN ADJUSTMENT<br>RIM=603.60<br>INV(SW)=599.92  | 14 CATCH BASIN TO BE FILLED   |
| 5 VALVE VAULT RECONSTRUCTION<br>NEW TYPE 1 FR. & C.L.<br>RIM=603.80                                 | 15 INLET ADJUSTMENT<br>RIM=603.85<br>INV(S)=601.59  |
| 6 MANHOLE RECONSTRUCTION<br>NEW TYPE 1 FR. & C.L.<br>RIM=604.40<br>INV(SE)=597.70<br>INV(NE)=598.78 | 16 CATCH BASIN TO BE FILLED   |
| 7 PROPOSED INLET<br>TYPE A, 2' DIA.,<br>TYPE 1 FR. & O.L.<br>RIM=603.45<br>INV(E)=600.73            | 17 VALVE VAULT RECONSTRUCTION<br>NEW TYPE 1 FR. & C.L.<br>RIM=604.45  |
| 8 CATCH BASIN ADJUSTMENT<br>NEW TYPE 1 FR. & O.L.<br>RIM=603.45<br>INV(E)=600.23<br>INV(SW)=600.13  | 18 PROPOSED INLET<br>TYPE A, 2' DIA.,<br>TYPE 1, FR. & O.L.<br>RIM=603.80<br>INV(W)=600.80                        |
| 9 PROPOSED CATCH BASIN<br>TYPE C, 2' DIA.,<br>TYPE 1 FR. & O.L.<br>RIM=603.90<br>INV(E)=601.40      | 19 PROPOSED CATCH BASIN<br>TYPE A, 4' DIA.,<br>TYPE 1 FR. & O.L.<br>RIM=603.80<br>INV(E)=600.80                   |
| 10 MANHOLE RECONSTRUCTION<br>NEW TYPE 1 FR. & C.L.<br>RIM=604.05<br>INV(NW)=601.40                  |   |

NOTE: ALL SCHEDULED RIM ELEVATIONS ARE PROPOSED.

**LEGEND**

- DENOTES HOT-MIX ASPHALT SURFACE REMOVAL, (SEE TYPICAL CROSS SECTIONS), TO BE REPLACED WITH "LEVELING BINDER (MACHINE METHOD), N70," 1 INCH AVG., "AREA REFLECTIVE CRACK CONTROL TREATMENT, SYSTEM A" AND "HOT-MIX ASPHALT SURFACE COURSE, MIX "D", N70", 2 INCH"
- DENOTES "DRIVEWAY REMOVAL" AND "SIDEWALK REMOVAL" (AS DIRECTED BY THE ENGINEER)
- DENOTES P.C. CONCRETE SIDEWALK, 5 INCH, WITH DETECTABLE WARNING
- DENOTES "P.C. CONCRETE DRIVEWAY PAVEMENT, 7 INCH" AND "P.C. CONCRETE SIDEWALK, 5 INCH" ON SUBBASE GRANULAR MATERIAL, TYPE B, 2 INCH"
- DENOTES HOT-MIX DRIVEWAY REMOVAL AND REPLACEMENT
- DENOTES CLASS D PATCHES, TYPE II - IV, 12", - AS DIRECTED
- "A" DENOTES EXISTING VALVE VAULTS, VALVE BOXES, INLETS, CATCH BASINS AND MANHOLES TO BE CLEANED, GROUTED, AND ADJUSTED TO GRADE WITH NEW ADJUSTING RINGS. (ALL TOP BANDS OF FALLEN, COMMON OR CONCRETE BRICK TO BE REPLACED WITH PRECAST CONCRETE ADJUSTING RINGS)
- "S" DENOTES EXISTING FRAMES AND LIDS TO BE ADJUSTED (SPECIAL) (SEE SHEET 41 FOR DETAIL)
- "R" DENOTES EXISTING STRUCTURES TO BE RECONSTRUCTED
- "F" DENOTES EXISTING STRUCTURES TO BE FILLED
- DENOTES ALLEY RETURN TO BE REMOVED WITH "PAVEMENT REMOVAL" AND REPLACED WITH "PORTLAND CEMENT CONCRETE PAVEMENT, 8 INCH".
- DENOTES "COMBINATION CURB AND GUTTER REMOVAL"
- DENOTES "COMBINATION CURB AND GUTTER, TYPE B-V.12"
- 20' STORM SEWER (WATER MAIN QUALITY) 8 INCH (LENGTH AS NOTED)

**BENCHMARK**

ARROW BOLT ON HYDRANT AT NORTHEAST CORNER OF 26TH STREET AND CENTRAL AVENUE ELEV. 606.80  
SSE BOLT ON HYDRANT AT NORTHEAST CORNER OF 25TH STREET AND CENTRAL AVENUE ELEV. 605.63

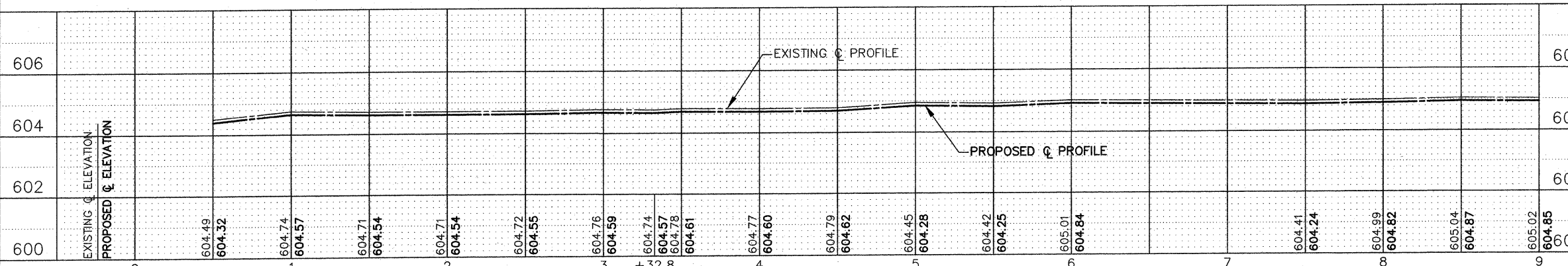
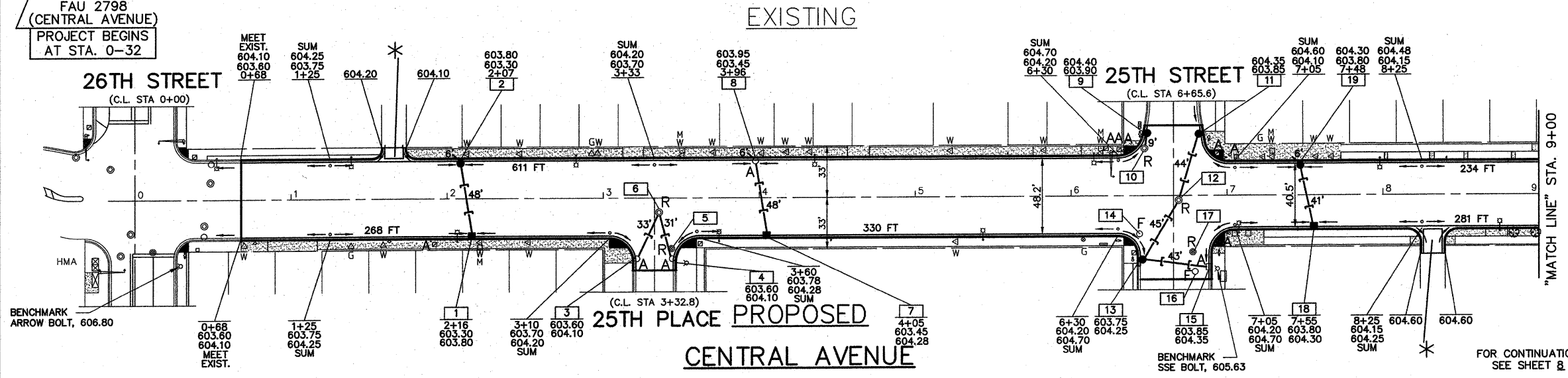
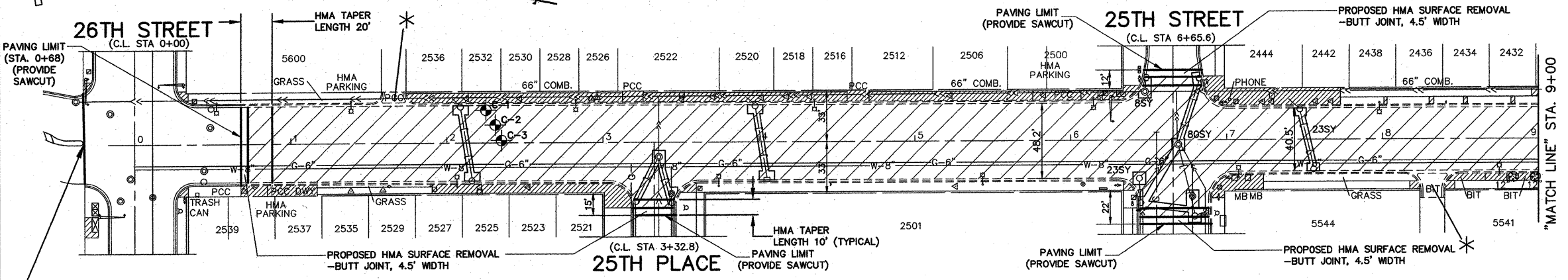

FOR TYPICAL CROSS SECTION OF NEW PAVEMENT WORK SEE SHEET 4

**IMPORTANT!**  
FULL SIZE PLANS HAVE BEEN PREPARED USING STANDARD ENGINEERING SCALES. REDUCED SIZED PLANS WILL NOT CONFORM TO STANDARD SCALES INDICATED IN TITLE BLOCK.

**Frank Novotny & Associates, Inc.**  
Civil Engineers 825 Midway Drive • Willowbrook, IL • 60527 • Telephone: (630) 887-8640 • Fax: (630) 887-0132  
Illinois Professional Design Firm No. 184-000928

PROJECT **TOWN OF CICERO, ILLINOIS**  
**CENTRAL AVENUE RESURFACING**  
**SECTION 03-00193-00-FP**

REVISIONS			
NO.	BY	DATE	DESCRIPTION
1	AMS	1/22/10	PER IDOT REVIEW
2	AMS	3/03/10	PER IDOT REVIEW

PLAN:  
**CENTRAL AVENUE-**  
**26th ST. TO STA. 9+00**  
**(RESURFACING)**

PROJECT NO. 05043	SCALE H.1"=40': V.1"=2'	SHEET 7 OF 51 SHEETS
DRAWN/DESIGNED JFP-JEP/THK	DATE DEC., 2009	
CHECKED/APPROVED JLC/THK	FIELD BOOK NO. FILE	