

- DENOTES HOT-MIX ASPHALT SURFACE REMOVAL (SEE TYPICAL CROSS SECTIONS), TO BE REPLACED WITH "LEVELING BINDER (MACHINE METHOD), N70," 1 INCH AVG. "AREA REFLECTIVE CRACK CONTROL TREATMENT, SYSTEM A" AND "HOT-MIX ASPHALT SURFACE COURSE, MIX "D", N70", 2 INCH"
- DENOTES "DRIVEWAY REMOVAL" AND "SIDEWALK REMOVAL" (AS DIRECTED BY THE ENGINEER)
- DENOTES P.C. CONCRETE SIDEWALK, 5 INCH, WITH DETECTABLE WARNING
- DENOTES "P.C. CONCRETE DRIVEWAY PAVEMENT, 7 INCH" AND "P.C. CONCRETE SIDEWALK, 5 INCH" ON SUBBASE GRANULAR MATERIAL, TYPE B, 2 INCH"
- DENOTES HOT-MIX DRIVEWAY REMOVAL AND REPLACEMENT
- DENOTES CLASS D PATCHES, TYPE II - IV, 12", - AS DIRECTED

- ### LEGEND
- "A" DENOTES EXISTING VALVE VAULTS, VALVE BOXES, INLETS, CATCH BASINS AND MANHOLES TO BE CLEANED, GROUTED, AND ADJUSTED TO GRADE WITH NEW ADJUSTING RINGS. (ALL TOP BANDS OF FALLEN, COMMON OR CONCRETE BRICK TO BE REPLACED WITH PRECAST CONCRETE ADJUSTING RINGS)
 - "S" DENOTES EXISTING FRAMES AND LIDS TO BE ADJUSTED (SPECIAL) (SEE SHEET 41 FOR DETAIL)
 - "R" DENOTES EXISTING STRUCTURES TO BE RECONSTRUCTED
 - "F" DENOTES EXISTING STRUCTURES TO BE FILLED
 - * DENOTES ALLEY RETURN TO BE REMOVED WITH "PAVEMENT REMOVAL" AND REPLACED WITH "PORTLAND CEMENT CONCRETE PAVEMENT, 8 INCH"
 - ≡≡ DENOTES "COMBINATION CURB AND GUTTER REMOVAL"
 - ≡≡ DENOTES "COMBINATION CURB AND GUTTER, TYPE B-V.12"
 - 20' STORM SEWER (WATER MAIN QUALITY) 8 INCH (LENGTH AS NOTED)

- ### BENCHMARK
- S BOLT ON HYDRANT AT 1241 S. CENTRAL AVENUE ELEV. 608.86
 - ARROW BOLT ON HYDRANT AT 1221 S. CENTRAL AVENUE ELEV. 608.61
 - NW BOLT ON HYDRANT AT 5559 W. ROOSEVELT ROAD (HYDRANT ON CENTRAL AVENUE) ELEV. 609.72



FAU RTE	SECTION	COUNTY	TOTAL SHEETS	SHEET NO.
2798	03-00193-00-FP	COOK	51	15
F.H.W.A. REG.		ILLINOIS PROJECT	M-9003(488)	

CONTRACT NO. 63485
4

STRUCTURE SCHEDULE

- [204] CATCH BASIN ADJUSTMENT
RIM= 606.10
INV(E)= 600.65
INV(N)= 600.75
- [205] CATCH BASIN ADJUSTMENT
TYPE 1 FR. & O.L.
RIM= 606.10
INV(S)= 601.05
- [206] MANHOLE RECONSTRUCTION
RIM= 607.60
INV(W)= 599.31
- [207] PROPOSED CATCH BASIN
TYPE C, 2' DIA.,
TYPE 1 FR. & O.L.
RIM= 606.40
INV(E)= 603.51
- [208] PROPOSED INLET
TYPE A, 2' DIA.,
TYPE 1 FR. & O.L.
RIM= 606.40
INV(W)= 600.98
- [209] CATCH BASIN ADJUSTMENT
RIM= 606.40
- [210] MANHOLE ADJUSTMENT (SPECIAL)
RIM= 607.20
INV(SE)= 600.82
- [210A] MANHOLE ADJUSTMENT (SPECIAL)
RIM= 606.80
- [211] PROPOSED CATCH BASIN
TYPE C, 2' DIA.,
TYPE 1 FR. & O.L.
RIM= 606.40
INV(W)= 601.24
- [212] VALVE VAULT ADJUSTMENT
RIM= 607.72
- [213] CATCH BASIN RECONSTRUCTION
RIM= 606.55
INV(E)= 603.33
- [214] PROPOSED CATCH BASIN
TYPE C, 2' DIA.,
TYPE 1 FR. & O.L.
RIM= 606.55
INV(W)= 601.76
- [215] MANHOLE ADJUSTMENT (SPECIAL)
RIM= 607.60
- [216] VALVE VAULT ADJUSTMENT (SPECIAL)
RIM= 607.50

NOTE: ALL SCHEDULED RIM ELEVATIONS ARE PROPOSED.

FOR TYPICAL CROSS SECTION OF NEW PAVEMENT WORK SEE SHEET 4

IMPORTANT!
FULL SIZE PLANS HAVE BEEN PREPARED USING STANDARD ENGINEERING SCALES. REDUCED SIZED PLANS WILL NOT CONFORM TO STANDARD SCALES INDICATED IN TITLE BLOCK.

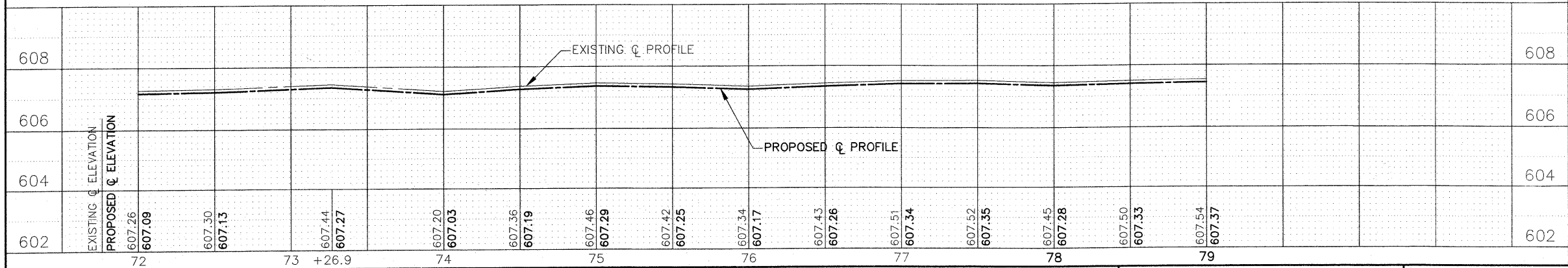
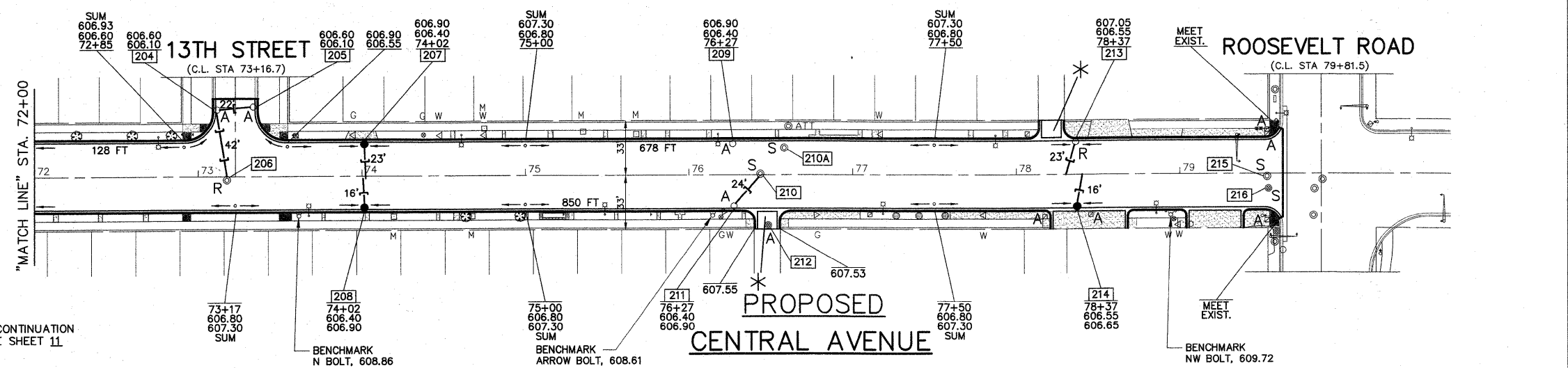
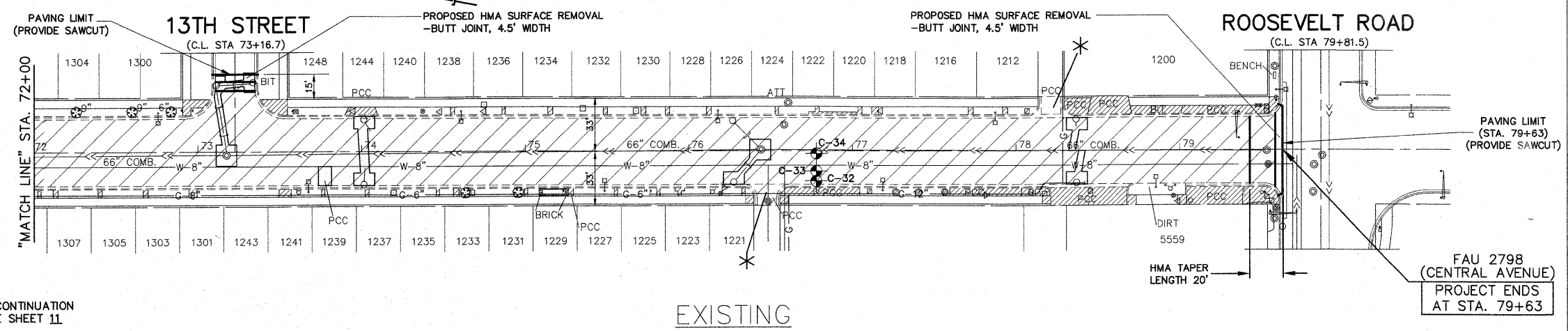

Frank Novotny & Associates, Inc.
Civil Engineers
825 Midway Drive • Willowbrook, IL • 60527 • Telephone: (630) 887-8640 • Fax: (630) 887-0132
Illinois Professional Design Firm No. 184-000928

PROJECT
TOWN OF CICERO, ILLINOIS
CENTRAL AVENUE RESURFACING
SECTION 03-00193-00-FP

REVISIONS			
NO.	BY	DATE	DESCRIPTION
1	AMS	1/22/10	PER IDOT REVIEW

PLAN:
CENTRAL AVENUE-
STA. 72+00 TO ROOSEVELT RD.
(RESURFACING)

PROJECT NO. 05043	SCALE 1"=40'	SHEET 15 OF 51 SHEETS
DRAWN/DESIGNED JFP-JEP/THK	DATE DEC., 2009	
CHECKED/APPROVED JLC/THK	FIELD BOOK NO. FILE	