

STATE OF ILLINOIS  
DEPARTMENT OF TRANSPORTATION

**GENERAL NOTES**

Reinforcement bars shall conform to the requirements of ASTM A 706 Gr 60. See Special Provisions.  
 Reinforcement bars designated (E) shall be epoxy coated.  
 Plan dimensions and details relative to existing plans are subject to nominal construction variations. The Contractor shall field verify existing dimensions and details affecting new construction and make necessary approved adjustments prior to construction or ordering of materials. Such variations shall not be cause for additional compensation for a change in scope of the work, however, the Contractor will be paid for the quantity actually furnished at the unit price bid for the work.  
 Existing reinforcement bars extending into the removal area shall be cleaned, straightened and incorporated into the new construction. Any reinforcement bars that are damaged during concrete removal shall be replaced with an approved bar splicer or anchorage system. Cost included with Concrete Removal.  
 Joint openings shall be adjusted according to Article 520.04 of the Standard Specifications when the deck is poured at an ambient temperature other than 50° F.  
 Prior to pouring the new concrete deck, all heavy or loose rust, loose mill scale, and other loose or potentially detrimental foreign material shall be removed from the surfaces in contact with concrete. Tightly adhered paint may remain unless otherwise noted. Removal shall be accomplished by methods that will not damage the steel and the cost will be included in the pay item covering removal of the existing concrete.  
 The existing structural steel coating contains lead. The Contractor shall take appropriate precautions to deal with the presence of lead on this project.  
 The deck surface shall have its final finish tined according to Article 420.09(e)(1) of the Standard Specifications. Cost included with Concrete Superstructures.  
 The Contractor must exercise extreme care as not to damage the Fiber Optic Conduit attached to the structure. Any damage is to be repaired at the Contractor's expense to the satisfaction of the Utility Company.

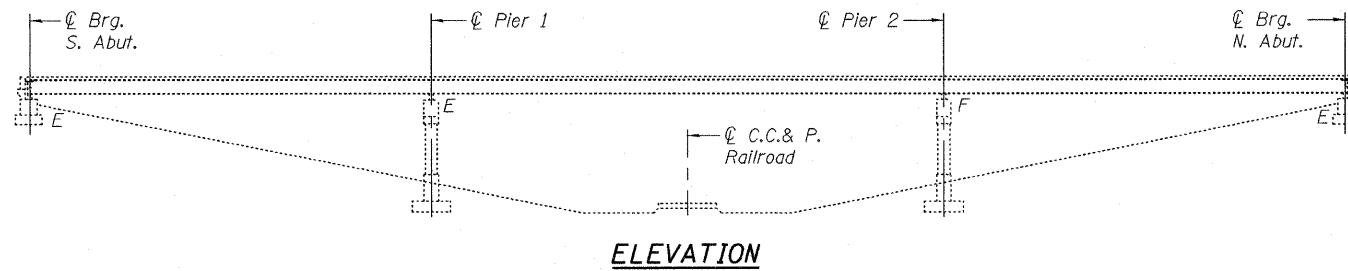

**ELEVATION**

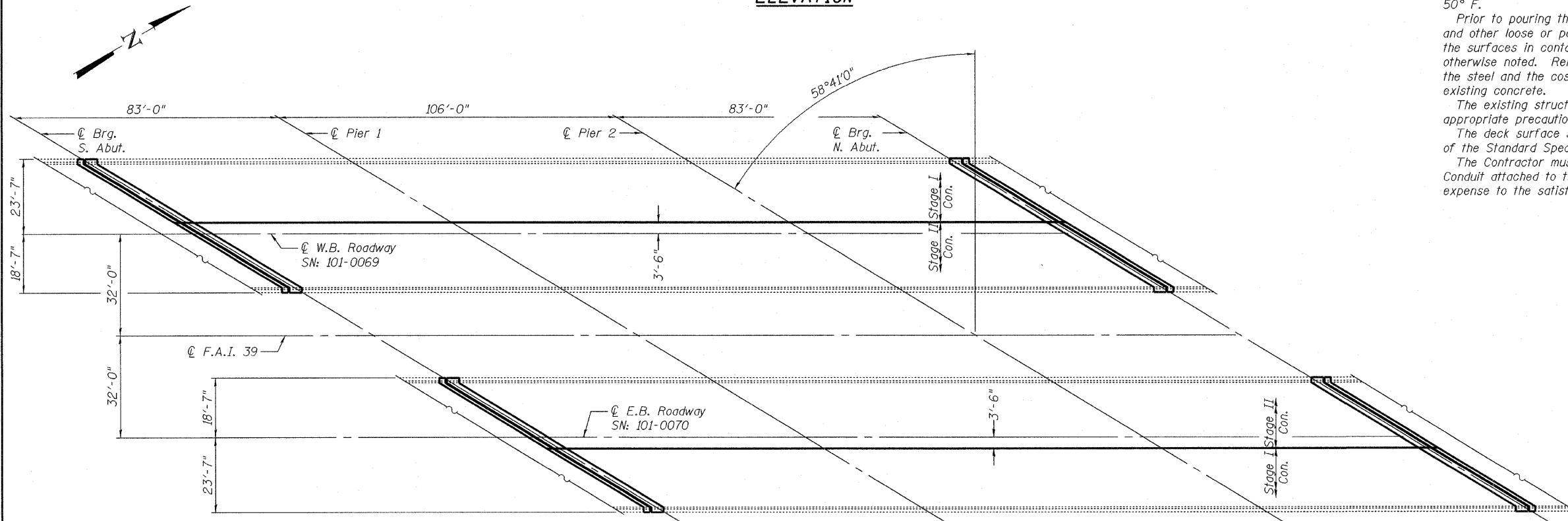

**PLAN**

**TOTAL BILL OF MATERIAL**

ITEM	UNIT	QUANTITY
Concrete Removal	Cu. Yd.	52.9
Concrete Superstructure	Cu. Yd.	53
Reinforcement Bars, Epoxy Coated	Pound	5620
Preformed Joint Strip Seal	Foot	308
Bar Splicers	Each	56
* Protective Coat	Sq. Yd.	110

\*Apply to new concrete only.

DESIGNED *Jim J. Pits*  
 CHECKED *Adrian T. Holloway*  
 DRAWN *[Signature]*  
 CHECKED *ISL ATH*

March 9, 2010  
 EXAMINED *[Signature]*  
 PASSED *[Signature]*  
 ENGINEER OF STRUCTURAL SERVICES  
 ENGINEER OF BRIDGES AND STRUCTURES



Expires: November 30, 2010

**PLAN AND ELEVATION  
SN 101-0069 & 0070**

SHEET NO. 1 6 SHEETS	F.A.I. RTE. 39	SECTION (4VBY, 4VBY-1, 5HB)M	COUNTY Winnebago	TOTAL SHEETS 36	SHEET NO. 24
	FED. ROAD DIST. NO. ILLINOIS FED. AID PROJECT			CONTRACT NO. 64G12	