

F.A.I. RTE.	SECTION	COUNTY	TOTAL SHEETS	SHEET NO.
80	150-318BK	LASALLE	492	58

STA. • TO STA. •
 FED. ROAD DIST. NO. ILLINOIS FED. AID PROJECT

- RAMP I
 STA. 201+50.00 TO 209+00.00
- RAMP K
 STA. 408+50.00 TO 416+00.00



EXISTING RAMP I

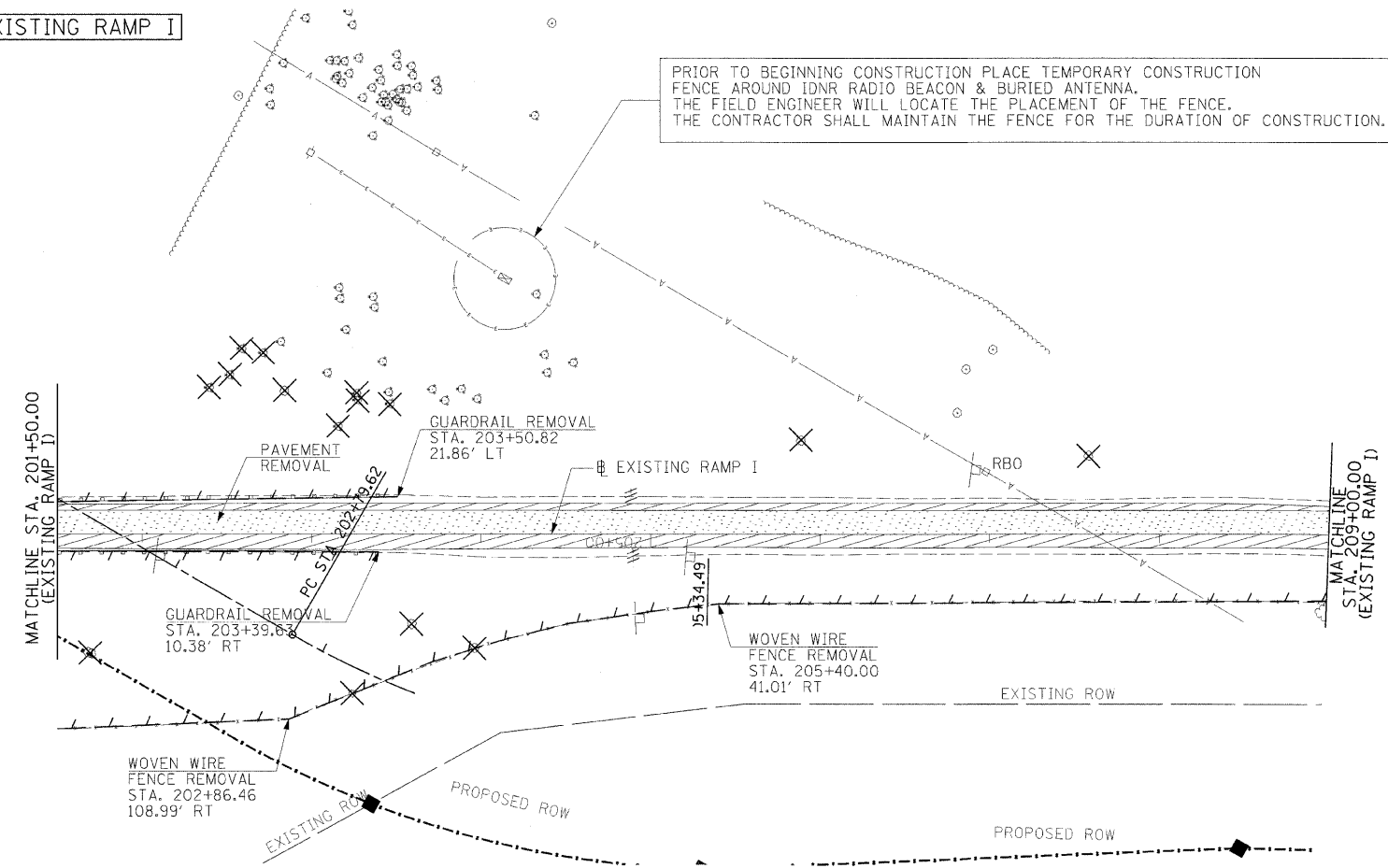

- NOTES:**
1. EXISTING SIGN REMOVALS ARE SHOWN ON THE SIGN REMOVAL PLAN.
 2. EXISTING PIPE UNDERDRAINS AND EXISTING HEADWALLS FOR PIPE UNDERDRAINS ARE TO BE REMOVED AND INCLUDED WITH PAYMENT FOR EARTH EXCAVATION.

EXISTING RAMP K

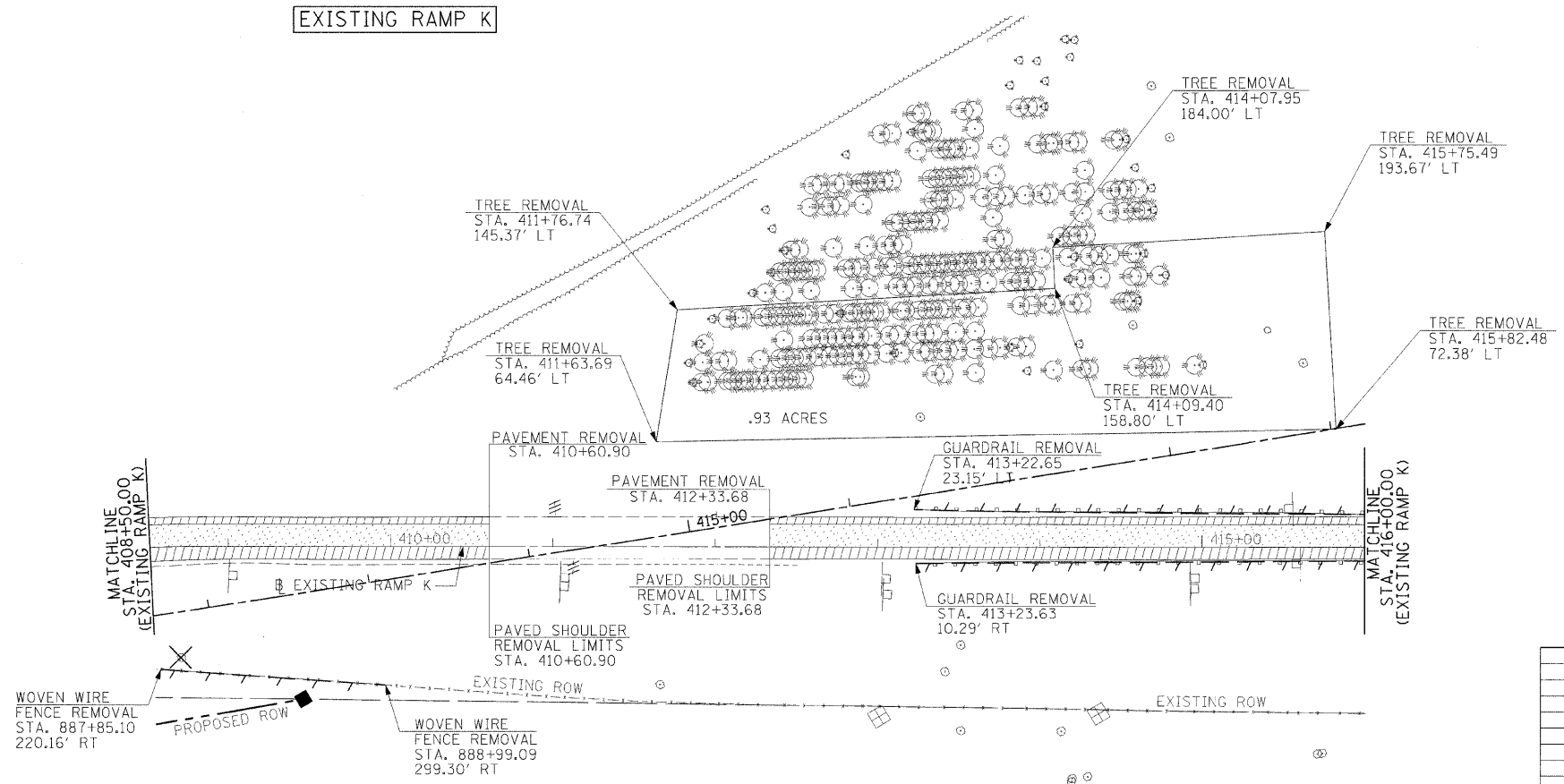

REMOVAL LEGEND

- CULVERT REMOVAL
- PAVEMENT REMOVAL
- PAVED SHOULDER REMOVAL
- DRIVEWAY PAVEMENT REMOVAL
- MEDIAN REMOVAL
- ITEM TO BE REMOVED
- ITEM TO BE RELOCATED
- ITEM TO BE RELOCATED BY OTHERS (SEE SCHEDULE)
- EXISTING DRAINAGE STRUCTURE (SEE SCHEDULE)
- CHAIN LINK FENCE REMOVAL
- COMBINATION CURB AND GUTTER REMOVAL
- GUARDRAIL REMOVAL

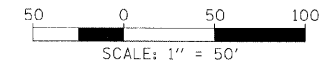

REVISIONS	
NAME	DATE

ILLINOIS DEPARTMENT OF TRANSPORTATION

REMOVAL PLAN
EXISTING RAMP I & K
 STA. 201+50.00 TO STA. 209+00.00
 STA. 408+50.00 TO STA. 416+00.00

SCALE: VERT. N/A
 HORIZ. 1"=50'

DRAWN BY MEW
 CHECKED BY

HANSON
 Hanson Professional Services Inc.
 1525 South Sixth Street
 Springfield, Illinois 62703-2886
 Offices Nationwide

MODEL NAME = Ramp I and K
 FILE NAME = C:\P\66542\150-318BK\150-318BK.dwg
 PLOT SCALE = 1/8"=1'-0"
 USER NAME = JohnM08144

LAYOUT	12/20/05
DRAWN	12/20/05
REVIEWED	10/1/07