

F.A.I. RTE.	SECTION	COUNTY	TOTAL SHEETS	SHEET NO.
80	150-3HBK	LASALLE	492	59
STA. TO STA.		ILLINOIS FED. AID PROJECT		

RAMP J  
STA. 309+00.00 TO 315+50.00  
RAMP L  
STA. 501+50.00 TO 509+00.00

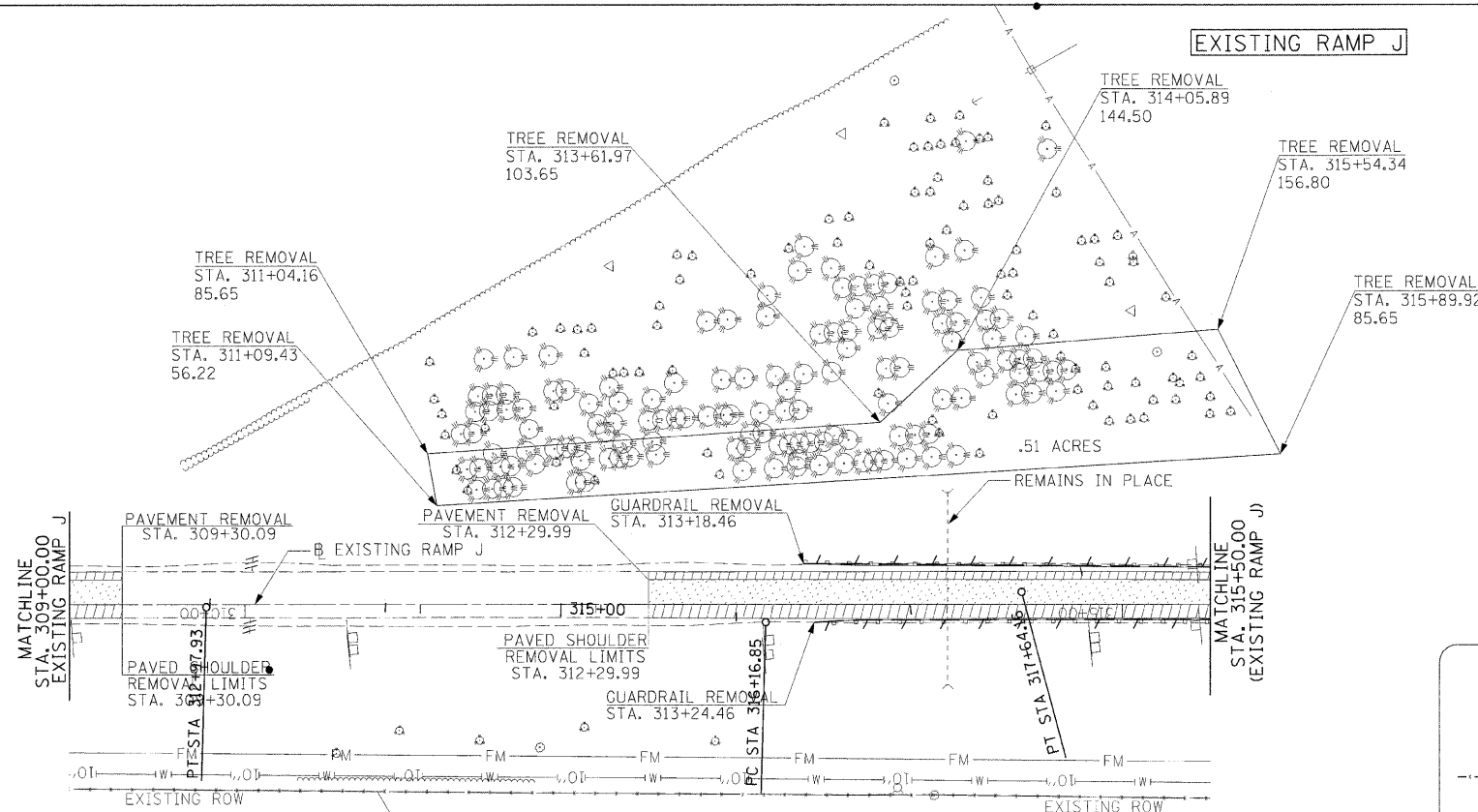

REMOVAL LEGEND		
RBO	ITEM TO BE RELOCATED BY OTHERS	--- --- --- CULVERT REMOVAL
(OO)	EXISTING DRAINAGE STRUCTURE (SEE SCHEDULE)	[Hatched Box] PAVEMENT REMOVAL
--- --- ---	CHAIN LINK FENCE REMOVAL	[Diagonal Hatched Box] PAVED SHOULDER REMOVAL
--- --- ---	COMBINATION CURB AND GUTTER REMOVAL	[Cross-hatched Box] DRIVEWAY PAVEMENT REMOVAL
--- --- ---	GUARDRAIL REMOVAL	[Cross-hatched Box] MEDIAN REMOVAL
X	ITEM TO BE REMOVED	
R	ITEM TO BE RELOCATED	

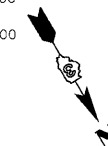
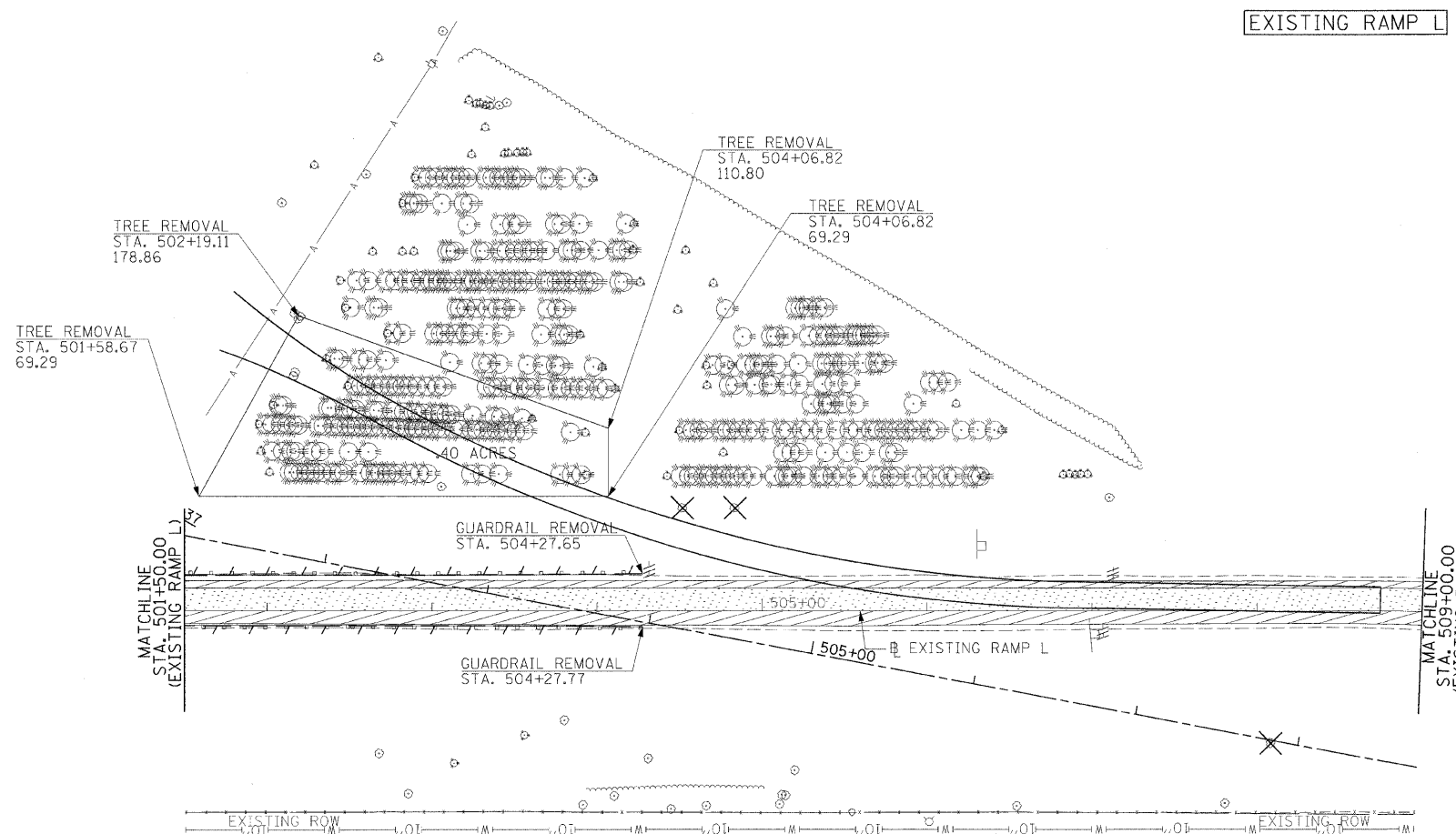

- NOTES:
- EXISTING SIGN REMOVALS ARE SHOWN ON THE SIGN REMOVAL PLAN.
  - EXISTING PIPE UNDERDRAINS AND EXISTING HEADWALLS FOR PIPE UNDERDRAINS ARE TO BE REMOVED AND INCLUDED WITH PAYMENT FOR EARTH EXCAVATION.

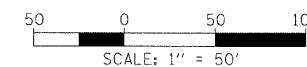

REVISIONS	
NAME	DATE

ILLINOIS DEPARTMENT OF TRANSPORTATION

**REMOVAL PLAN**  
EXISTING RAMPS J & L  
STA. 309+00.00 TO STA. 315+50.00  
STA. 501+50.00 TO STA. 509+00.00

SCALE: VERT. N/A  
HORIZ. 1"=50'

DRAWN BY MEW  
CHECKED BY

© Copyright Hanson Professional Services Inc. 2009  
**HANSON**  
 Hanson Professional Services Inc.  
 1525 South Sixth Street  
 Springfield, Illinois 62703-2886  
 Offices Nationwide

LAYOUT	MEW	12/20/05
DRAWN	MEW	12/20/05
REVIEWED	MTM	10/1/07

MODEL NAME = Ramp J and L  
 FILE NAME = CAPA 2005 - AC-1182EM.dgn  
 PLOT SCALE = 50,0000 / in.  
 USER NAME = John609144