

F.A.I. RTE.	SECTION	COUNTY	TOTAL SHEETS	SHEET NO.
80	150-3H8K	LASALLE	492	67
STA. 299+70.37 TO STA. 313+00.00				
FED. ROAD DIST. NO.		ILLINOIS FED. AID PROJECT		

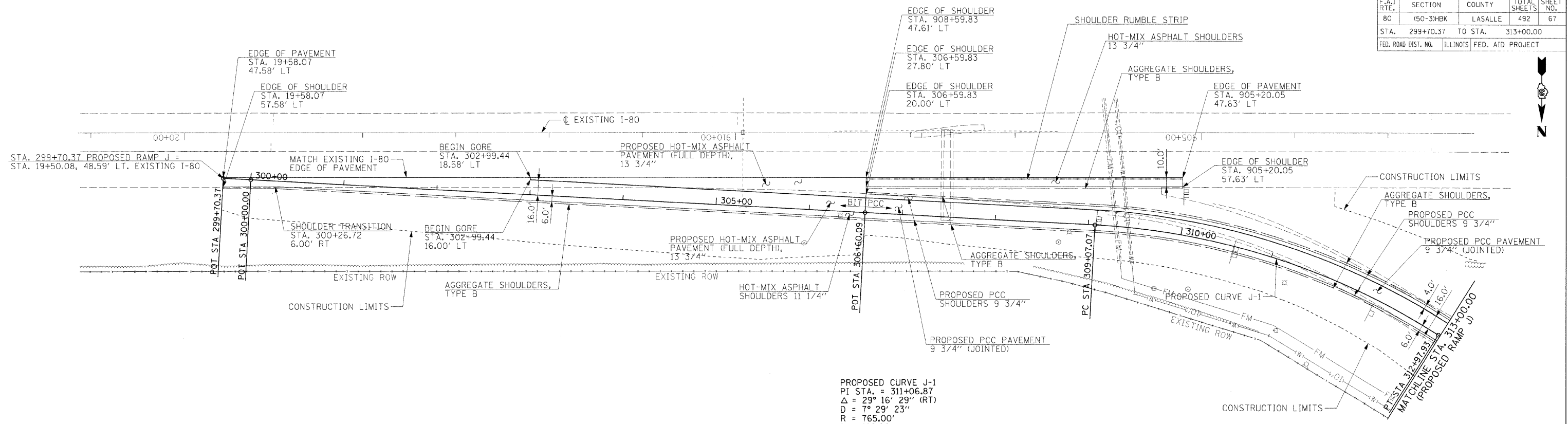

PROPOSED CURVE J-1  
 PI STA. = 311+06.87  
 $\Delta = 29^\circ 16' 29''$  (RT)  
 $D = 7^\circ 29' 23''$   
 $R = 765.00'$   
 $T = 199.80'$   
 $L = 390.87'$   
 $E = 25.66'$   
 $S = 8.0\%$   
 $S.C. TRANSITION = 255'$   
 P.C. STA. = 309+07.07  
 P.T. STA. = 312+97.93

NOTE: SEE DRAINAGE & UTILITIES SHEETS FOR ADDITIONAL DRAINAGE INFORMATION

MICHAEL WELSH (LIVING TRUST)

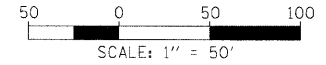

PLAN	DATE
REVISIONS	
NO.	
DATE	
BY	
DATE	
BY	
DATE	

HANSON  
 Professional Services Inc.  
 2727 North Lincoln Road  
 Springfield, Illinois 62703-2886  
 Offices Nationwide

PROFILE	DATE
REVISIONS	
NO.	
DATE	
BY	
DATE	
BY	
DATE	

MODEL NAME = Ramp J\_Sht 1  
 PLOT DATE = 12/23/2009  
 FILE NAME = C:\PW\LEP\VC-784\_RU.dgn  
 PLOT SCALE = 600000 / 1 in.  
 USER NAME = John00944

