

F.A.I. RTE.	SECTION	COUNTY	TOTAL SHEETS	SHEET NO.
80	(50-3)HBK	LASALLE	492	82
STA. 10+00.00		TO STA. 23+33.03		
FED. ROAD DIST. NO.		ILLINOIS FED. AID PROJECT		

TEMPORARY RAMP K INTERSECTION

POINT NUMBER	STATION	OFFSET	ELEVATION
1	22+99.13	78.37 LT	MATCH EXIST.
2	22+93.95	77.72 LT	643.19
3	22+95.43	66.05 LT	643.06
4	22+75.48	28.85 LT	642.06
5	22+35.96	14.00 LT	641.06
6	21+76.71	14.00 LT	639.53
7	21+76.71	2.00 RT	640.24
8	22+39.08	2.00 RT	641.29
9	22+73.79	13.05 RT	640.94
10	22+95.70	42.15 RT	640.58
11	22+13.48	102.93 RT	640.00
12	23+29.42	167.60 RT	639.37
13	23+25.12	168.21 RT	MATCH EXIST.

NOTES:  
 1) CORRUGATED METAL PIPE (CMP) TO BE PAID FOR AS CLASS D PIPE.  
 2) REINFORCED CONCRETE PIPE (RCP) TO BE PAID FOR AS CLASS A PIPE.  
 3) PROVIDE EROSION CONTROL BLANKET ON ALL SLOPES 3:1 AND STEEPER, AND IN ADDITIONAL LOCATIONS DELINEATED BY HATCH SYMBOL ON THIS SHEET.

PLAN	DATE	BY
REVISION		
NO. BOOK		
NO. SHEET		
NO. DRAWING		

**HANSON**  
 Professional Services Inc.  
 2200 South Main Street  
 Springfield, Illinois 62703-2886  
 Offices Nationwide

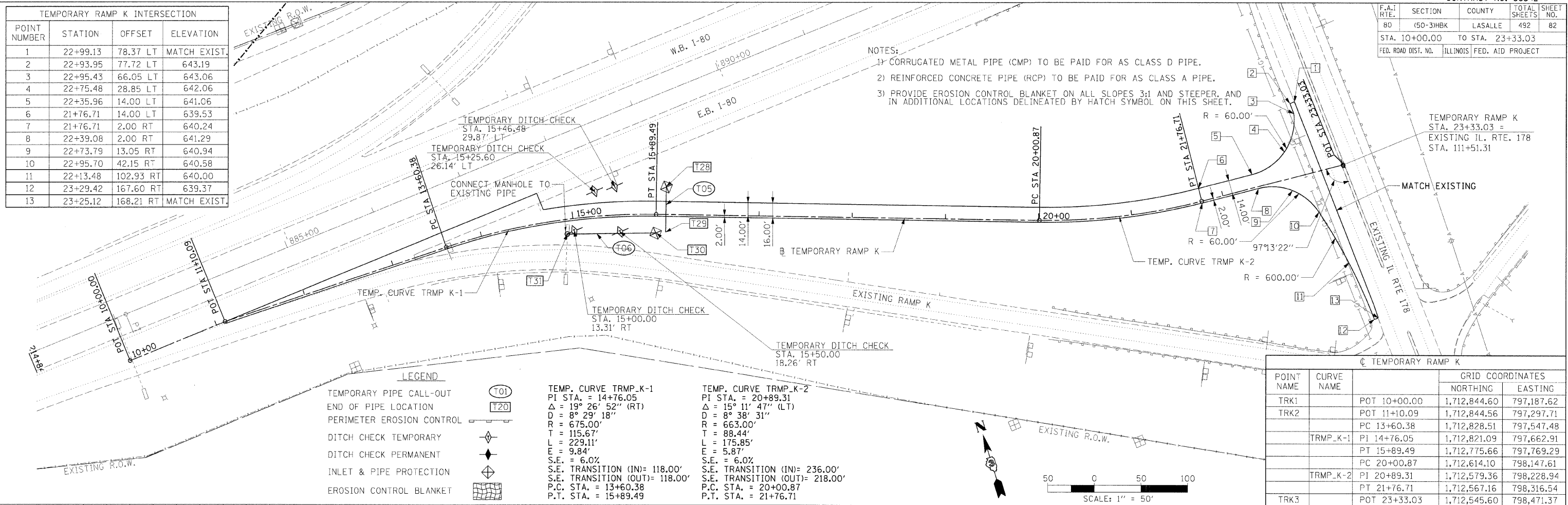

LEGEND

TEMPORARY PIPE CALL-OUT	(T01)
END OF PIPE LOCATION	(T20)
PERIMETER EROSION CONTROL	[Symbol]
DITCH CHECK TEMPORARY	[Symbol]
DITCH CHECK PERMANENT	[Symbol]
INLET & PIPE PROTECTION	[Symbol]
EROSION CONTROL BLANKET	[Symbol]

TEMP. CURVE TRMP\_K-1  
 PI STA. = 14+76.05  
 Δ = 19° 26' 52" (RT)  
 D = 8° 29' 18"  
 R = 675.00'  
 T = 115.67'  
 L = 229.11'  
 E = 9.84'  
 S.E. = 6.0%  
 S.E. TRANSITION (IN) = 118.00'  
 S.E. TRANSITION (OUT) = 118.00'  
 P.C. STA. = 13+60.38  
 P.T. STA. = 15+89.49

TEMP. CURVE TRMP\_K-2  
 PI STA. = 20+89.31  
 Δ = 15° 11' 47" (LT)  
 D = 8° 38' 31"  
 R = 663.00'  
 T = 88.44'  
 L = 175.85'  
 E = 5.87'  
 S.E. = 6.0%  
 S.E. TRANSITION (IN) = 236.00'  
 S.E. TRANSITION (OUT) = 218.00'  
 P.C. STA. = 20+00.87  
 P.T. STA. = 21+76.71

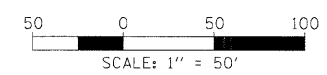

TEMPORARY RAMP K

POINT NAME	CURVE NAME	GRID COORDINATES	
		NORTHING	EASTING
TRK1	POT 10+00.00	1,712,844.60	797,187.62
TRK2	POT 11+10.09	1,712,844.56	797,297.71
	PC 13+60.38	1,712,828.51	797,547.48
	PT 14+76.05	1,712,821.09	797,662.91
	PT 15+89.49	1,712,775.66	797,769.29
	PC 20+00.87	1,712,614.10	798,147.61
TRMP_K-2	PT 20+89.31	1,712,579.36	798,228.94
	PT 21+76.71	1,712,567.16	798,316.54
TRK3	POT 23+33.03	1,712,545.60	798,471.37

PROFILE	DATE	BY
REVISION		
NO. BOOK		
NO. SHEET		
NO. DRAWING		

**HANSON**  
 Professional Services Inc.  
 2200 South Main Street  
 Springfield, Illinois 62703-2886  
 Offices Nationwide

