

F.A.I. RTE.	SECTION	COUNTY	TOTAL SHEETS	SHEET NO.
80	(50-3)HBK	LASALLE	492	146
STA.	TO STA.			
FED. ROAD DIST. NO.	ILLINOIS	FED. AID PROJECT		

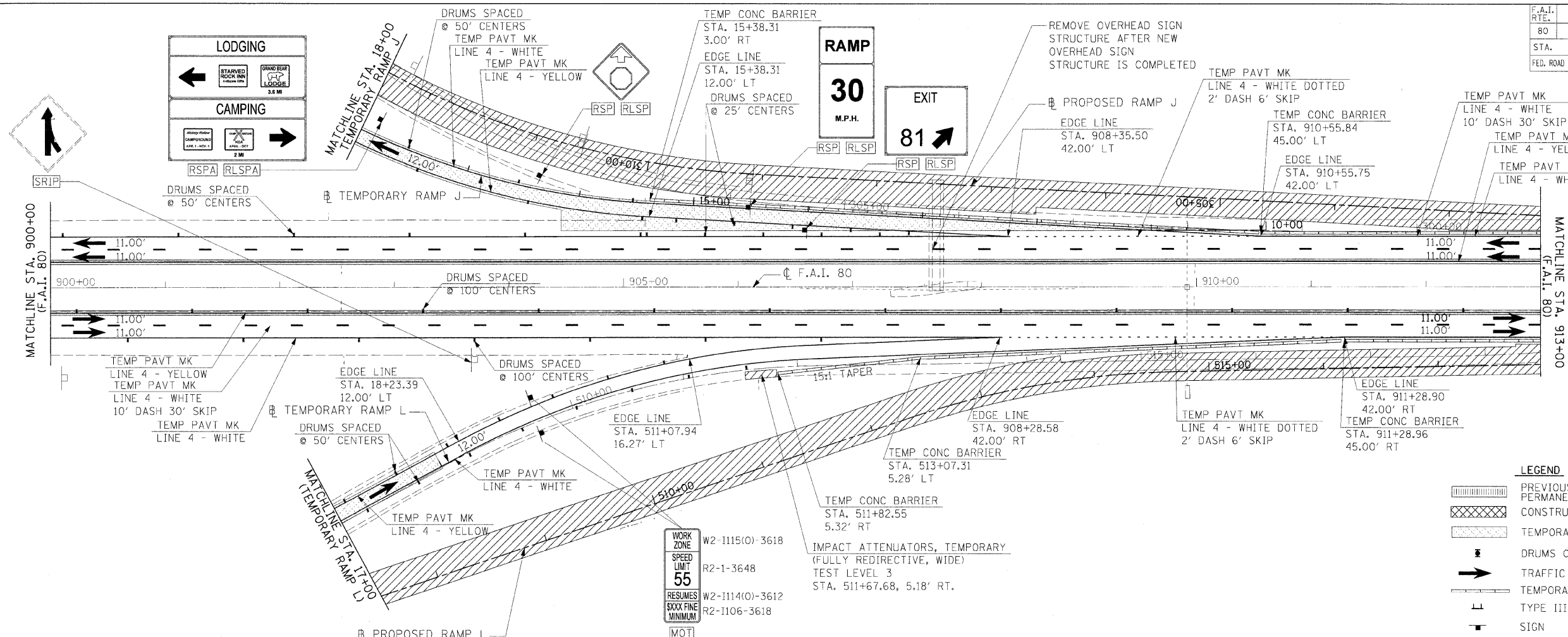

LEGEND

- PREVIOUSLY CONSTRUCTED PERMANENT SHOULDER
- CONSTRUCTION AREA
- TEMPORARY PAVEMENT
- DRUMS OR TYPE II BARRICADES
- TRAFFIC FLOW
- TEMPORARY CONCRETE BARRIER
- TYPE III BARRICADES
- SIGN

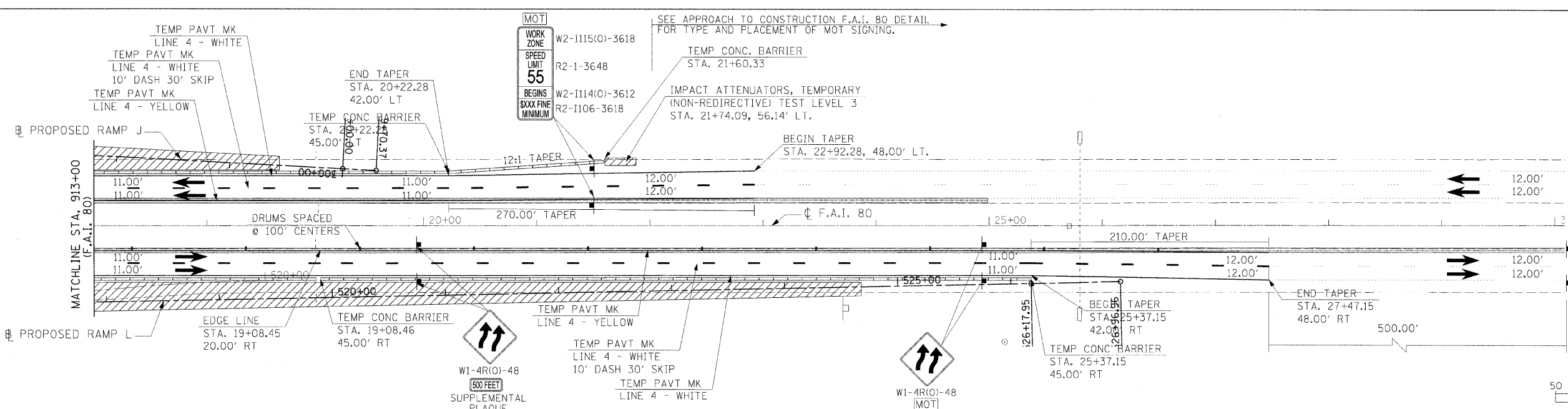

SIGNING LEGEND

- RSPA** REMOVE SIGN PANEL ASSEMBLY (AT END OF STAGE)
- RSP** REMOVE SIGN PANEL (AT END OF STAGE)
- RLSP** RELOCATE SIGN PANEL
- RLSPA** RELOCATE SIGN PANEL ASSEMBLY
- SRIP** SIGN TO REMAIN IN PLACE
- TAS** TEMPORARY ACCESS SIGNS
- MOT** SIGNS TO BE PAID FOR THROUGH TRAFFIC CONTROL STANDARDS

MODEL NAME	= S_1 Phase 1 Sht 2
PLOT DATE	= 12/23/2009
PLOT SCALE	= 50:2000
USER	= Jahn
USER NAME	= Jahn
DATE	= 12/23/09
FILE	= 10/17/07
REVISION	
DATE	
BY	
CHKD	
APP'D	

REVISIONS	
NAME	DATE

ILLINOIS DEPARTMENT OF TRANSPORTATION

MAINTENANCE OF TRAFFIC
STAGE 1 PHASE I
SHEET 2 OF 12

SCALE: VERT. N/A
HORIZ. 1"=50'

DRAWN BY MEW
CHECKED BY

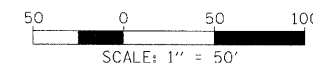

© Copyright Hanson Professional Services Inc. 2009