

F.A.I. RTE.	SECTION	COUNTY	TOTAL SHEETS	SHEET NO.
80	150-318K	LASALLE	492	159
STA.		TO STA.		
FED. ROAD DIST. NO.		ILLINOIS FED. AID PROJECT		



NOTES:

1. DETOUR TO BE USED DURING STAGE 1 RECONSTRUCTION OF IL RTE 178 OVERHEAD STRUCTURE DURING BEAM REMOVAL AND BEAM REPLACEMENT.
2. ALL STOP AHEAD AND STOP SIGNS ON TEMPORARY RAMP K & J AND EXISTING IL. RTE. 178 THAT CONFLICT WITH FLAGGERS TRAFFIC CONTROL SHALL BE TAKEN DOWN OR COVERED DURING THIS PERIOD.
3. ALL FLAGGERS AT EACH RESPECTIVE INTERSECTION SHALL BE IN SIGHT OF EACH OTHER AND BE IN DIRECT COMMUNICATIONS AT ALL TIMES.
4. ALL SIGNS ARE TO BE REMOVED AT THE COMPLETION OF THE OPERATION AND EXISTING SIGNING RESTORED TO ITS EXISTING CONDITION.
5. SIGNS MAY BE ADJUSTED TO FIT CONDITIONS.

LEGEND

- AREAS OF CONSTRUCTION FOR THIS STAGE
- TRAFFIC FLOW FOR THIS FLOW
- LOCATION OF FLAGGERS CONTROLLING TRAFFIC W/ LIGHT STATION

© Copyright Hanson Professional Services Inc. 2009
HANSON
 Hanson Professional Services Inc.
 1525 South Sixth Street
 Springfield, Illinois 62703-2886
 Offices Nationwide

MODEL NAME	Stage1Detour-1
PLOT DATE	12/23/2009
PLOT SCALE	1/8"=10' (1/4"=10')
USER NAME	JohnA00944
LAYOUT	RSJ 09/20/05
DRAWN	RSJ 09/20/05
REVIEWED	MTM 10/1/07

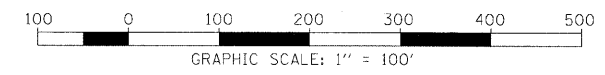
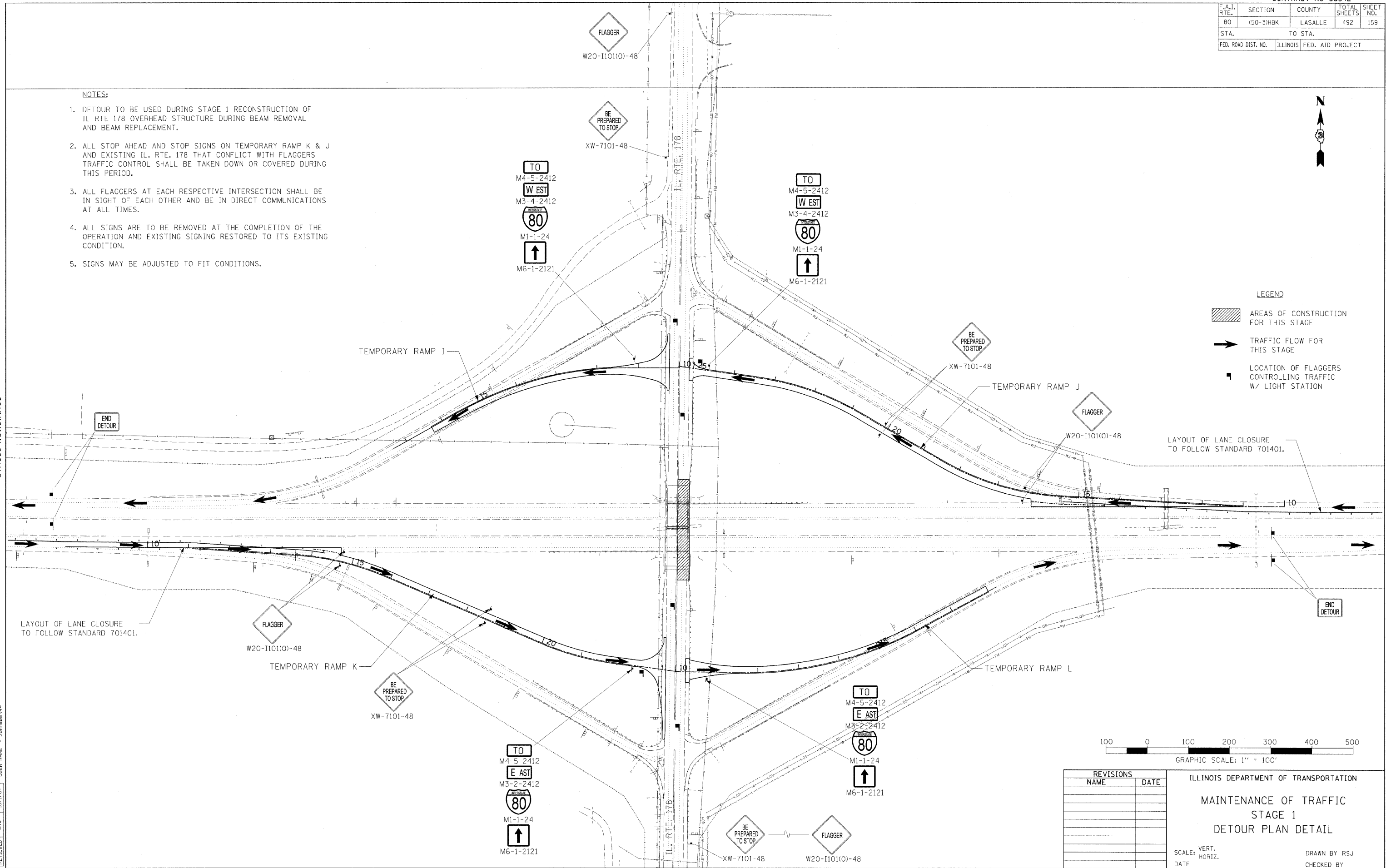

REVISIONS	
NAME	DATE

ILLINOIS DEPARTMENT OF TRANSPORTATION

**MAINTENANCE OF TRAFFIC
STAGE 1
DETOUR PLAN DETAIL**

SCALE: VERT.
HORIZ.

DATE

DRAWN BY RSJ
CHECKED BY