

F.A.I. RTE.	SECTION	COUNTY	TOTAL SHEETS	SHEET NO.
80	150-318K	LASALLE	492	219
STA.		TO STA.		
FED. ROAD DIST. NO.		ILLINOIS FED. AID PROJECT		

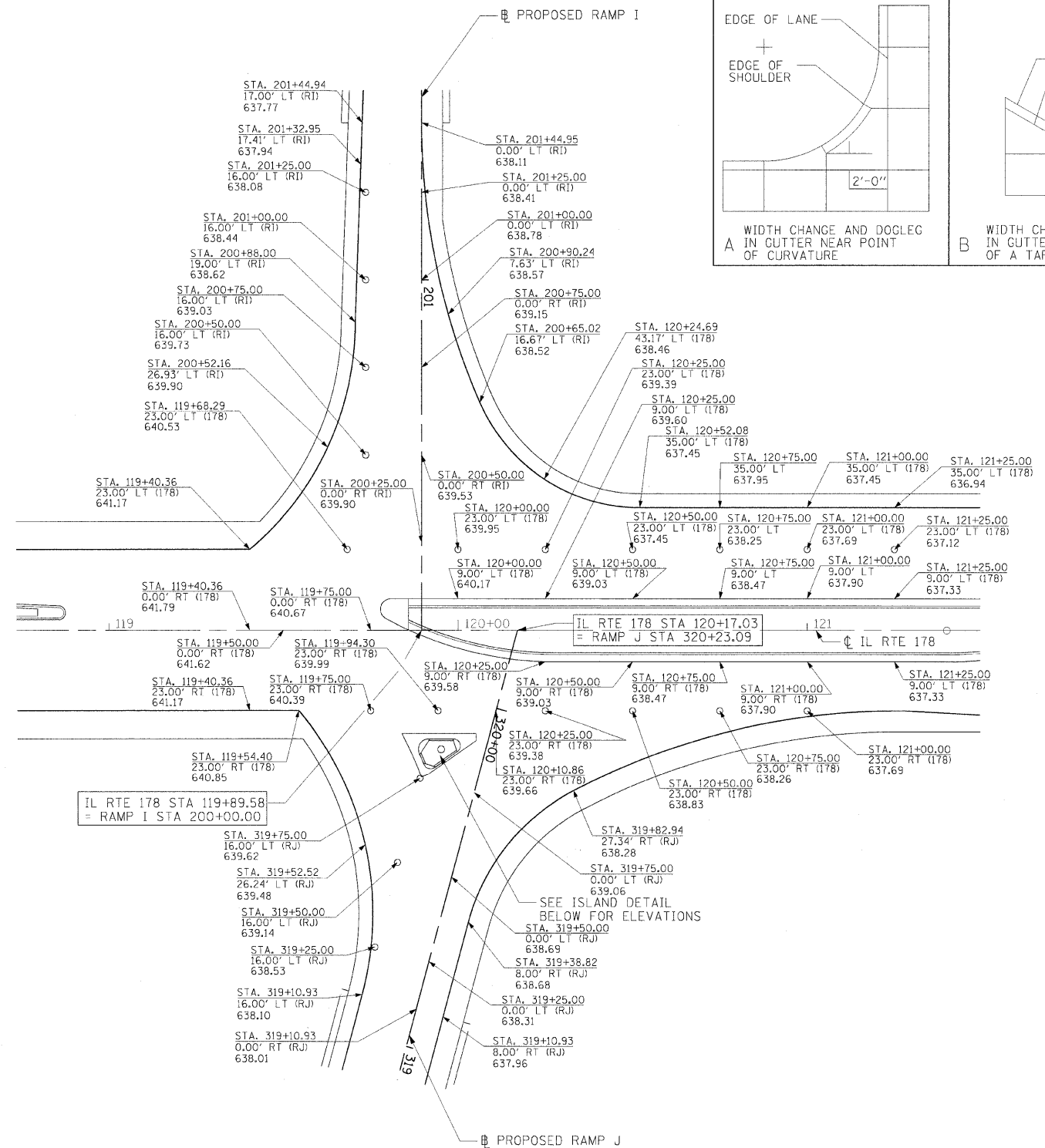

INTERSECTION ELEVATION DETAIL
RAMPS I & J/IL RTE 178

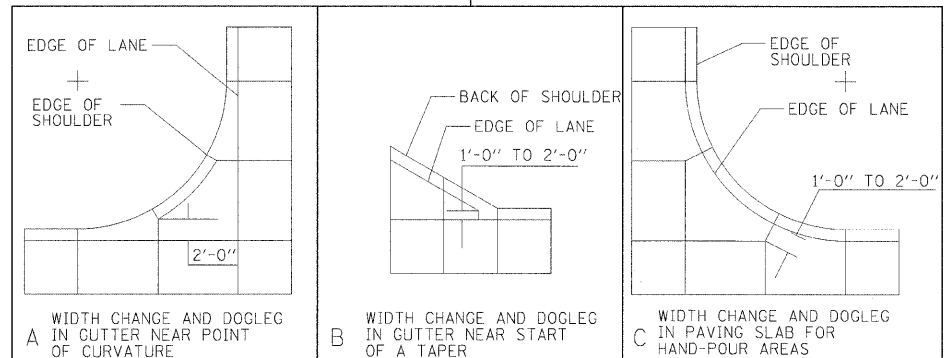
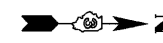
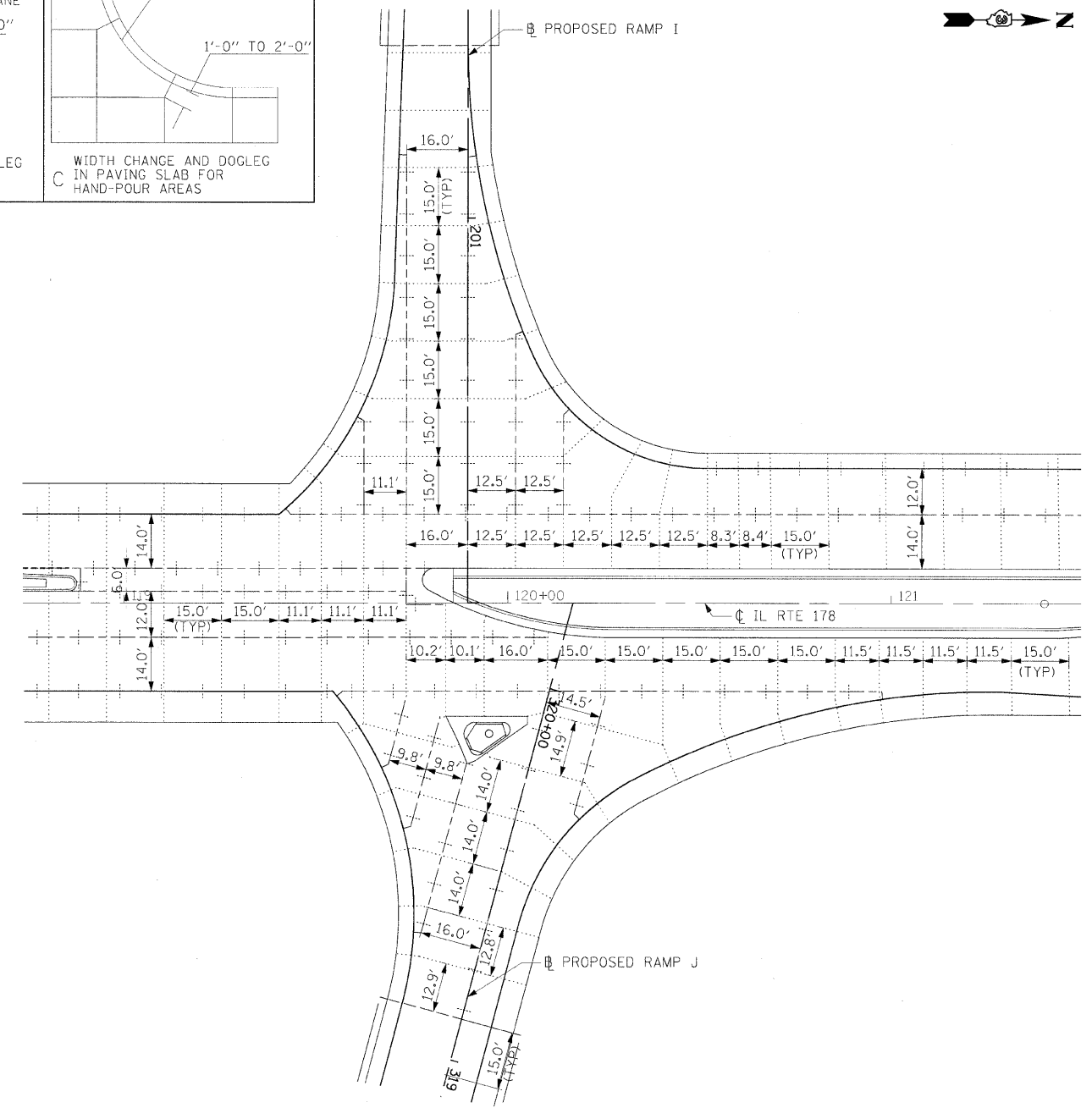

INTERSECTION JOINTING DETAIL
RAMPS I & J/IL RTE 178

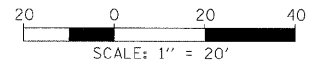

HANSON
Hanson Professional Services Inc.
1525 South Sixth Street
Springfield, Illinois 62703-2886
Offices Nationwide

MODEL NAME = I and J J
PLOT DATE = 12/23/2009
PLOT SCALE = 20.0000
USER NAME = John-M009144

LAYOUT	RSJ	01/05/06
DRAWN	RSJ	01/05/06
REVIEWED	MTM	10/17/07

LEGEND
(178) = IL. RTE. 178
(RI) = RAMP I
(RJ) = RAMP J

STATION
OFFSET (BASELINE)
ELEVATION

NOTE:
SEE PROPOSED RAMP I & J
INTERSECTION DETAIL FOR
ISLAND GEOMETRY.

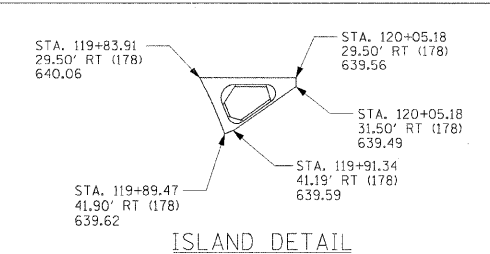

ISLAND DETAIL

LEGEND
--- SAWED LONGITUDINAL JOINT OR LONGITUDINAL CONSTRUCTION JOINT
..... DOWELED TRANSVERSE CONTRACTION JOINT
- - - EXPANSION JOINT

REVISIONS	
NAME	DATE

ILLINOIS DEPARTMENT OF TRANSPORTATION
**INTERSECTION JOINTING & ELEVATION DETAIL
PROPOSED RAMP I & J
AND IL RTE 178**
SCALE: VERT. 1" = 20'
HORIZ. 1" = 20'
DRAWN BY RDJ
CHECKED BY