

F.A. RTE.	SECTION	COUNTY	TOTAL SHEETS	SHEET NO.
80	50-3HBK	LASALLE	492	326
STA. 301+50.00 TO STA. 302+50.00				
FED. ROAD DIST. NO.		ILLINOIS FED. AID PROJECT		

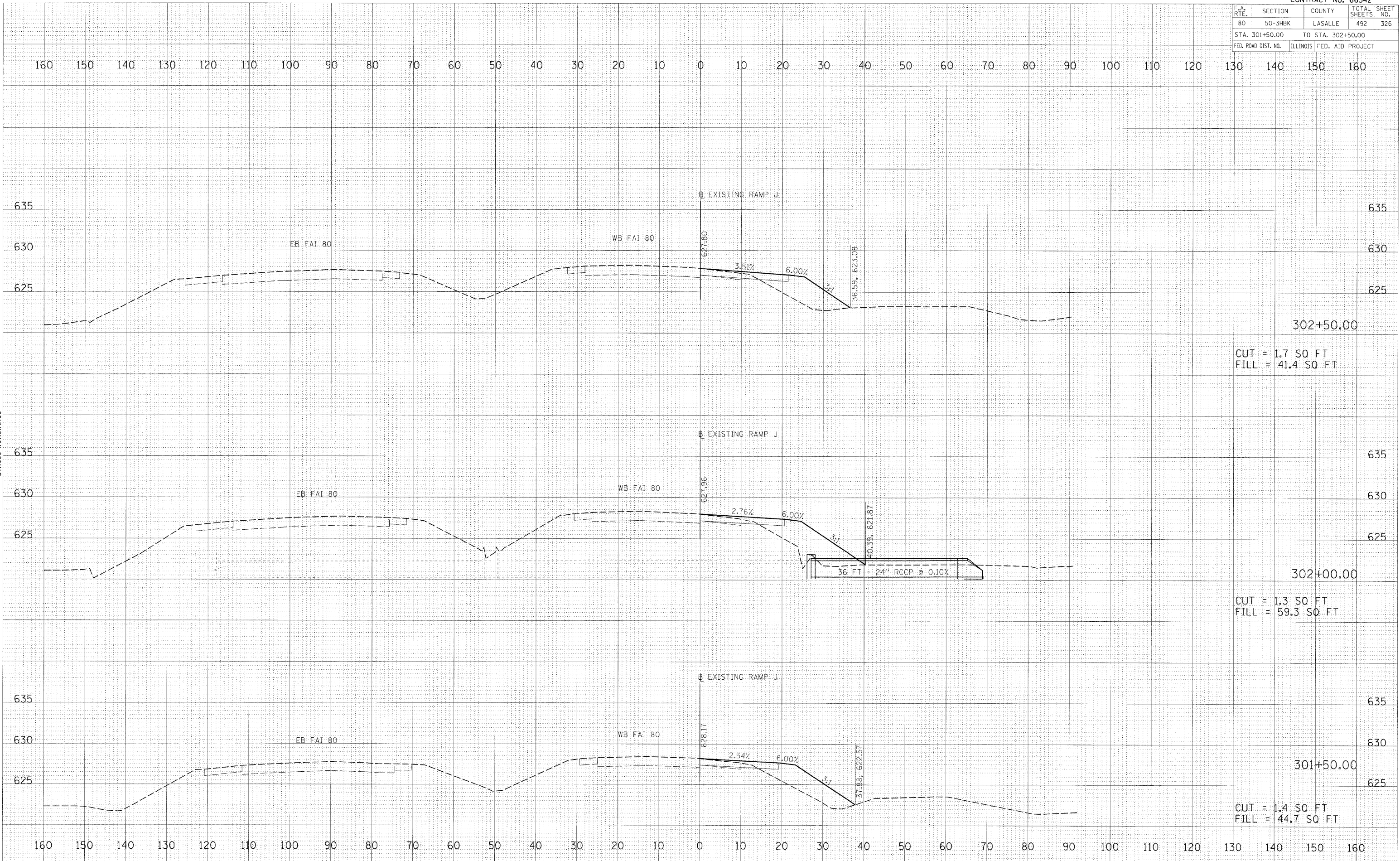

EXIST. RAMP J WIDENING PRESTAGE PHASE II STATION 301+50.00 TO STATION 302+50.00

FINAL SURVEY

BY	DATE

© Copyright Hanson Professional Services Inc. 2009  
**HANSON**  
 Hanson Professional Services Inc.  
 1525 South Sixth Street  
 Springfield, Illinois 62703-2886  
 Offices Nationwide

ORIGINAL SURVEY

BY	DATE

PLOT DATE = 12/23/2009  
 FILE NAME = I:\2009\12\23\2009\CAD\Road\Sheet\PRESTAGE\PHASE II\301+50.00.dwg  
 PLOT SCALE = 1/4" = 1'-0"  
 USER NAME = jjohnson