

F.A. RTE.	SECTION	COUNTY	TOTAL SHEETS	SHEET NO.
80	50-3HBK	LASALLE	492	372
STA. 905+00.00		TO STA. 907+00.00		
FED. ROAD DIST. NO.		ILLINOIS	FED. AID PROJECT	

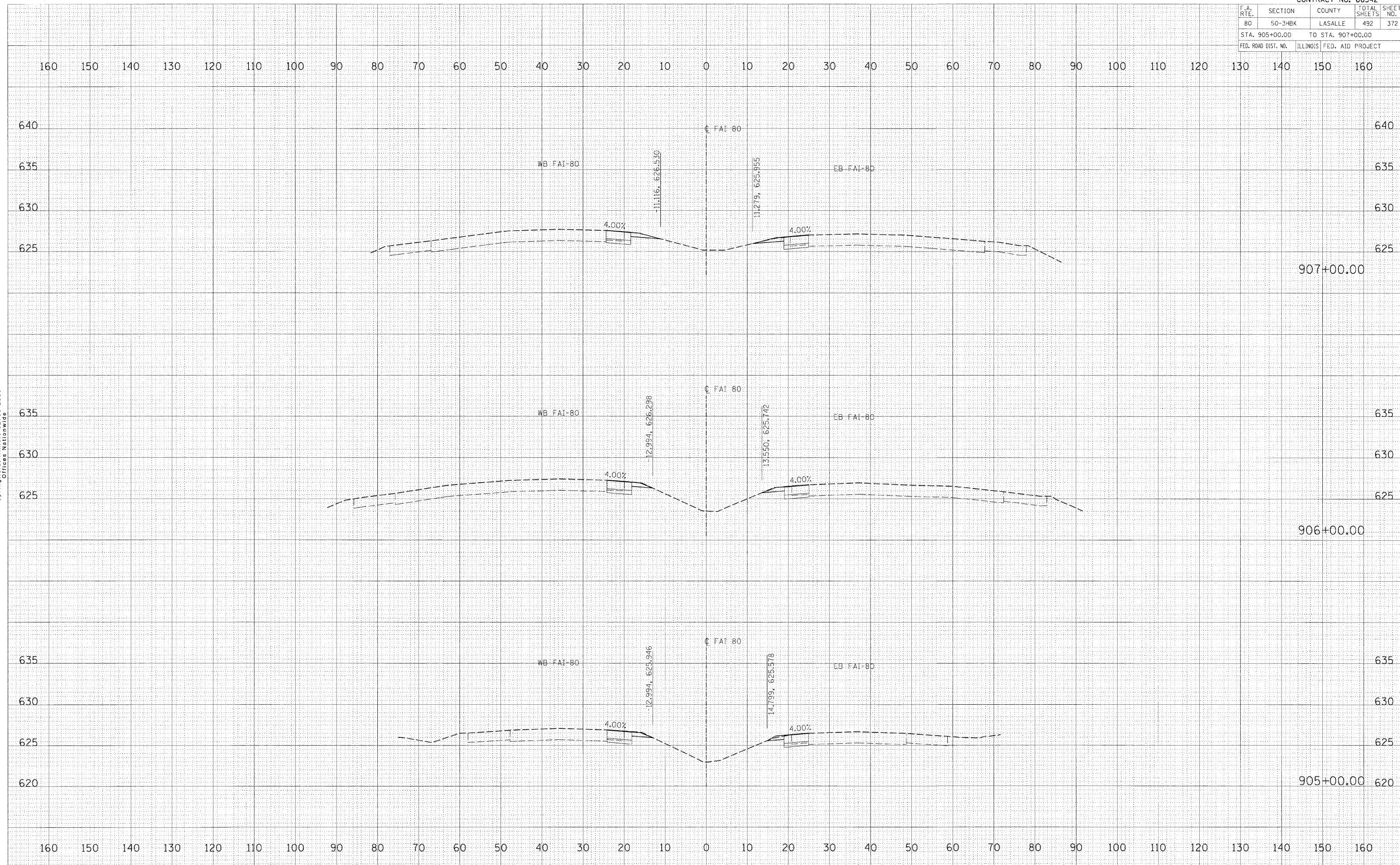

FINAL SURVEY

DATE	
BY	
SURVEYED	
AMPLIFIED	
AREAS CHECKED	
NO. BOOK	
NO.	

HANSON
 Hanson Professional Services Inc.
 1525 South Sixth Street
 Springfield, Illinois 62703-2886
 Offices Nationwide

ORIGINAL SURVEY

DATE	
BY	
SURVEYED	
AMPLIFIED	
AREAS CHECKED	
NO. BOOK	
NO.	

PLOT DATE = 12/23/2009
 FILE NAME = I:\05\aha\9052015\ROAD\ROAD\50-3HBK\FAI-80.dwg
 PLOT SCALE = 1/8" = 1'-0"
 USER NAME = John@20944