

F.A.U. RTE.	SECTION	COUNTY	TOTAL SHEETS	SHEET NO.
6097	50-8 HBR	LASALLE	143	31
STA. 303+00.00		TO STA. 309+14.95		
FED. ROAD DIST. NO. 3 ILLINOIS FED. AID PROJECT				

THIS IS FOR INFORMATION ONLY. THE HOT-SPOTS ON THIS SHEET HAVE BEEN LABELED ACCORDING TO THE PHASE I REPORT.

PROJECT ENDS
PLANK ROAD
STA. 309+14.95

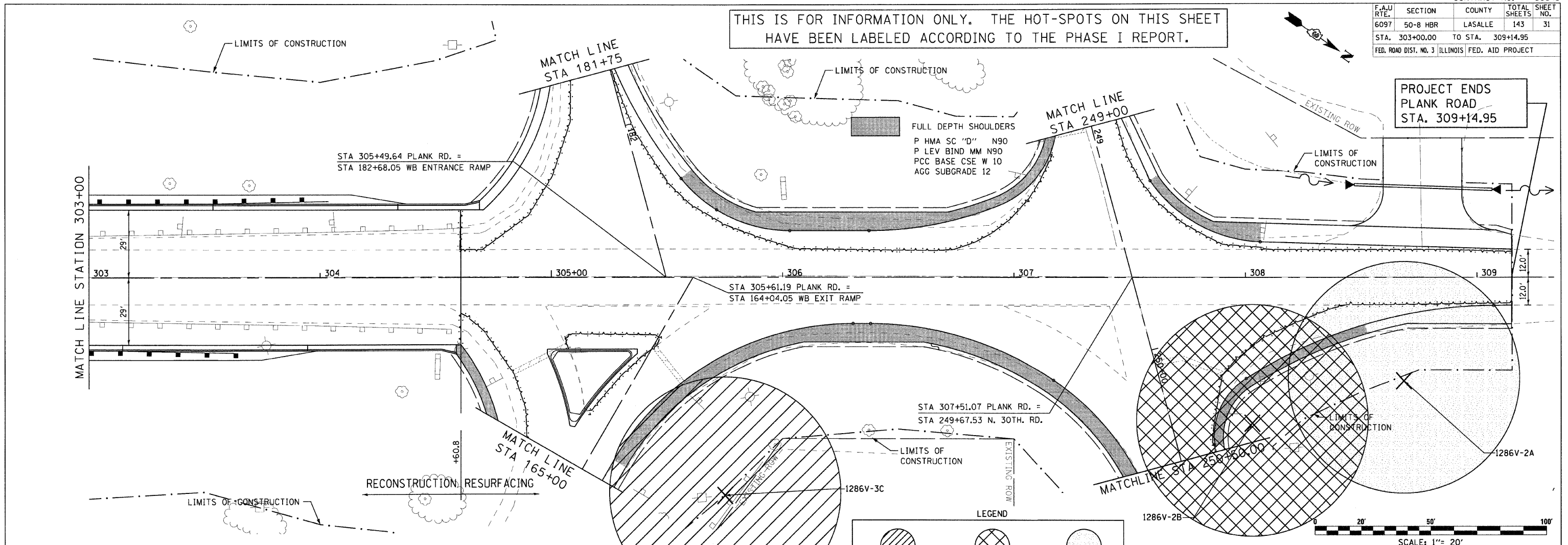

LEGEND

- NO GRADING OR EXCAVATION
- 4 FT DEPTH
- 6 FT DEPTH

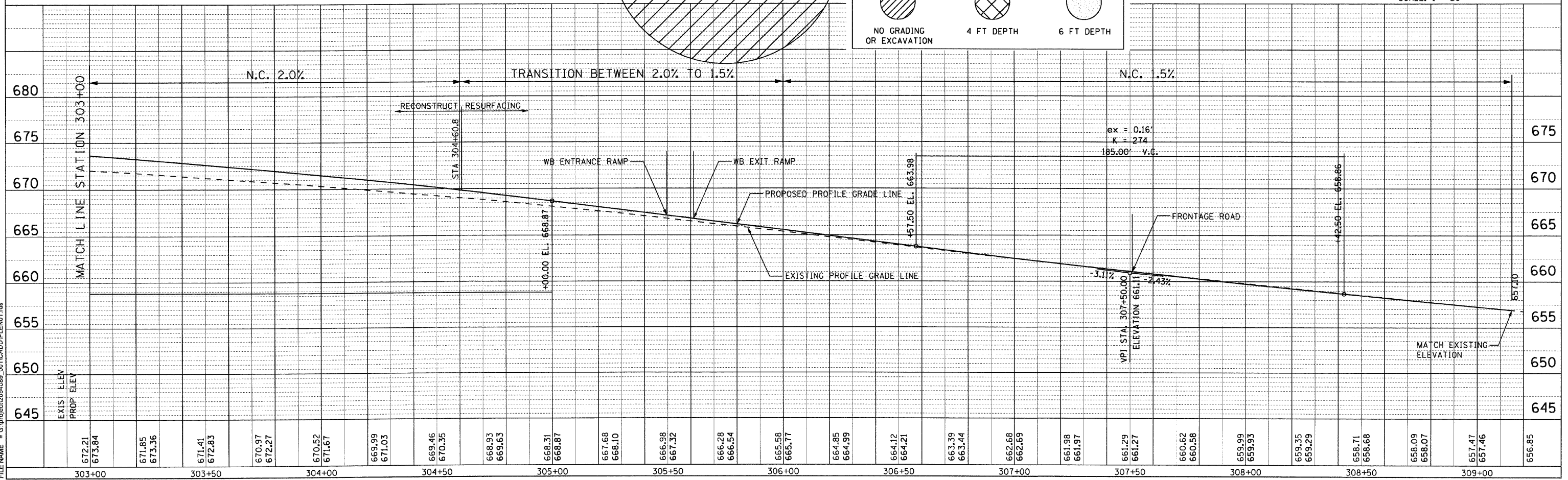

PLOT DATE = 2/4/2010 PLOT TIME = 4:01:35 PM
 FILE NAME = G:\project\205\089_001\CADD\PILENO1.rds

PLAN	SURVEYED	DATE
NO.	BY	
	CHECKED	
	DATE	

PROFILE	SURVEYED	DATE
NO.	BY	
	CHECKED	
	DATE	