

F.A.U. RTE.	SECTION	COUNTY	TOTAL SHEETS	SHEET NO.
1-80	50-8 HBR	LASALLE	143	38
STA. 303+00.00 TO STA. 309+14.95		FED. ROAD DIST. NO. 3 ILLINOIS FED. AID PROJECT		

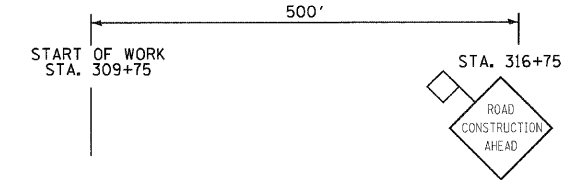
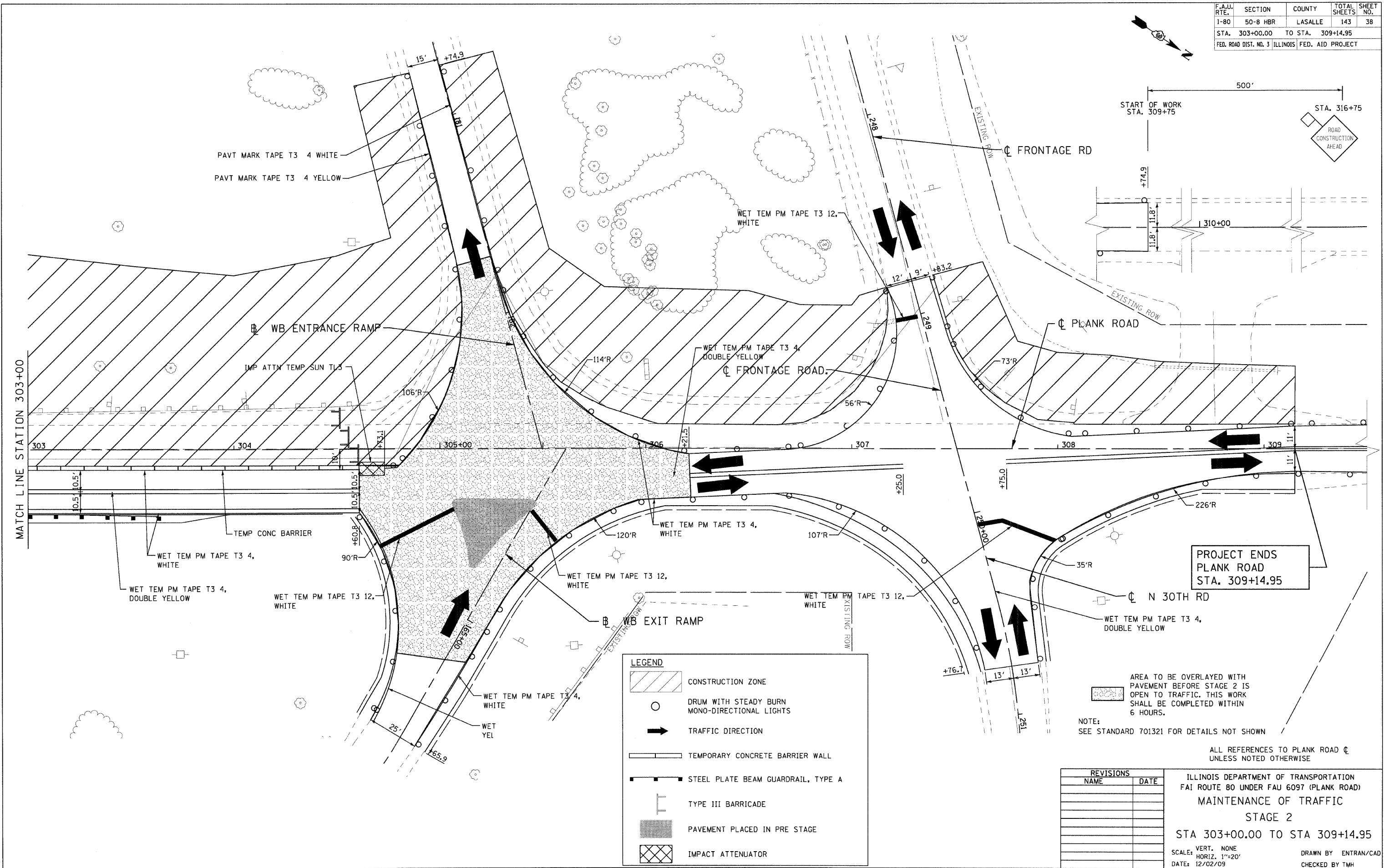
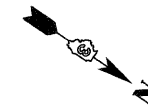

PROJECT ENDS  
PLANK ROAD  
STA. 309+14.95

NOTE:  
SEE STANDARD 701321 FOR DETAILS NOT SHOWN

ALL REFERENCES TO PLANK ROAD  $\phi$   
UNLESS NOTED OTHERWISE

**LEGEND**

- CONSTRUCTION ZONE
- DRUM WITH STEADY BURN MONO-DIRECTIONAL LIGHTS
- TRAFFIC DIRECTION
- TEMPORARY CONCRETE BARRIER WALL
- STEEL PLATE BEAM GUARDRAIL, TYPE A
- TYPE III BARRICADE
- PAVEMENT PLACED IN PRE STAGE
- IMPACT ATTENUATOR

REVISIONS	
NAME	DATE

ILLINOIS DEPARTMENT OF TRANSPORTATION  
FAI ROUTE 80 UNDER FAU 6097 (PLANK ROAD)  
MAINTENANCE OF TRAFFIC  
STAGE 2  
STA 303+00.00 TO STA 309+14.95  
SCALE: VERT. NONE  
HORIZ. 1"=20'  
DATE: 12/02/09  
DRAWN BY ENTRAN/CAD  
CHECKED BY TMH

PLOT DATE = 2/1/2010  
 FILE NAME = G:\projects\120640891\001\cadd\PLM12\_031.dwg  
 PLOT SCALE = 20.0000 / IN.  
 PLOT TIME = 4:01:55 PM

