

F.A.U. RTE.	SECTION	COUNTY	TOTAL SHEETS	SHEET NO.
FAT 80	50 - 8HBR	LASALLE	142	53
STA.	TO STA.			
FED. ROAD DIST. NO. 3	ILLINOIS FED. AID PROJECT			

- NOTES:
1. ALL LIGHTING WORK SHOWN ON THIS PLAN SHALL BE INSTALLED AND MADE OPERATIONAL PRIOR TO COMMENCEMENT OF STAGE 1 CONSTRUCTION.
 2. THE CONTRACTOR SHALL PROVIDE AND INSTALL 50' WOOD POLES IN THE LOCATIONS SPECIFIED TO SUPPORT THE PROPOSED TEMPORARY AERIAL CABLES.
 3. THE CONTRACTOR SHALL REMOVE, STORE, AND DELIVER (FROM AND TO THE SITE) ANY LIGHTING EQUIPMENT TO ACCOMPLISH THE RELOCATION OF THE EXISTING LIGHTING EQUIPMENT.
 4. THE REMOVAL OF THE 2" CONDUIT ATTACHED TO STRUCTURE FOR TEMPORARY USE SHALL COINCIDE WITH THE REMOVAL OF THE STAGE 1 TEMPORARY LIGHTING SYSTEM AND SHALL BE INCIDENTAL TO THE CONDUIT ATTACHED TO STRUCTURE PAY ITEM. NO EXTRA COMPENSATION WILL BE MADE.
 5. THE REMOVAL OF THE 12"X10"X6" JUNCTION BOXES FOR THE TEMPORARY USE SHALL COINCIDE WITH THE REMOVAL OF THE STAGE 1 TEMPORARY LIGHTING SYSTEM AND SHALL BE INCIDENTAL TO THE PAY ITEM OF JUNCTION BOX. NO SEPARATE COMPENSATION WILL BE MADE.

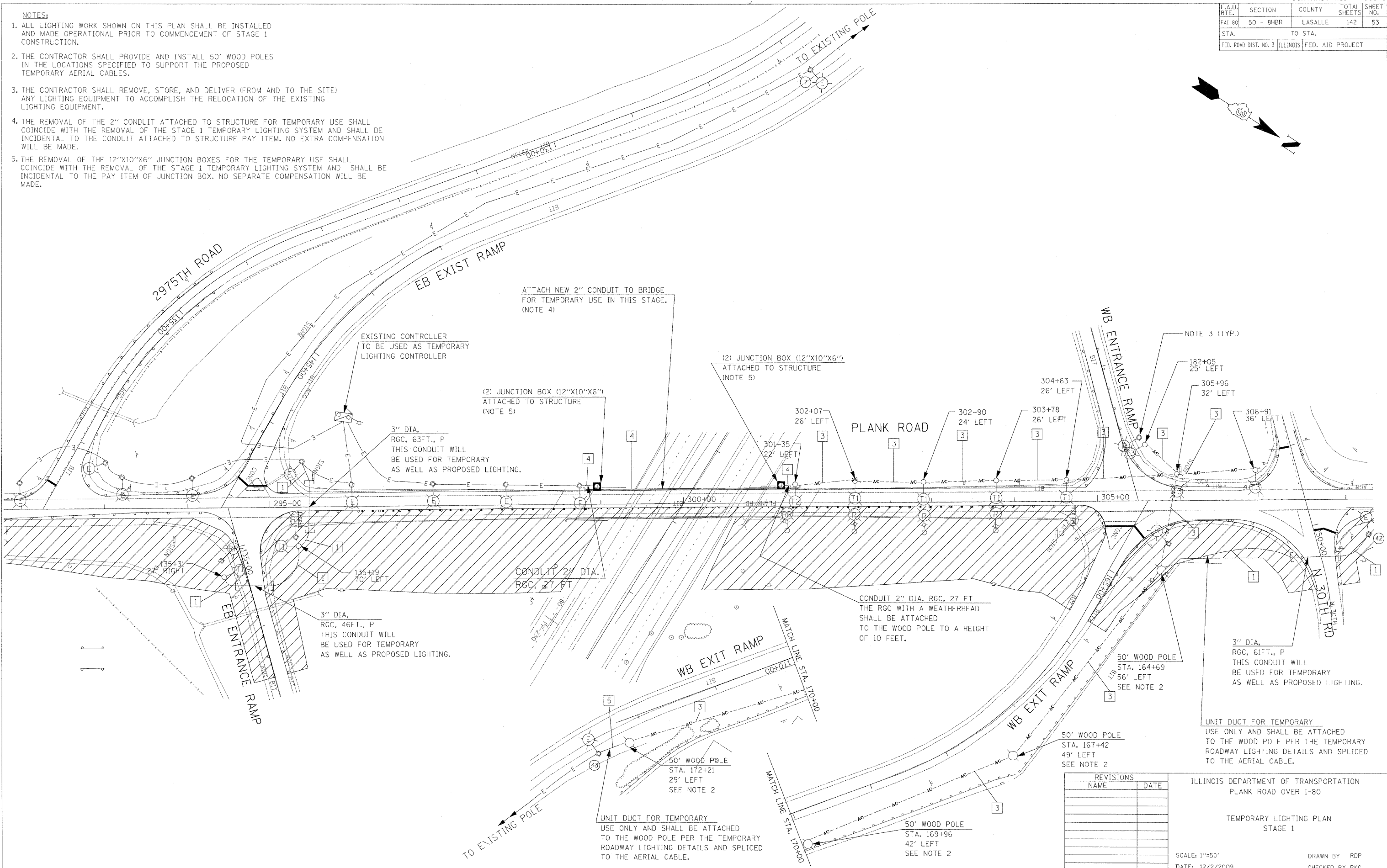
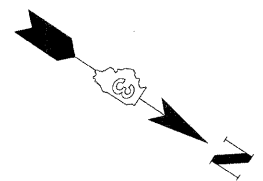

PLOT DATE = 2/2/2009
 FILE NAME = 6FILEL6
 PLOT SCALE = 6SCALE6
 PLOT TIME = 11:24:19 AM

REVISIONS	
NAME	DATE

ILLINOIS DEPARTMENT OF TRANSPORTATION
 PLANK ROAD OVER I-80
 TEMPORARY LIGHTING PLAN
 STAGE 1
 SCALE: 1"=50'
 DATE: 12/2/2009
 DRAWN BY RDP
 CHECKED BY PKG