

NOTES:

- REFER TO STANDARD 606301 (SM 4.24)
- PRIOR TO REMOVAL OF EXISTING MEDIAN, A FULL DEPTH SAW CUT WILL BE REQUIRED THE LENGTH OF THE EXISTING MEDIAN AND WILL BE INCLUDED IN THE COST OF MEDIAN REMOVAL
- REMOVE AND REPLACE ON EXISTING STATIONS, (STATIONS AND OFFSETS ARE SHOWN FOR GENERAL REFERENCE ONLY).
- MEDIAN NOSES AT STATIONS 305+78 AND 307+04 SHALL BE RELOCATED 10 FEET FROM ORIGINAL LOCATION. ADDITIONAL PCC BASECOURSE IN THESE AREAS SHALL BE PAID FOR AT THE CONTRACT UNIT PRICE FOR CONCRETE MEDIANS.
- REFER TO DETAIL A FOR PROPOSED RAMP NOSE CONFIGURATION.
- UTILIZE TRAFFIC CONTROL STANDARD 701502-02.

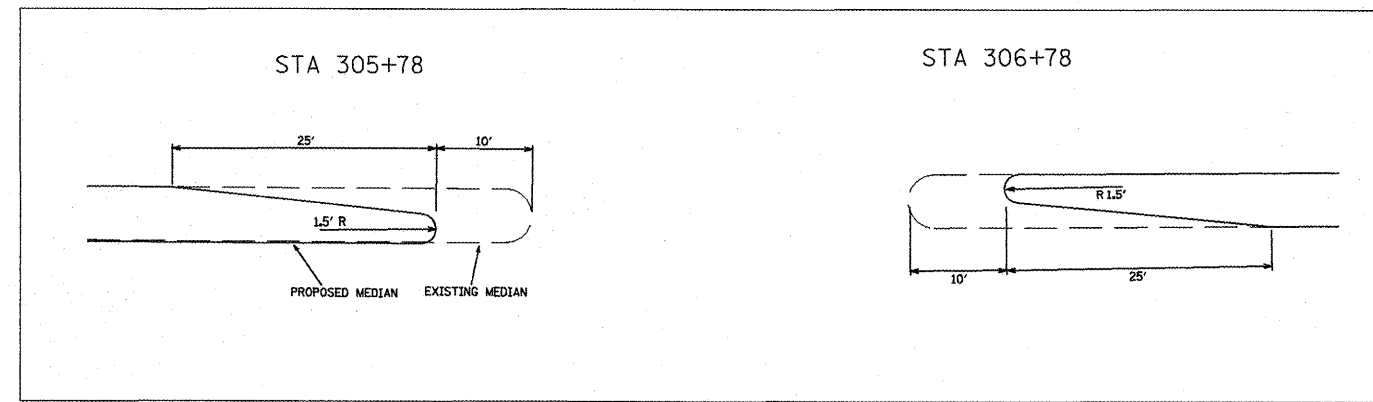

**DETAIL A**

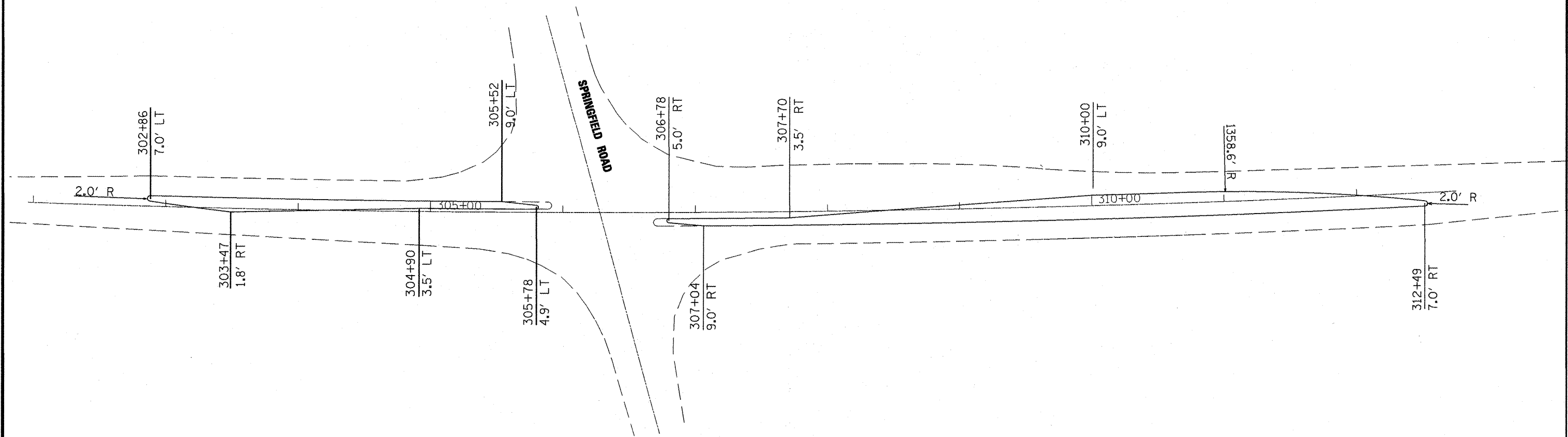

FILE NAME = 68460 Phase II.dgn	USER NAME = jacobsmr	DESIGNED -	REVISED -
		DRAWN -	REVISED -
		CHECKED -	REVISED -
		DATE -	REVISED -

**STATE OF ILLINOIS  
DEPARTMENT OF TRANSPORTATION**

<b>MEDIAN DETAIL</b>	
NOT TO SCALE	SHEET NO. OF SHEETS

F.A.P. RTE.	SECTION	COUNTY	TOTAL SHEETS	SHEET NO.
693	115RS-5, 118RS-7	TAZEWELL	36	15
CONTRACT NO. 68460				
ILLINOIS FED. AID PROJECT				