

DESIGNER: CLARK JONES
PHONE: (309)671-3452

PROJECT ENGINEER: JIM MILLER
PHONE: (309)671-3451

STATE OF ILLINOIS
DEPARTMENT OF TRANSPORTATION
DIVISION OF HIGHWAYS

**PROPOSED
HIGHWAY PLANS**

FAP 622 ROUTE IL. 97
SECTION (128BR-1)I
MISC. BRIDGE REPAIRS
FULTON COUNTY

F.A.P. RTE.	SECTION	COUNTY	TOTAL SHEETS	SHEET NO.
622	(128BR-1)I	FULTON	23	J..
FED. ROAD DIST. NO. 4		ILLINOIS	CONTRACT NO. 68927	

23+1=24

D-94-093-09

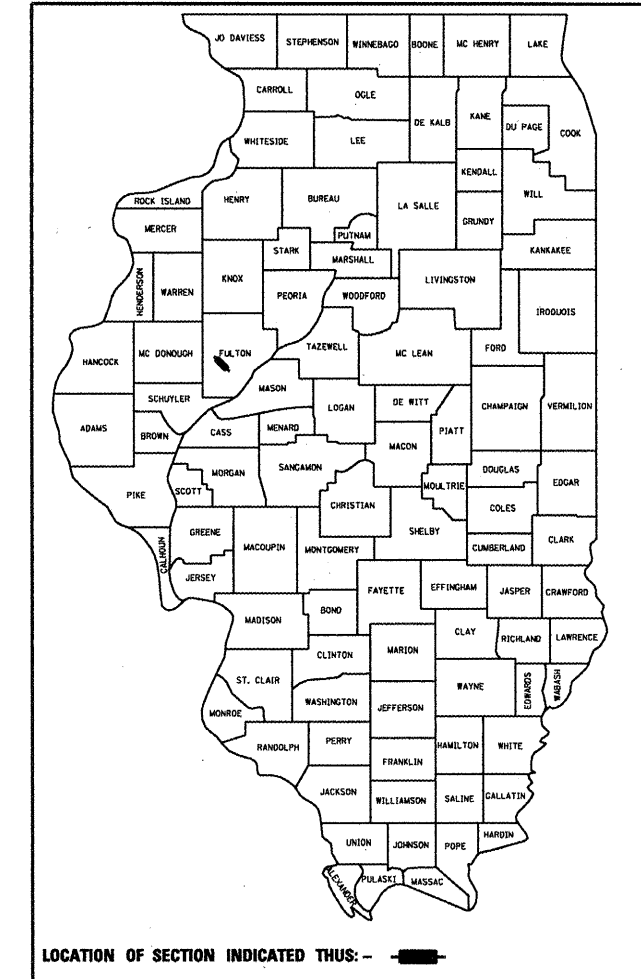

INDEX OF SHEETS:

1. COVER SHEET
2. COMMITMENTS & GENERAL NOTES
3. SUMMARY OF QUANTITIES
- 4-5. SCHEDULE OF QUANTITIES
6. GENERAL LAYOUT
- 7-9. PROPOSED TRAFFIC CONTROL
- 10-18. REPAIR DETAILS
- 19-23. DISTRICT STANDARDS

STANDARDS:

DISTRICT STANDARDS:

- | | | |
|-----------|-----------|---------|
| 701001-02 | 701901-01 | 630101- |
| 701006-03 | 704001-06 | |
| 701201-03 | 780001-02 | |
| 701321-10 | | |

C-94-154-09

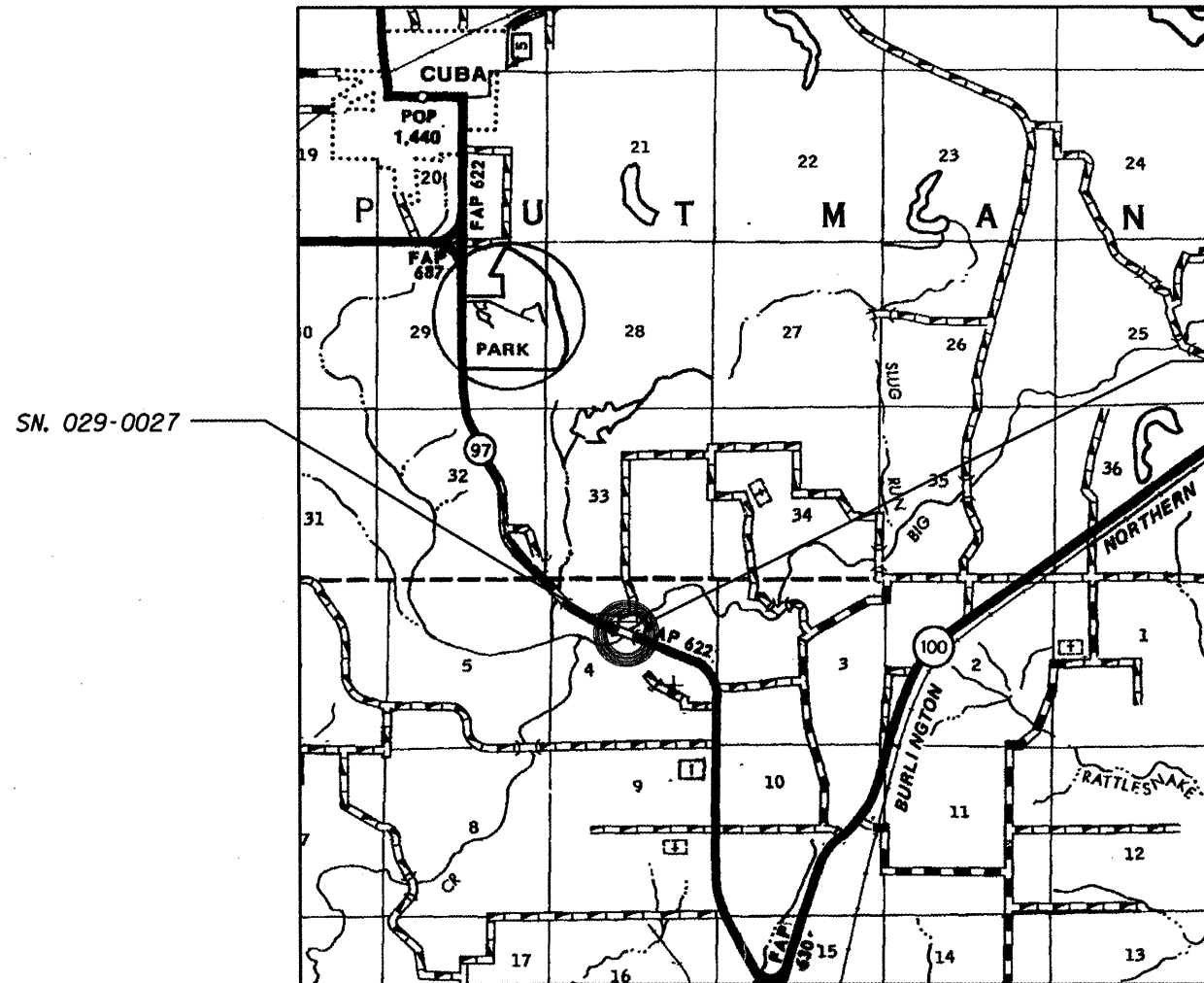

REMOVE & REPLACE WEARING SURFACE WITH LATEX MODIFIED CONCRETE, EXISTING JOINTS WITH STRIP SEALS, DECK PATCHING, S. ABUT. CAP REPAIR, N. ABUT. BACKWALL REPAIR AND NELSON BEAM REPLACEMENTS ON STRUCTURE CARRYING IL. 97 OVER BIG CRK. (SN.029-0027), 4 MILES SOUTH OF CUBA.

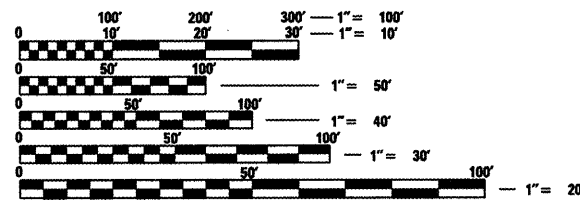

FULL SIZE PLANS HAVE BEEN PREPARED USING STANDARD ENGINEERING SCALES. REDUCED SIZED PLANS WILL NOT CONFORM TO STANDARD SCALES. IN MAKING MEASUREMENTS ON REDUCED PLANS, THE ABOVE SCALES MAY BE USED.

J.U.L.I.E.
JOINT UTILITY LOCATION INFORMATION FOR EXCAVATION
1-800-892-0123
OR 811

PROJECT ENGINEER: JIM MILLER

STATE OF ILLINOIS
DEPARTMENT OF TRANSPORTATION
DIVISION OF HIGHWAYS

SUBMITTED *Feb 9 2010*

March 10 2010
Deputy Director of Highways, Region Engineer

Scott E. Still P.E.
Acting Engineer of Design and Environment

March 19 2010
Christine M. Reed/pe
Director of Highways, Chief Engineer

PRINTED BY THE AUTHORITY
OF THE STATE OF ILLINOIS

CONTRACT NO. 68927 CATALOG NO. 034309-00D

LOCATION MAP