

SEC. 3, T21N, R9E

SEC. 2, T21N, R9E

EXIST. CURVE DATA
 PI STA. = 2295+02.08
 $\Delta = 6^\circ 12' 38''$ (LT)
 $D = 1^\circ 00' 09''$
 $R = 5,715.11'$
 $T = 310.05'$
 $L = 619.49'$
 $E = 8.40'$
 P.C. STA. = 2291+92.03
 P.T. STA. = 2298+11.50



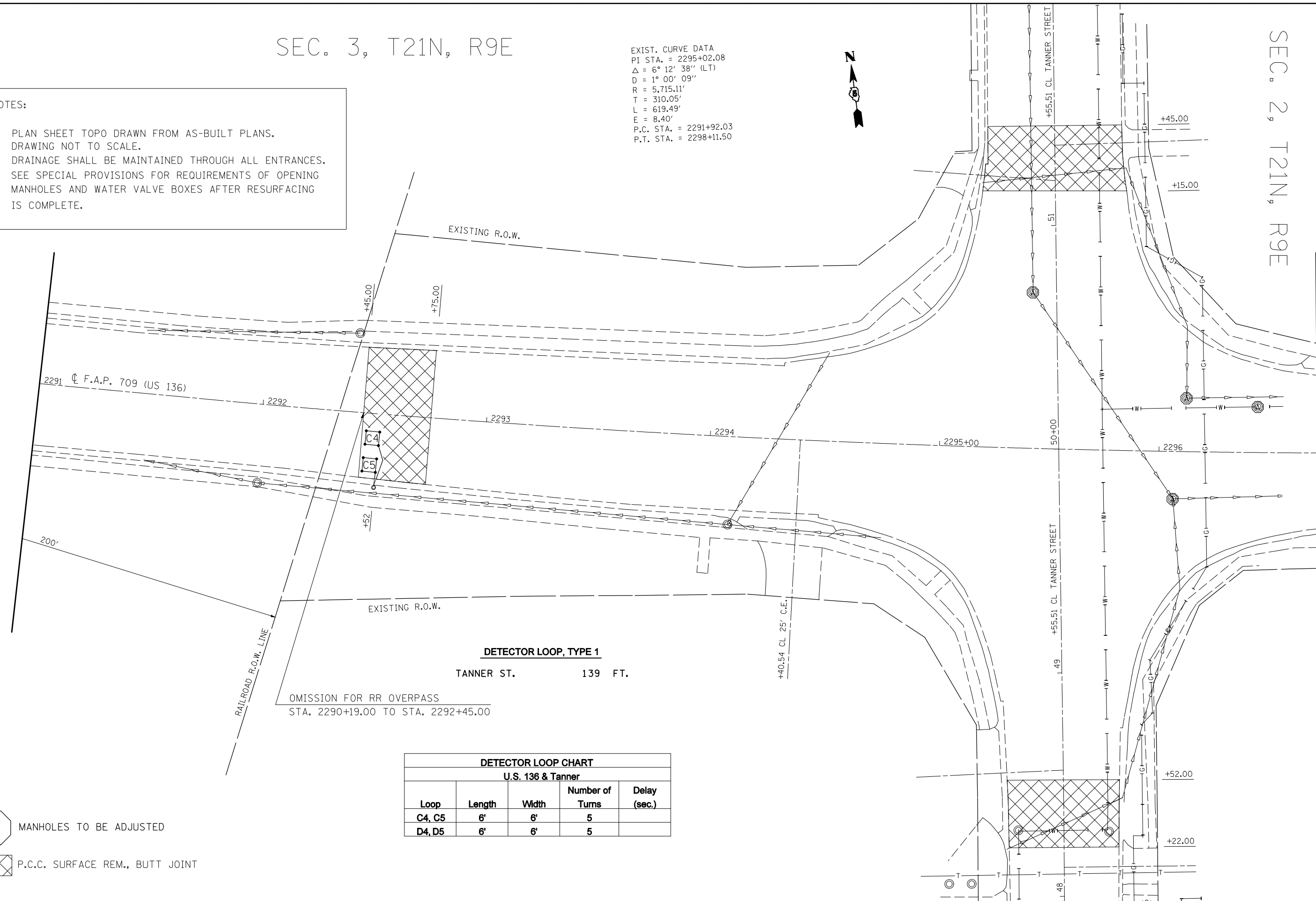

- NOTES:
1. PLAN SHEET TOPO DRAWN FROM AS-BUILT PLANS. DRAWING NOT TO SCALE.
 2. DRAINAGE SHALL BE MAINTAINED THROUGH ALL ENTRANCES.
 3. SEE SPECIAL PROVISIONS FOR REQUIREMENTS OF OPENING MANHOLES AND WATER VALVE BOXES AFTER RESURFACING IS COMPLETE.



DETECTOR LOOP, TYPE 1
 TANNER ST. 139 FT.

OMISSION FOR RR OVERPASS
 STA. 2290+19.00 TO STA. 2292+45.00

DETECTOR LOOP CHART				
U.S. 136 & Tanner				
Loop	Length	Width	Number of Turns	Delay (sec.)
C4, C5	6'	6'	5	
D4, D5	6'	6'	5	

-  MANHOLES TO BE ADJUSTED
-  P.C.C. SURFACE REM., BUTT JOINT

FILE NAME =	USER NAME = hoganbj	DESIGNED - BJM	REVISED -
ct:\pw\work\PWIDOT\HOGANBJ\d0104446\7017\sheets.dgn		DRAWN - BJH	REVISED -
	PLOT SCALE = 40.0000' / IN.	CHECKED -	REVISED -
	PLOT DATE = 1/29/2010	DATE - 1/21/2010	REVISED -

STATE OF ILLINOIS
DEPARTMENT OF TRANSPORTATION

PLAN SHEETS

SCALE: 1" = 20' SHEET NO. 5 OF 20 SHEETS STA. 2291+00 TO STA. 2296+70

F.A.P. RTE.	SECTION	COUNTY	TOTAL SHEETS	SHEET NO.
709	(113R)RS-1	CHAMPAIGN	65	40
FED. ROAD DIST. NO.			ILLINOIS FED. AID PROJECT	
			CONTRACT NO. 70117	