

SEC 7 , T24N, R5E, 3RD PM

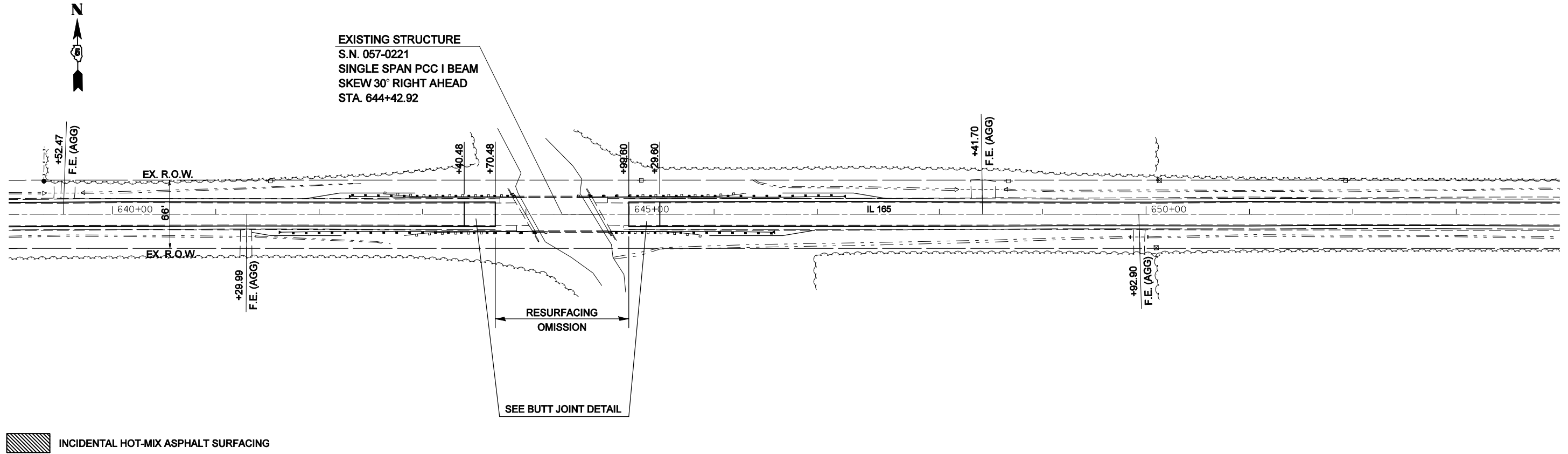

SEC 7 , T24N, R5E, 3RD PM

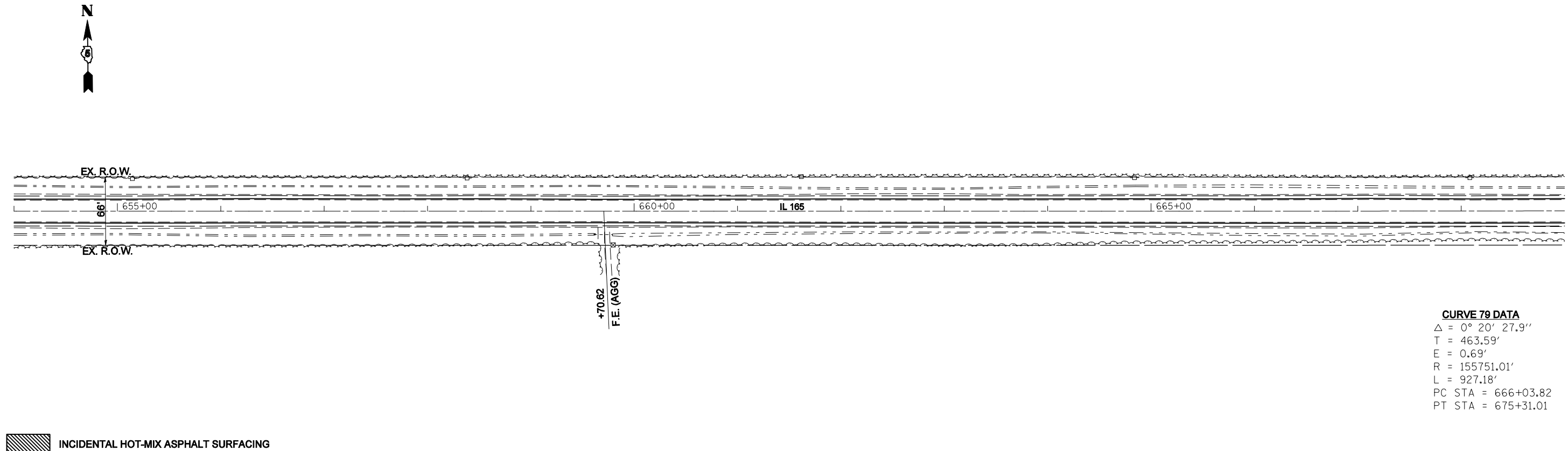

CURVE 79 DATA
 $\Delta = 0^\circ 20' 27.9''$
 T = 463.59'
 E = 0.69'
 R = 155751.01'
 L = 927.18'
 PC STA = 666+03.82
 PT STA = 675+31.01

FILE NAME =	USER NAME = coombessf	DESIGNED -	REVISED -
ct:\pw\work\PWIDOT\COOMBESSF\dms87296\0770510-sht-plan.dgn		DRAWN -	REVISED -
	PLOT SCALE = 100.0000' / IN.	CHECKED -	REVISED -
	PLOT DATE = 1/13/2010	DATE -	REVISED -

STATE OF ILLINOIS
DEPARTMENT OF TRANSPORTATION

PLAN SHEETS

SCALE: SHEET NO. OF SHEETS STA. 639+00.00 TO STA. 669+00.00

F.A.S. RTE.	SECTION	COUNTY	TOTAL SHEETS	SHEET NO.
2484	(125,126,127)RS-2	MCLEAN	122	29
FED. ROAD DIST. NO. ILLINOIS FED. AID PROJECT			CONTRACT NO. 70510	