

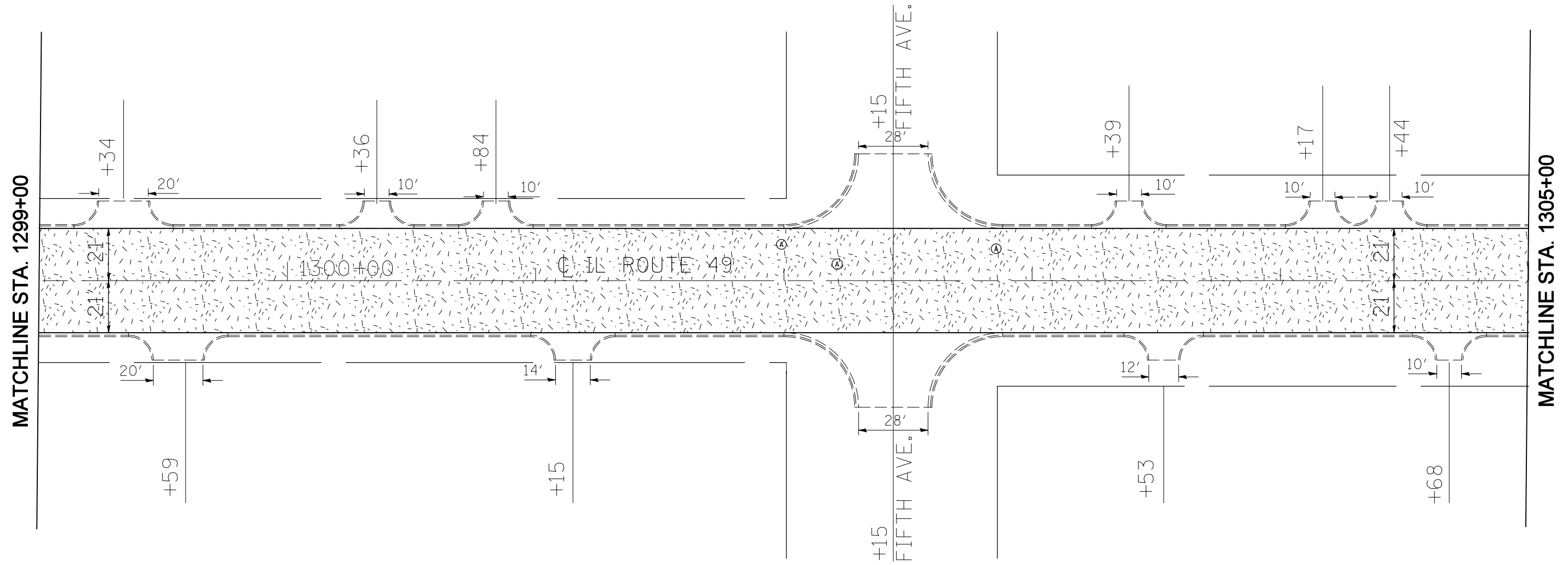

F.A.P. RTE.	SECTION	COUNTY	TOTAL SHEETS	SHEET NO.
840	122 R5-4	VERMILION	42	18
STA. 1299+00		TO STA. 1305+00		
FED. ROAD DIST. NO.	ILLINOIS	FED. AID PROJECT		

SEC. 11, T-23-N, R-14-W

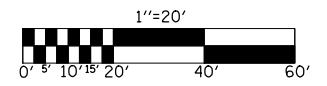

SEC. 12, T-23-N, R-14-W



-  HMA SURFACE REMOVAL, 1 1/2"
- (A) FRAME AND LID TO BE ADJUSTED
- (A) VALVE BOX TO BE ADJUSTED

REVISIONS	
NAME	DATE

ILLINOIS DEPARTMENT OF TRANSPORTATION  
**EXISTING & PROPOSED  
 PLAN SHEETS**  
**VILLAGE OF RANKIN**  
**STA. 1299+00 - 1305+00**

SCALE: VERT. \_\_\_\_\_  
 HORIZ. \_\_\_\_\_

DATE \_\_\_\_\_ DRAWN BY \_\_\_\_\_  
 CHECKED BY \_\_\_\_\_

PLOT DATE = 1/25/2010  
 FILE NAME = c:\p\p\work\p\11001\BUCKLES\11\10124902\planets.dgn  
 PLOT SCALE = 42,352% / IN.  
 USER NAME = bucklesj