

# LOCATION MAP 1

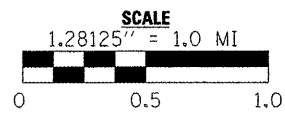
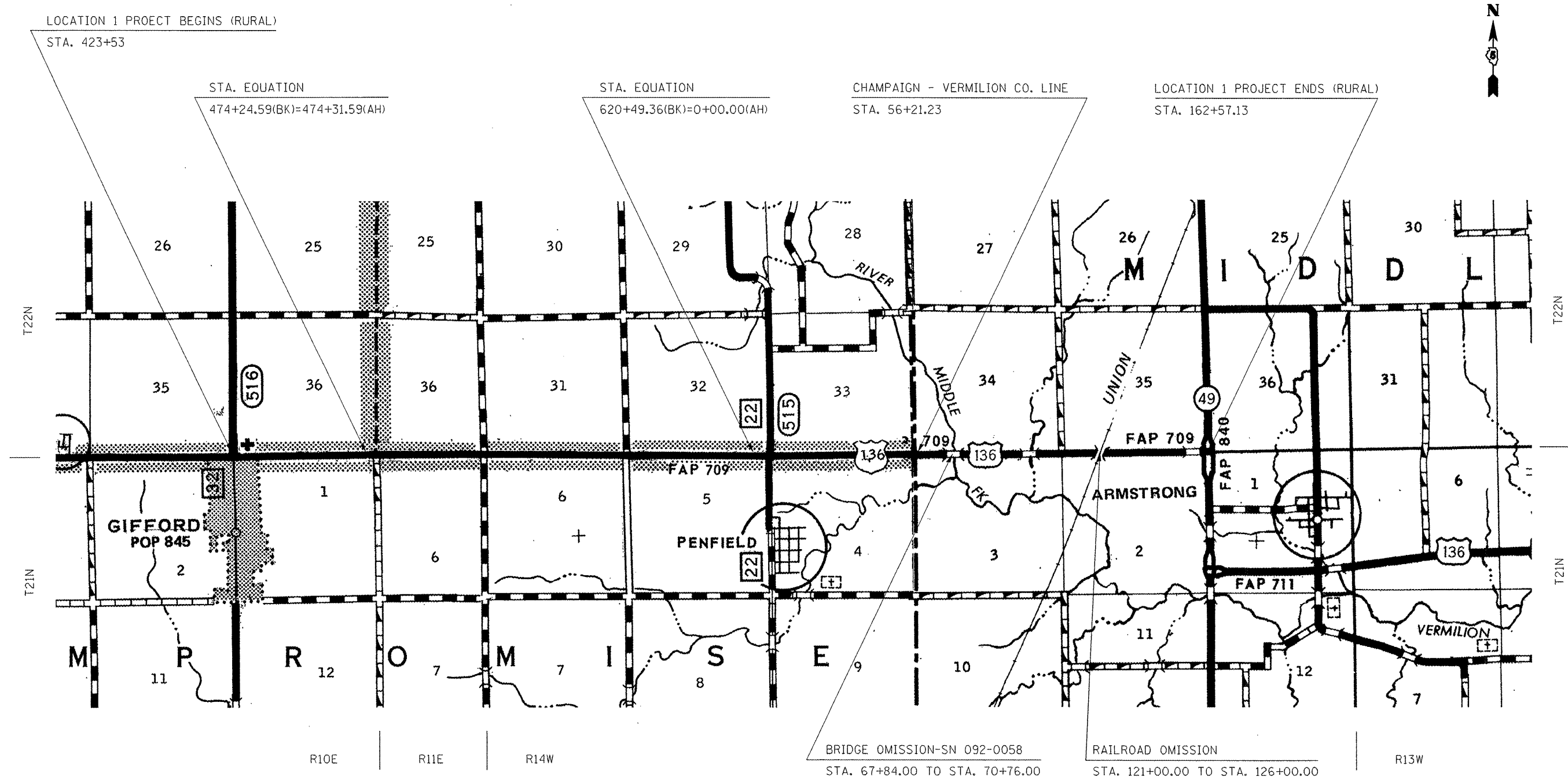

GROSS LENGTH OF LOCATION #1 = 35,946.49 FT. = 6.808 MILE  
NET LENGTH OF LOCATION #1 = 35,154.49 FT. = 6.658 MILE

\*D5 CRACK & JOINT SEAL 2010-2

FILE NAME =	USER NAME = craigre	DESIGNED - JAH	REVISED -	<b>STATE OF ILLINOIS DEPARTMENT OF TRANSPORTATION</b>	<b>LOCATION MAP 1</b>	F.A. RTE.	SECTION	COUNTY	TOTAL SHEETS	SHEET NO.	
cd:\pw_work\psw\dot\craigre\d0176226\0578	30-SHT-COVER.dgn	DRAWN -	REVISED -			VAR	.	VARIOUS	24	3	
	PLOT SCALE = 40.0000 "/td> <td>CHECKED -</td> <td>REVISED -</td> <td colspan="6" style="text-align: center;">CONTRACT NO. 70830</td>	CHECKED -	REVISED -			CONTRACT NO. 70830					
	PLOT DATE = 2/4/2010	DATE - 12/23/09	REVISED -			ILLINOIS FED. AID PROJECT					