

LOCATION MAP 3

IL 1 /US 136 DANVILLE

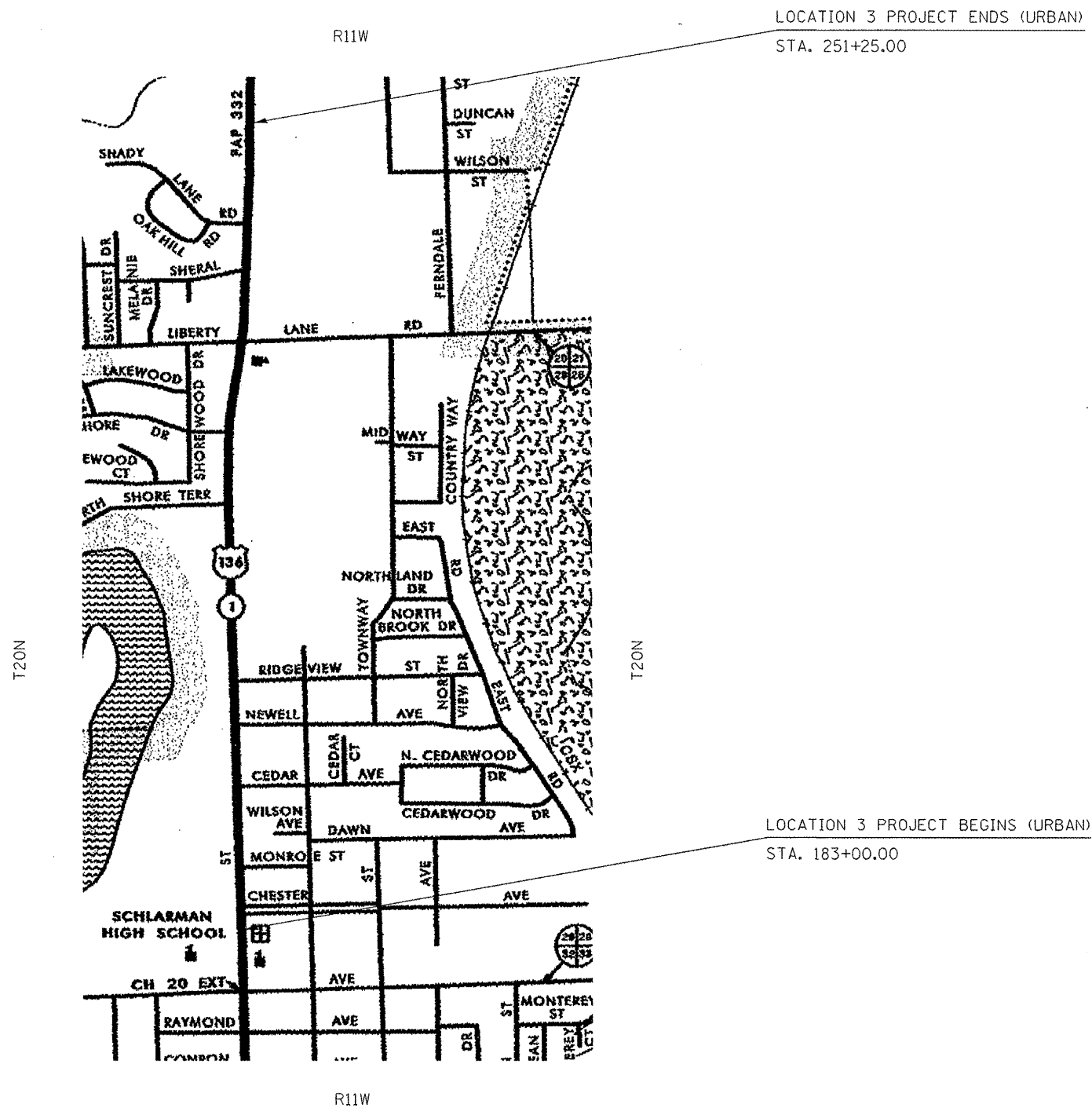

GROSS LENGTH OF LOCATION #3 = 6,825.00 FT. = 1.293 MILE
 NET LENGTH OF LOCATION #3 = 6,825.00 FT. = 1.293 MILE

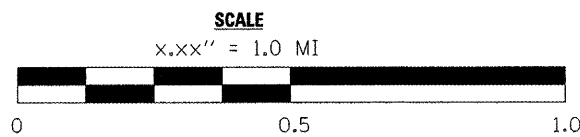

FILE NAME =	USER NAME = cvoigre	DESIGNED - JAH	REVISED -
cs:\pe_work\pwidot\cvoigre\08176226\0570	30-SHT-COVER.dgn	DRAWN -	REVISED -
	PLOT SCALE = 40.0000 ' / IN.	CHECKED -	REVISED -
	PLOT DATE = 2/4/2010	DATE - 12/23/09	REVISED -

**STATE OF ILLINOIS
 DEPARTMENT OF TRANSPORTATION**

LOCATION MAP 3			
SCALE:	SHEET NO. 4 OF 5 SHEETS	STA. 183+00	TO STA. 251+25

*D5 CRACK & JOINT SEAL 2010-2			
F.A. RTE.	SECTION	COUNTY	TOTAL SHEETS
VAR.	.	VARIOUS	24
CONTRACT NO. 70830			SHEET NO. 6
ILLINOIS FED. AID PROJECT			