

**EXISTING STRUCTURE:**

The existing bridge is a single structure constructed on a tangent horizontal alignment and a vertically curved alignment. The bridge is 246.0' back to back of abutments with an out to out width of 32.0'. Clear width is 28.5'. The span lengths from south to north are 105.5' & 105.5'. The bridge is constructed on a 0.0 degree skew.

The superstructure consists of two span continuous welded steel box girders and a 7.5" reinforced concrete deck with a 1.50" bituminous overlay.

The substructure consists of one trapezoidal type reinforced concrete pier, which rests on a concrete pile-supported footing and reinforced concrete vaulted abutments on concrete piles

STATE OF ILLINOIS  
DEPARTMENT OF TRANSPORTATION

**GENERAL NOTES**

Reinforcement bars shall conform to the requirements of ASTM A 706 Gr 60. See Special Provisions

Reinforcement bars designated (E) shall be epoxy coated.

Plan dimensions and details relative to existing plans are subject to routine variations. The Contractor shall field verify existing dimensions and details affecting new construction and make necessary approved adjustments prior to construction or ordering of materials. Such variations shall not be cause for additional compensation for a change in scope of the work, however, the Contractor will be paid for the quantity actually furnished based upon the unit price bid for the work.

**PROPOSED WORK**

1. Retrofit concrete parapet. Typical at abutment wingwalls.
2. Modify existing handrail to butt into retrofit parapet.

**DESIGN SPECIFICATIONS**

2002 AASHTO Standard Specifications - 17th ed.

**LOADING HS20-44**

**DESIGN STRESSES**

Cast-in-Place Unit  
f'c = 3500 psi  
f's = 60,000 psi  
n = 9

**INDEX OF SHEETS**

1. General Plan & Elevation
2. Retrofit Concrete Parapet Details

**GENERAL PLAN & ELEVATION**  
**C.H. 34 OVER F.A.I. RTE. 72**  
**SEC. (84-10-3) RS-4**  
**SANGAMON COUNTY**  
**STATION 455+92.17**  
**S.N. 084-0159**

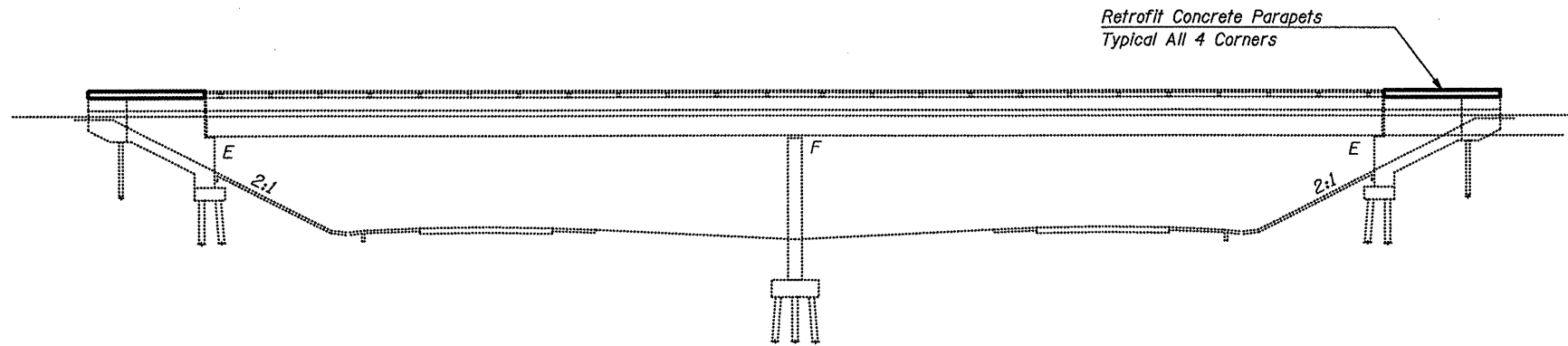

**ELEVATION**

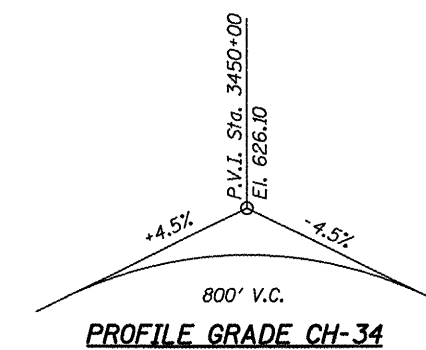

**PROFILE GRADE CH-34**

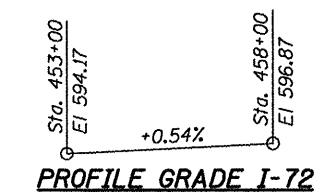

**PROFILE GRADE I-72**

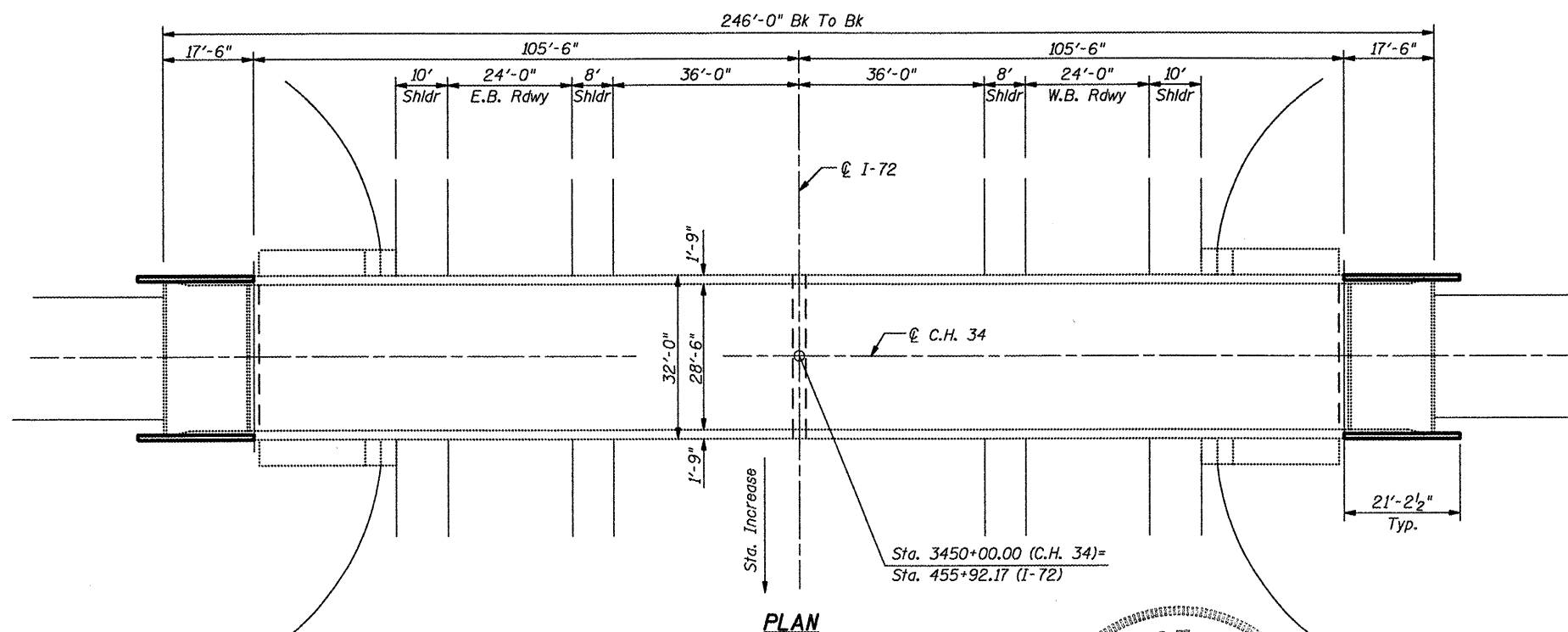

**PLAN**

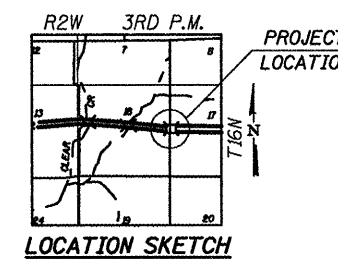

**LOCATION SKETCH**

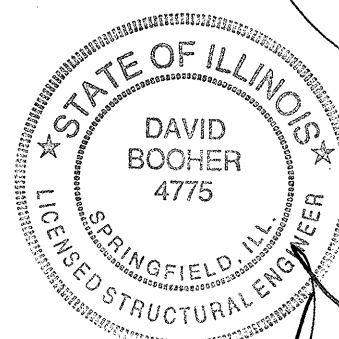

David Booher, Illinois S.E. 081-004775  
Expires 11-30-2010

2-19-2010 Date

DESIGNED	SCD
CHECKED	DRB
DRAWN	THW
CHECKED	-



IE CONSULTANTS, INC  
6420 SOUTH SIXTH STREET  
SPRINGFIELD, ILLINOIS 62712  
TEL. (217) 529-8027  
FAX (217) 529-4543  
IESPRINGFIELD@IE-CONSULTANTS.COM  
WWW.IE-CONSULTANTS.COM

SHEET NO.	F.A.I. RTE.	SECTION	COUNTY	TOTAL SHEETS	SHEET NO.
1 OF 2 SHEETS	72	(84-10-2) RS-3, (84-10-3) RS-4	SANGAMON	61	60
			CONTRACT NO. 72910		
FED. ROAD DIST. NO. 2 ILLINOIS FED. AID PROJECT					