

STATE OF ILLINOIS
DEPARTMENT OF TRANSPORTATION
DIVISION OF HIGHWAYS

PROPOSED HIGHWAY PLANS

FAP 614 ROUTE (IL 78)
SECTION 8CS(RS-3) ; 146(RS-3)

RESURFACING
CASS COUNTY

C-96-102-07

D-96-102-07

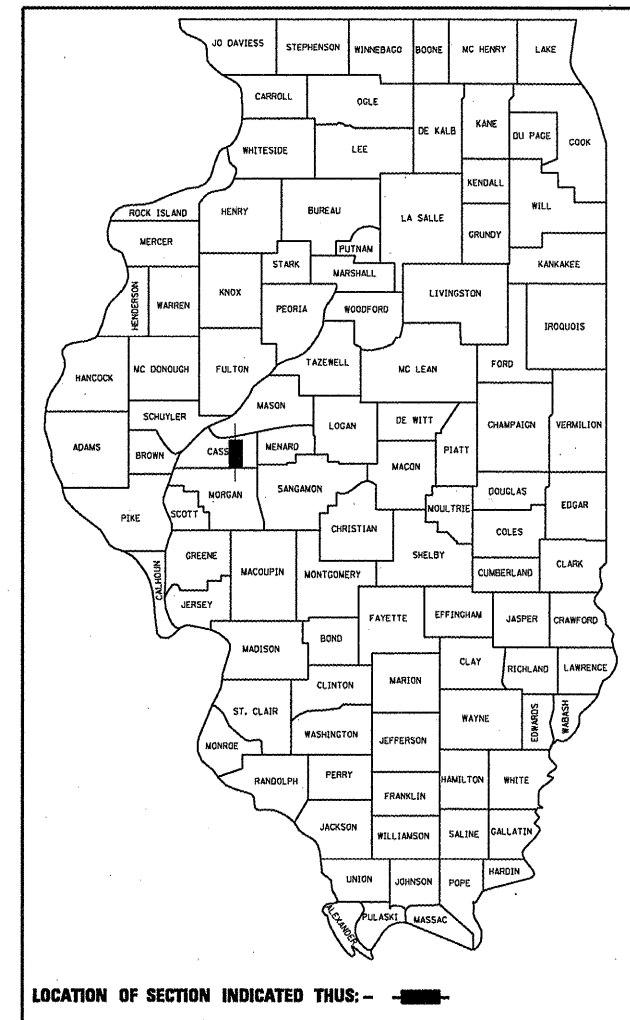

INDEX OF SHEETS	
SHEET NO.	DESCRIPTION
1	COVER SHEET
2	GENERAL NOTES
3-5	SUMMARY OF QUANTITIES
6-9	SCHEDULE OF QUANTITIES
10-11	TYPICAL SECTIONS
12	ALIGNMENT SHEET
13-14	ENTRANCE DETAILS

14A, 14B PAVEMENT MARKING DETAILS

IDOT HIGHWAY STANDARDS		
000001-05	701006-03	701326-03
482011-03	701011-02	701501-05
604026-02	701201-03	701901-01
604036-02	701301-03	780001-02
701001-02	701306-02	781001-03

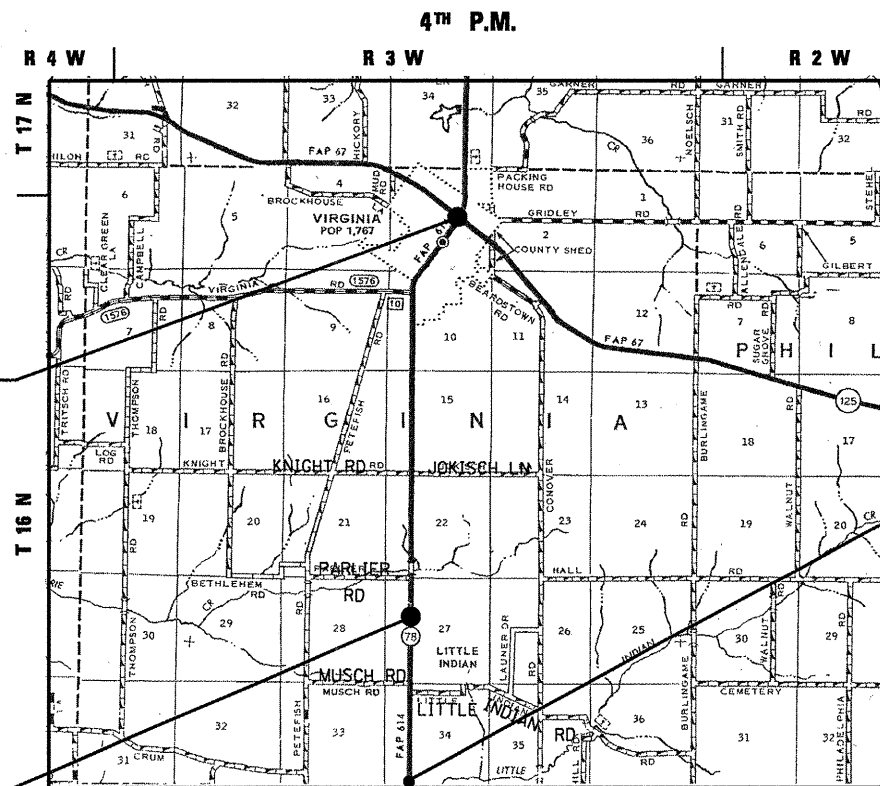

END IMPROVEMENTS
STA. 295 + 87

BEGIN IMPROVEMENTS
STA. 3 + 11

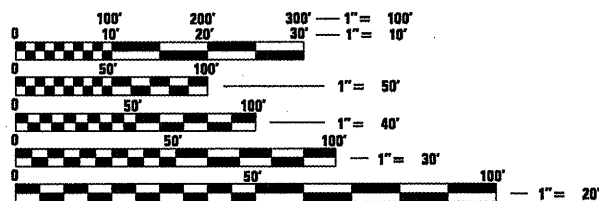

FULL SIZE PLANS HAVE BEEN PREPARED USING STANDARD ENGINEERING SCALES. REDUCED SIZED PLANS WILL NOT CONFORM TO STANDARD SCALES. IN MAKING MEASUREMENTS ON REDUCED PLANS, THE ABOVE SCALES MAY BE USED.

J.U.L.I.E.
JOINT UTILITY LOCATION INFORMATION FOR EXCAVATION
1-800-892-0123
OR 811

STA. EQUATION
STA. 85 + 62.38 BK =
STA. 85 + 30.18 AH

APPROXIMATE SCALE: 0 1 2 MILES
TOTAL LENGTH = 29,308.2 FEET = 5.55 MILES
NET LENGTH OF PROJECT = 29,308.2 FEET = 5.55 MILES
HIGHWAY CLASSIFICATION = MINOR COLLECTOR
ADT = 2039 (2007)
PV = 1834 (90.0%)
SU = 123 (6.0%)
MU = 82 (4.0%)



STATE OF ILLINOIS
DEPARTMENT OF TRANSPORTATION
DIVISION OF HIGHWAYS

SUBMITTED *Feb 11 20 10*
Raja D. D. D.
DEPUTY DIRECTOR OF HIGHWAYS, REGION ENGINEER

March 19 20 10
Scott E. Stitt, P.E.
ACTING ENGINEER OF DESIGN AND ENVIRONMENT

March 19 20 10
Christine M. Reed, P.E.
DIRECTOR OF HIGHWAYS, CHIEF ENGINEER

PRINTED BY THE AUTHORITY
OF THE STATE OF ILLINOIS

PROJECT ENGINEER: JOHN NEGANGARD (217) 782-6990
SQUAD LEADER: MARK DUST (217) 785-0597

CONTRACT NO. 72B25

Rev. 4-1-10