

**STATE OF ILLINOIS
DEPARTMENT OF TRANSPORTATION
DIVISION OF HIGHWAYS**

**PROPOSED
HIGHWAY PLANS**

**F.A.S. ROUTE 1597 (IL 96)
SECTION 12(RS-7) & 13(RS-6)**

**RESURFACING (SMART)
ADAMS COUNTY**

F.A.S. RTE.	SECTION	COUNTY	TOTAL SHEETS	SHEET NO.
1597	12(RS-7) & 13(RS-6)	ADAMS	29	1
FED. ROAD DIST. NO.	ILLINOIS	CONTRACT NO. 72B26		

INDEX OF SHEETS	
SHEET NO.	DESCRIPTION
1	COVER SHEET
2	GENERAL NOTES
3-4	SUMMARY OF QUANTITIES
5-6	SCHEDULE OF QUANTITIES
7	TYPICAL SECTIONS
8-29	PLAN AND PROFILE SHEETS



IDOT HIGHWAY STANDARDS		
000001-05	701011-02	701501-05
442201-03	701201-03	701901-01
701001-02	701301-03	780001-02
701006-03	701306-02	781001-03

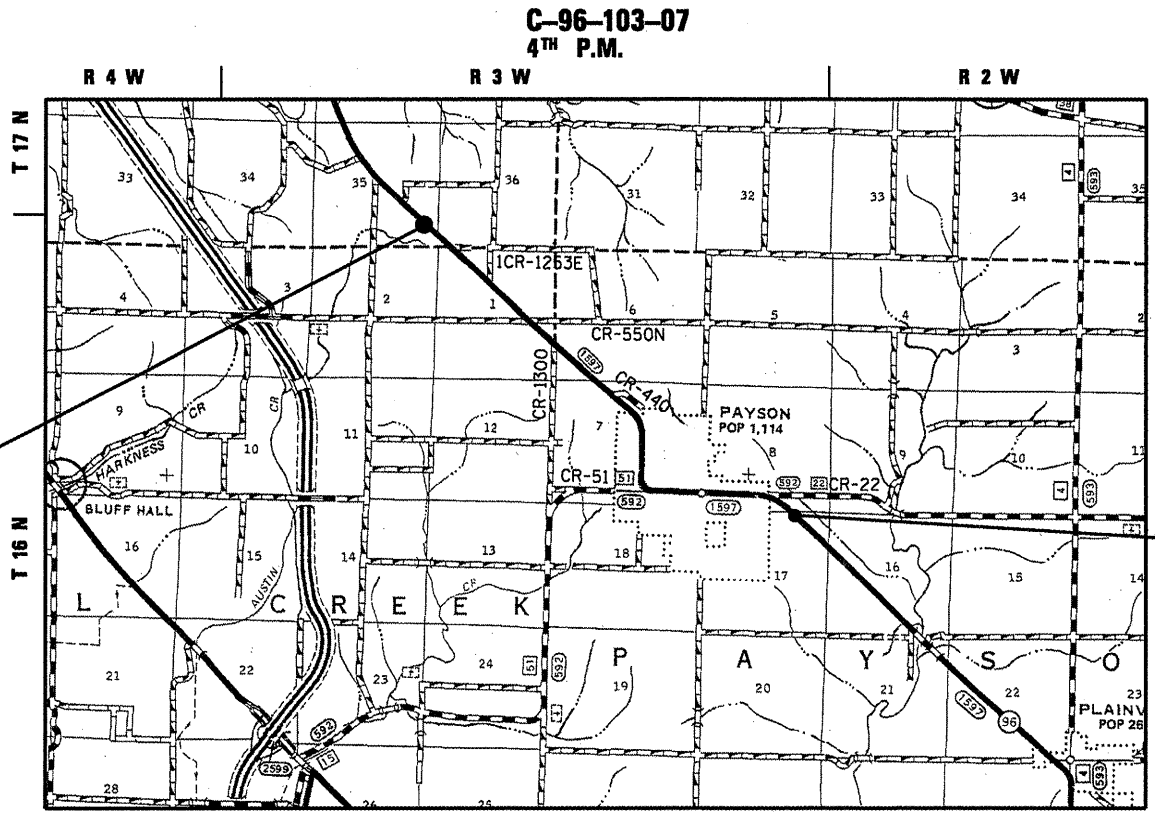

**END IMPROVEMENTS
STA. 1890 + 09**

**BEGIN IMPROVEMENTS
STA. 1698 + 55**

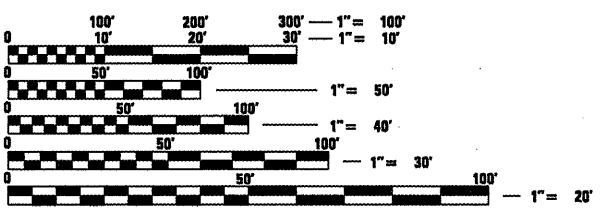

FULL SIZE PLANS HAVE BEEN PREPARED USING STANDARD ENGINEERING SCALES. REDUCED SIZED PLANS WILL NOT CONFORM TO STANDARD SCALES. IN MAKING MEASUREMENTS ON REDUCED PLANS, THE ABOVE SCALES MAY BE USED.

J.U.L.I.E.
JOINT UTILITY LOCATION INFORMATION FOR EXCAVATION
1-800-892-0123
OR 811

APPROXIMATE SCALE: 0 1 2 MILES

TOTAL LENGTH = 19,154 FEET = 3.63 MILES
NET LENGTH OF PROJECT = 19,154 FEET = 3.63 MILES
HIGHWAY CLASSIFICATION = MAJOR COLLECTOR

ADT = 2077 (2007)
PV = 2004 (96.5%)
SU = 71 (3.1%)
MU = 2 (0.1%)

STATE OF ILLINOIS
DEPARTMENT OF TRANSPORTATION
DIVISION OF HIGHWAYS

SUBMITTED February 4, 2010
Regan Z. Driskell
DEPUTY DIRECTOR OF HIGHWAYS, REGION ENGINEER

March 19, 2010
Scott E. Stith, P.E. DR
ENGINEER OF DESIGN AND ENVIRONMENT

March 19, 2010
Christine M. Reed DR
DIRECTOR OF HIGHWAYS, CHIEF ENGINEER

**PRINTED BY THE AUTHORITY
OF THE STATE OF ILLINOIS**

PROJECT ENGINEER: JOHN NEGANGARD (217) 782-6990
SQUAD LEADER: MARK DUST (217) 785-0597

CONTRACT NO. 72B26