

STATE OF ILLINOIS
DEPARTMENT OF TRANSPORTATION
DIVISION OF HIGHWAYS

PROPOSED
HIGHWAY PLANS

FAS ROUTE 1585 (IL 10)
SECTION 3T

MASON COUNTY
C-96-108-08

| | | | | |
|---------------------|---------|----------|--------------------|-----------|
| F.A.S. RTE. | SECTION | COUNTY | TOTAL SHEETS | SHEET NO. |
| 1585 | 3T | MASON | 20 | 1 |
| FED. ROAD DIST. NO. | | ILLINOIS | CONTRACT NO. 72B52 | |

D-96-008-08

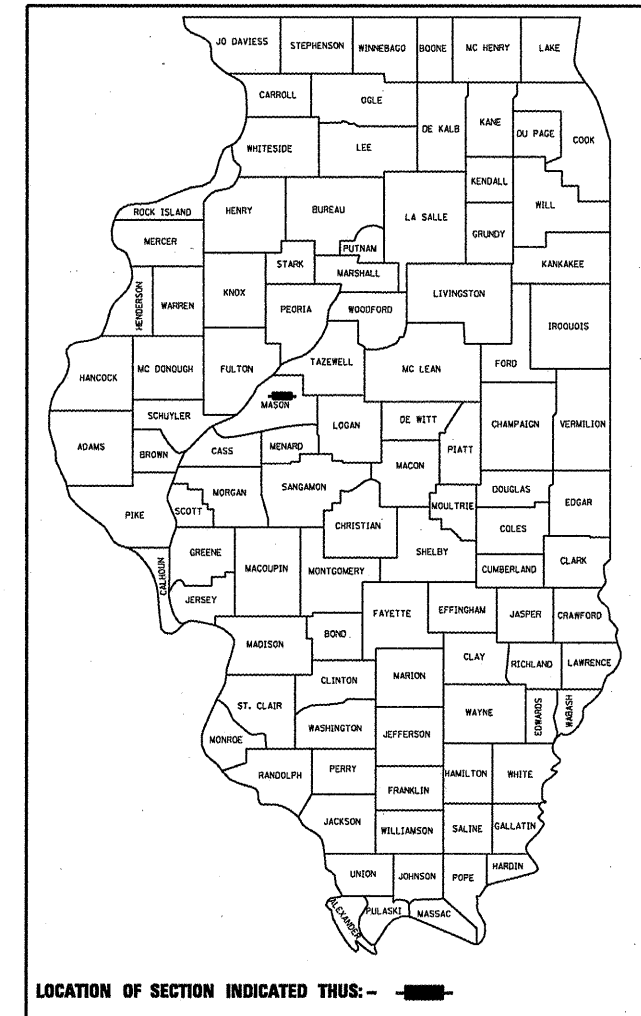

AADT = 1350 (2005)
 DAILY TRUCK = 250 (2005)
 MU = 100
 SU = 150

INDEX OF SHEETS

| SHT. NO. | DESCRIPTION |
|----------|-----------------------------------|
| 1 | COVER SHEET |
| 2 | GENERAL NOTES & HIGHWAY STANDARDS |
| 3 | SUMMARY OF QUANTITIES |
| 4 | TYPICAL SECTION |
| 5-6 | SCHEDULE OF QUANTITIES |
| 7-8 | DRAINAGE PLAN AND PROFILE SHEETS |
| 9-10 | DETAILS |
| 11-20 | CROSS SECTIONS |

START IMPROVEMENT
STA 815+12

END IMPROVEMENT
STA 822+20

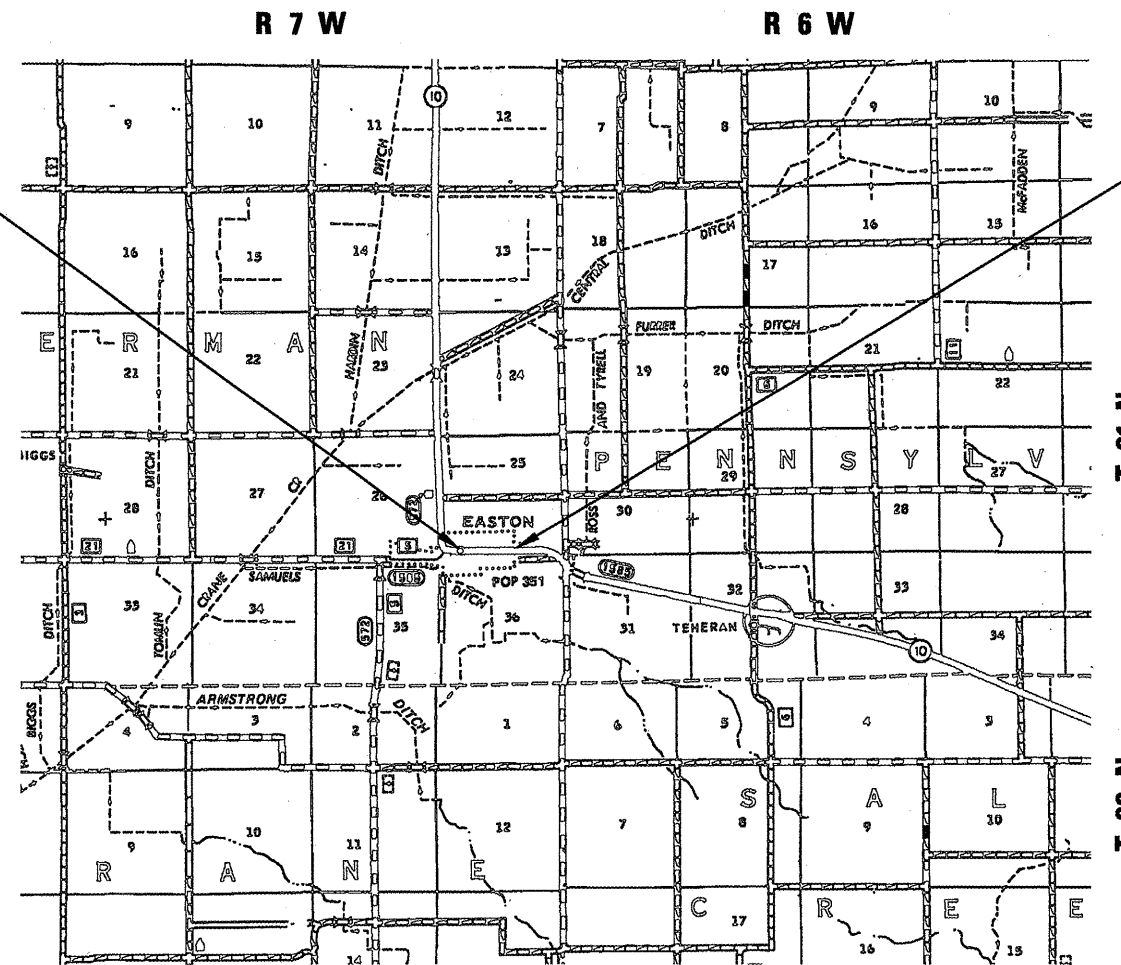

TOTAL PROJECT LENGTH = 708.00 feet = 0.134 miles

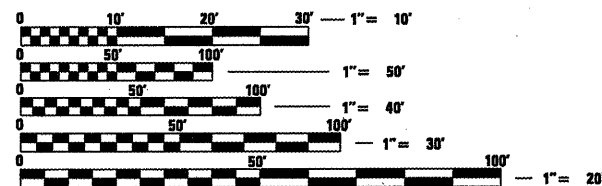

FULL SIZE PLANS HAVE BEEN PREPARED USING STANDARD ENGINEERING SCALES. REDUCED SIZED PLANS WILL NOT CONFORM TO STANDARD SCALES. IN MAKING MEASUREMENTS ON REDUCED PLANS, THE ABOVE SCALES MAY BE USED.

J.U.L.I.E.
 JOINT UTILITY LOCATION INFORMATION FOR EXCAVATION
 1-800-892-0123
 OR 811

STATE OF ILLINOIS
 DEPARTMENT OF TRANSPORTATION
 DIVISION OF HIGHWAYS

SUBMITTED *February 8, 2010*
Roger D. Dick
 DEPUTY DIRECTOR OF HIGHWAYS/REGION ENGINEER

March 19, 2010
Scott E. Stett, P.E.
 ENGINEER OF DESIGN AND ENVIRONMENT

March 19, 2010
Christine M. Reed
 DIRECTOR OF HIGHWAYS, CHIEF ENGINEER

PRINTED BY THE AUTHORITY
OF THE STATE OF ILLINOIS

CONTRACT NO. 72B52

SQUAD LEADER VICTOR YOUNG (217) 557-7897
 PROJECT ENGINEER JOHN NEGANGARD (217) 782-6990