

F.A.P. RTE.	SECTION	COUNTY	TOTAL SHEETS	SHEET NO.
310	69-2LS	MORGAN	16	12
STA.		TO STA.		
FED. ROAD DIST. NO.		ILLINOIS FED. AID PROJECT		

SEEDING LEGEND

 PROPOSED SEEDING CLASS 4 (MODIFIED)

SEC 8, T15N, R11W, 3rd PM

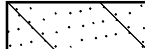
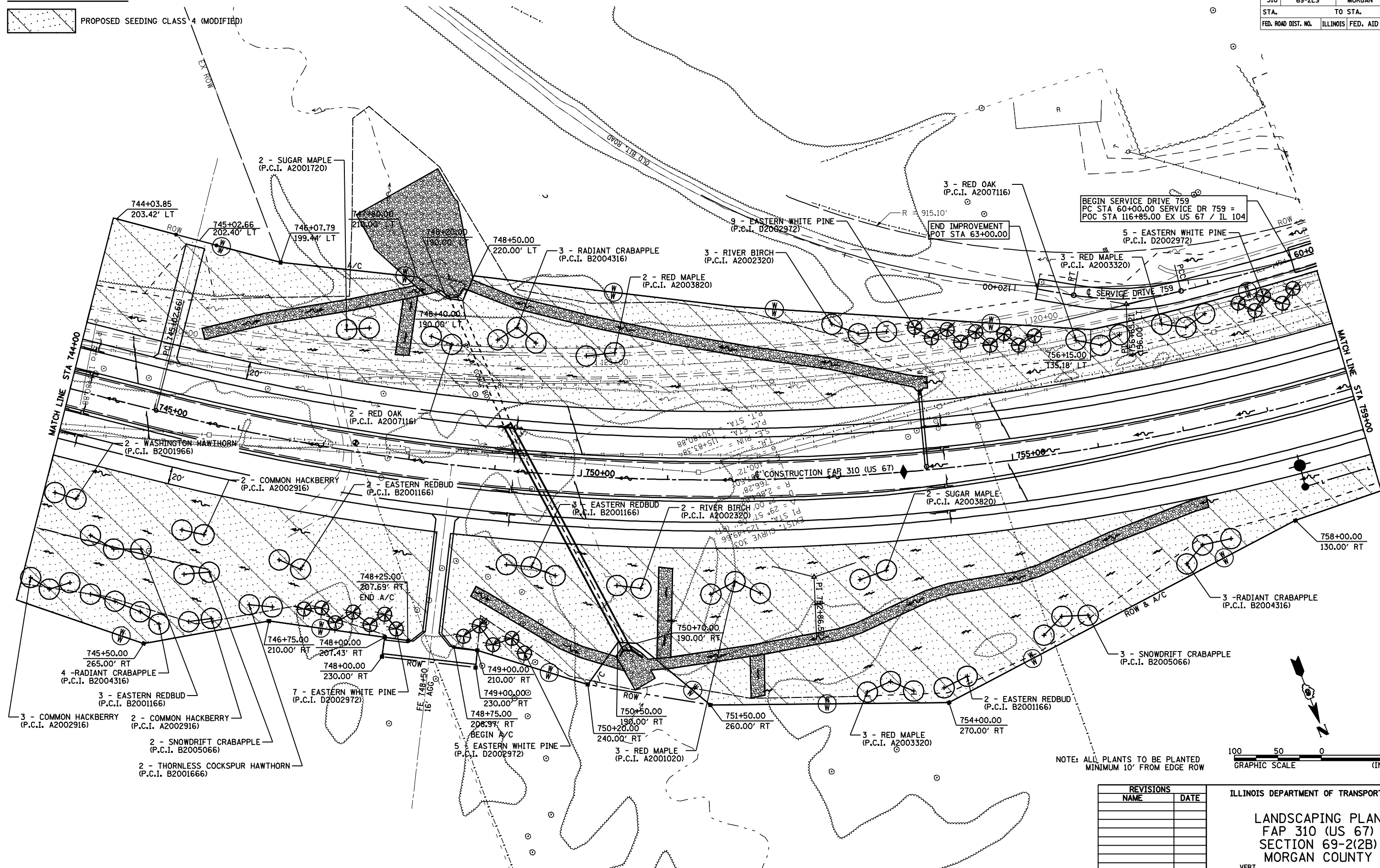

NOTE: ALL PLANTS TO BE PLANTED
MINIMUM 10' FROM EDGE ROW

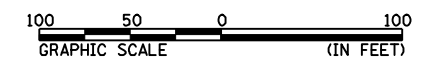

REVISIONS	
NAME	DATE

ILLINOIS DEPARTMENT OF TRANSPORTATION
 LANDSCAPING PLAN
 FAP 310 (US 67)
 SECTION 69-2(B)
 MORGAN COUNTY
 SCALE: VERT. _____ DRAWN BY _____
 HORIZ. _____ CHECKED BY _____
 DATE _____

SEC 8, T15N, R11W, 3rd PM

FAP 310 STA 744+00 TO STA 759+00