

STATE OF ILLINOIS
DEPARTMENT OF TRANSPORTATION

ROUTE NO.	SECTION	COUNTY	POST MILE	SHEET NO.
F.A.P. 63	ADAMS	211	111	9
PROJECT NAME				29 SHEETS
PROJECT NO.				

CONTRACT: 72D51
SHEET 7 OF 13

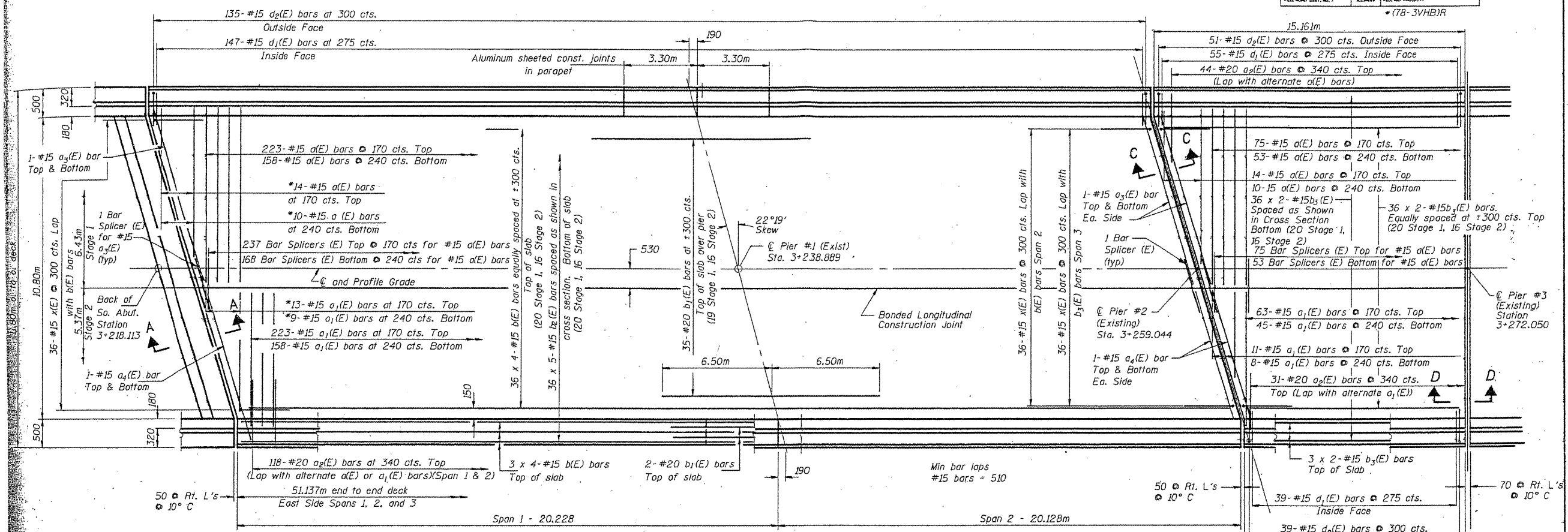

HALF PLAN

Order a(E) & a₁(E) bars full length. Cut to fit skew and use remainder of bars in opposite end (Spans 1 & 2).

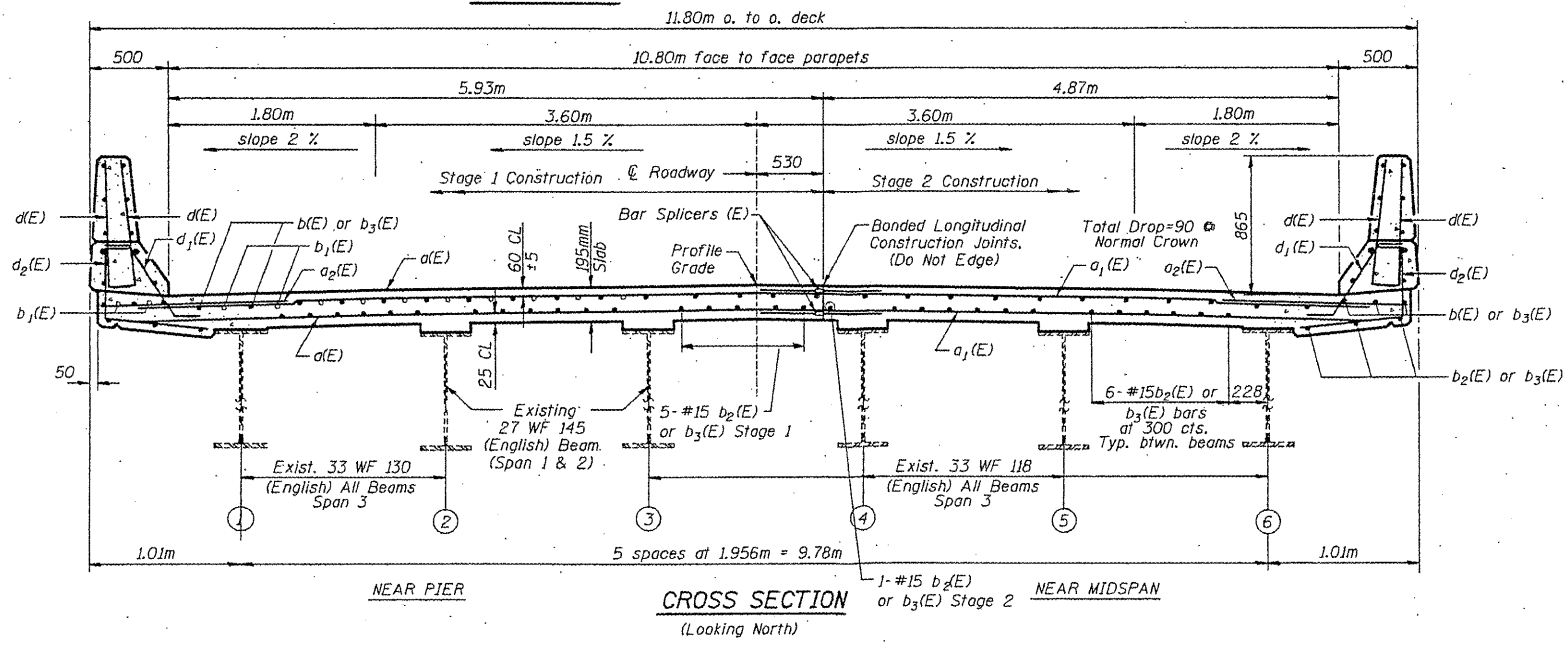

CROSS SECTION
(Looking North)

Notes: See Sheet #11 of 29 for superstructure details and Bill of Material.
Reinforcement bars designated (E) shall be epoxy coated.
Bars indicated thus 20 x 3-#15 etc. indicates 20 lines of bars with 3 lengths per line.
See Sheet #11 of 29 for parapet reinforcement.
All dimensions are in millimeters (mm) except as noted.
See Sheet #12 of 29 for Sections A-A, C-C AND D-D
See Sheet #1 of 29 for drainage scupper locations
Cut reinforcement to clear drainage scuppers

DECK PLAN AND CROSS SECTION
SPANS 1, 2 AND 3
F.A.P. RTE 63 US RTE 24/N. 3RD ST.
OVER CEDAR CREEK
B. N. RAILROAD AND PARK ROAD
SECTION (78-3VHB)R
ADAMS COUNTY
STA. 3+283.664
STRUCTURE NO. 001-0011

DESIGNED	AG
CHECKED	DAF
DRAWN	BJB
CHECKED	ECM

FOR INFORMATION ONLY

EXISTING PLANS, SN 001-0011
FAP 63 (US 24) & 310 (IL 104)
D6REHAB BDGE PAINTING 2010-1
ADAMS & MORGAN COUNTIES