

STATE OF ILLINOIS
DEPARTMENT OF TRANSPORTATION
DIVISION OF HIGHWAYS

**PROPOSED
HIGHWAY PLANS**

FAS ROUTE 2703 (KINMUNDY/LOUISVILLE ROAD)
SECTION (9-VBR)B
PROJECT BRM-2703(102)
CLAY COUNTY
BRIDGE REPLACEMENT
C-97-012-06

F.A.S. RTE.	SECTION	COUNTY	TOTAL SHEETS	SHEET NO.
2703	(9-VBR)B	CLAY	65	9
FED. ROAD DIST. NO.	ILLINOIS	CONTRACT NO. 74136		

★ 65+4=69

D-97-008-06

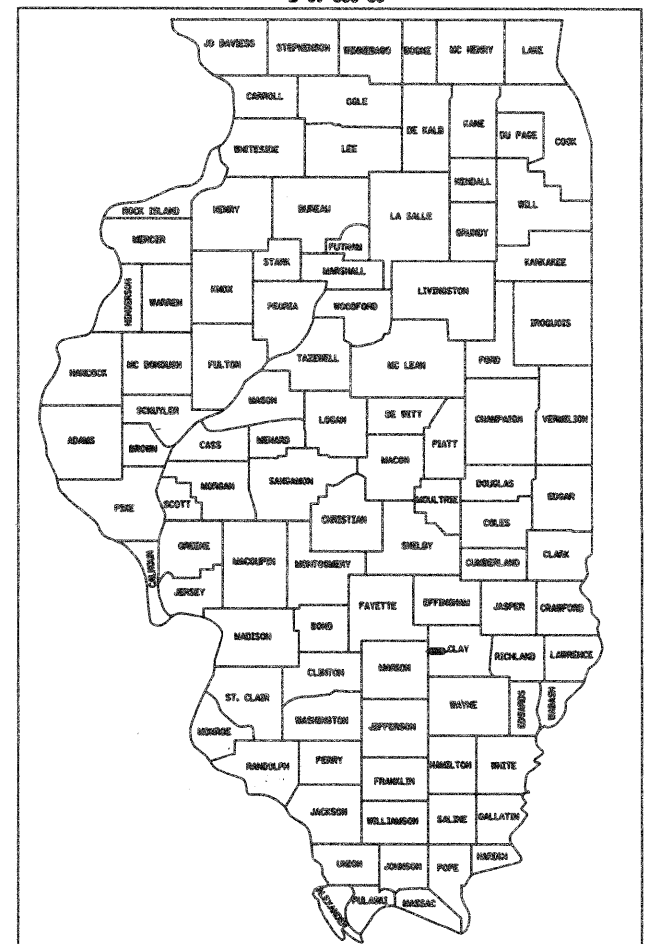

LOCATION OF SECTION INDICATED THUS: - [black rectangle] -

FOR INDEX OF SHEETS, SEE SHEET NO. 2

SN 013-0044
SECTION (9-VBR)B INCLUDES THE COMPLETE REMOVAL OF THE EXISTING 3 SPAN STRUCTURE AND REPLACEMENT WITH A NEW 3 SPAN CONTINUOUS WIDE FLANGE COMPOSITE BEAM STRUCTURE ON REINFORCED CONCRETE ABUTMENTS AND PIERS, BACK TO BACK ABUTMENT OF 163'-11", CARRYING KINMUNDY/LOUISVILLE ROAD OVER ILLINOIS CENTRAL RAILROAD STA 475+50.44

SECTION (9-VBR)B BEGIN
STA 466+49.70

SECTION (9-VBR)B END
STA 486+78.00

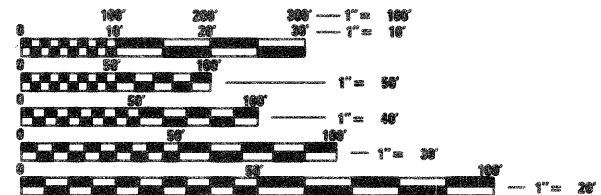
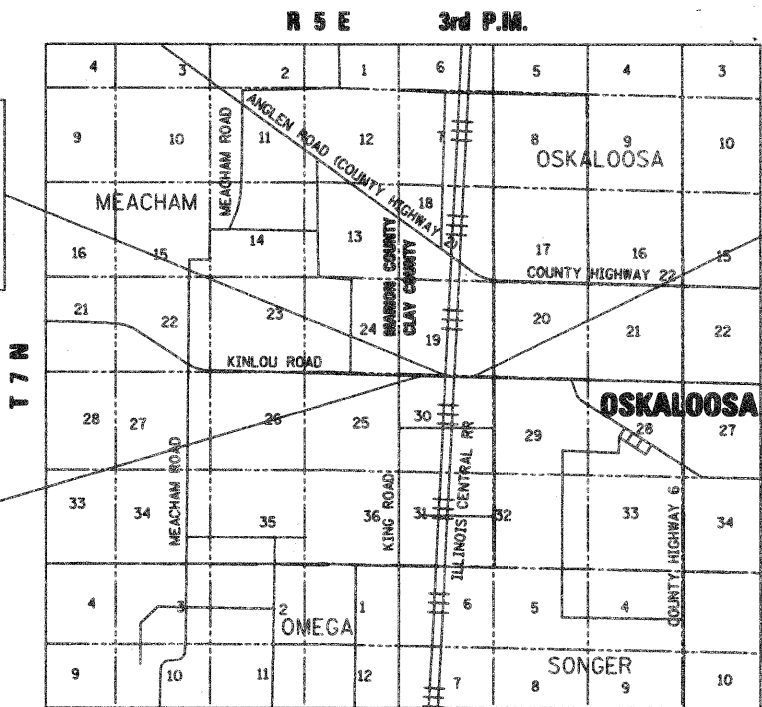

FULL SIZE PLANS HAVE BEEN PREPARED USING STANDARD ENGINEERING SCALES. REDUCED SIZED PLANS WILL NOT CONFORM TO STANDARD SCALES. IN MAKING MEASUREMENTS ON REDUCED PLANS, THE ABOVE SCALES MAY BE USED.

J.U.L.I.E.
JOINT UTILITY LOCATION INFORMATION FOR EXCAVATION
1-800-892-0123
OR 811

PROJECT ENGINEER
PROJECT MANAGER MARK DAUGHERTY

CONTRACT NO. 74136

DESIGN DESIGNATION

FAS ROUTE 2703 RURAL MAJOR COLLECTOR
ADT 650 (2008) 20% TRUCKS
ADT 813 (2029)

OSKALOOSA TOWNSHIP



LOCATION MAP

GROSS SECTION LENGTH = 2028.30 FEET = 0.384 MILES
NET SECTION LENGTH = 2028.30 FEET = 0.384 MILES



ILLINOIS PROFESSIONAL ENGINEER NO. 062-050429
EXP. 11-30-2009
DATE 12-04-08

STATE OF ILLINOIS
DEPARTMENT OF TRANSPORTATION
DIVISION OF HIGHWAYS
SUBMITTED JANUARY 26 2009
Ryan Z. Dinkel
DEPUTY DIRECTOR OF HIGHWAYS, REGION ENGINEER
May 8, 2009
Charles G. Ingersoll
ENGINEER OF DESIGN AND ENVIRONMENT
May 8, 2009
Christine M. Reed
DIRECTOR OF HIGHWAYS, CHIEF ENGINEER



BERNARDIN * LOCHMULLER & ASSOCIATES, INC.
3 OAK DRIVE
MARYVILLE, ILLINOIS 62062
PHONE (618) 288-4885
FAX (618) 288-4886

**PRINTED BY THE AUTHORITY
OF THE STATE OF ILLINOIS**