

PLAN	SURVEYED	DATE
NOTE BOOK	PLOTTED	BY
NO.	CHECKED	
	FILED	
	NO.	
	FILE NAME	

PROFILE	SURVEYED	DATE
NOTE BOOK	PLOTTED	BY
NO.	CHECKED	
	FILED	
	NO.	
	FILE NAME	

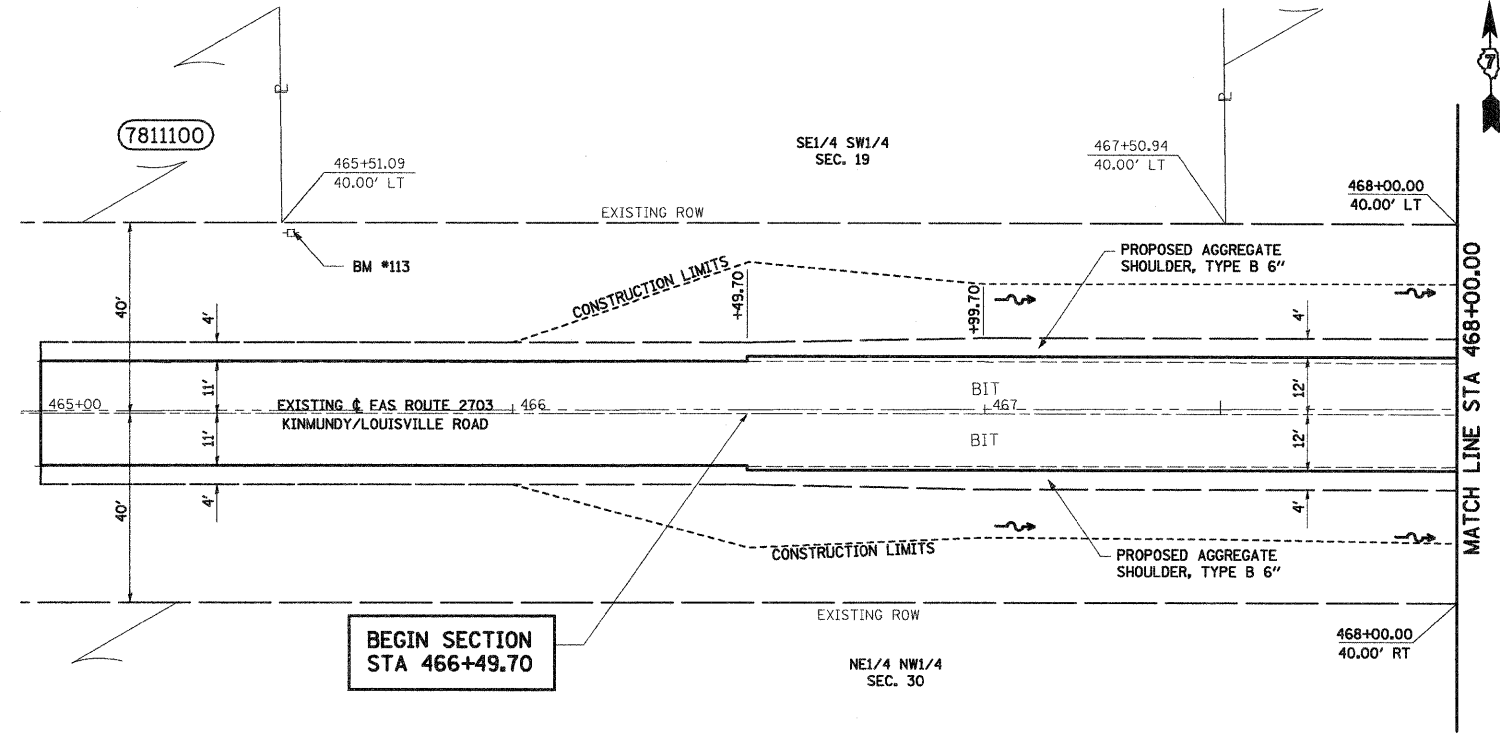

BENCHMARK #113:  
 STA 465+53, 37.1' LT. RAILROAD SPIKE IN POWER POLE #D34-17-3-1-9  
 ELEV. 563.105

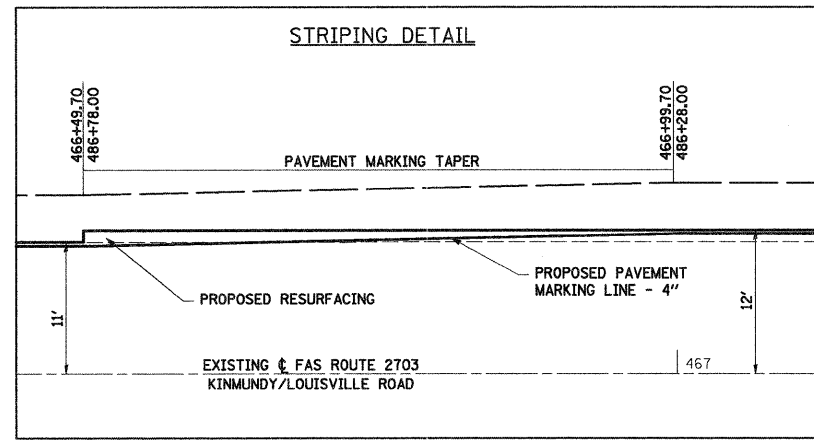
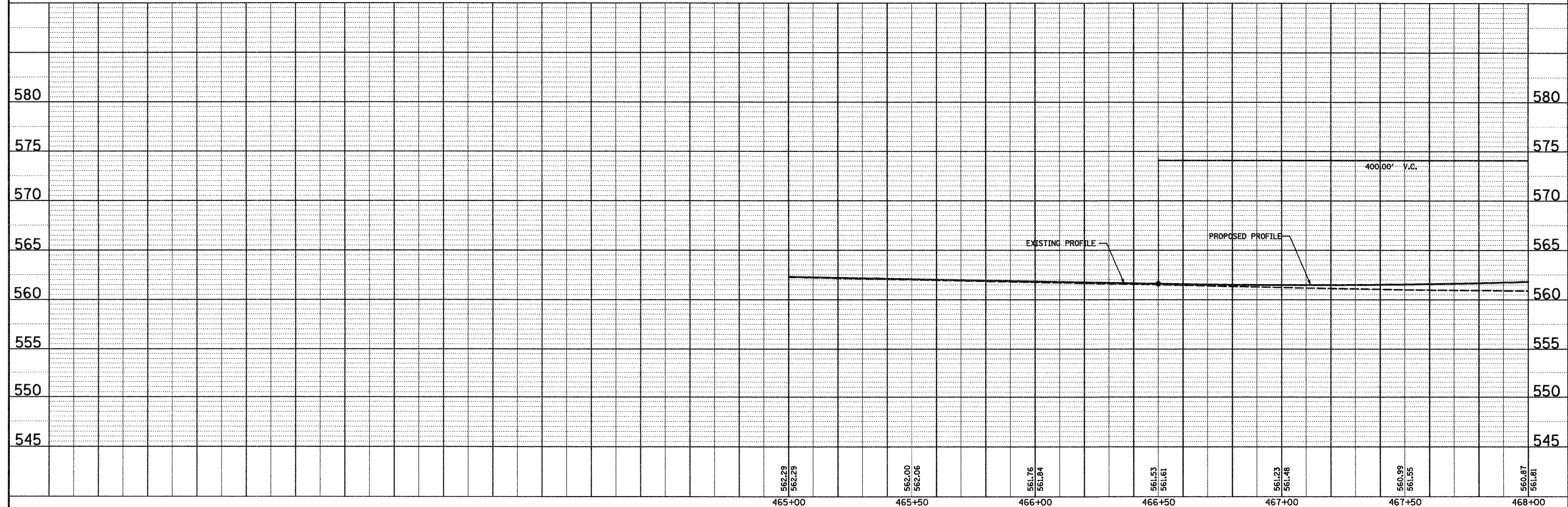
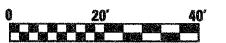

FILE NAME =	USER NAME = paul	DESIGNED - JLS	REVISED -	<b>STATE OF ILLINOIS DEPARTMENT OF TRANSPORTATION</b>	<b>PLAN AND PROFILE, KINMUNDY/LOUISVILLE ROAD</b>	F.A.S. RTE. 2703	SECTION (9-VBR)B	COUNTY CLAY	TOTAL SHEETS 65	SHEET NO. 10	
PLOT SCALE = 20.000' / IN.	CHECKED - BRM	REVISED -	SCALE: 1"=20'			SHEET NO. 1 OF 5 SHEETS	STA. 465+50.00 TO STA. 468+00.00	CONTRACT NO. 74136		FED. ROAD DIST. NO.	ILLINOIS FED. AID PROJECT
PLOT DATE = 12/5/2008	DATE - 4-08-08	REVISED -									