

PLAN	DATE
BY	
REVIEWED	
PLOTTED	
NOTE BOOK	
NO.	
CHECKED	
FILE NAME	

PROFILE	DATE
BY	
REVIEWED	
PLOTTED	
NOTE BOOK	
NO.	
CHECKED	
FILE NAME	

SE1/4 SE1/4
SEC. 19

END SECTION
STA 486+78.00

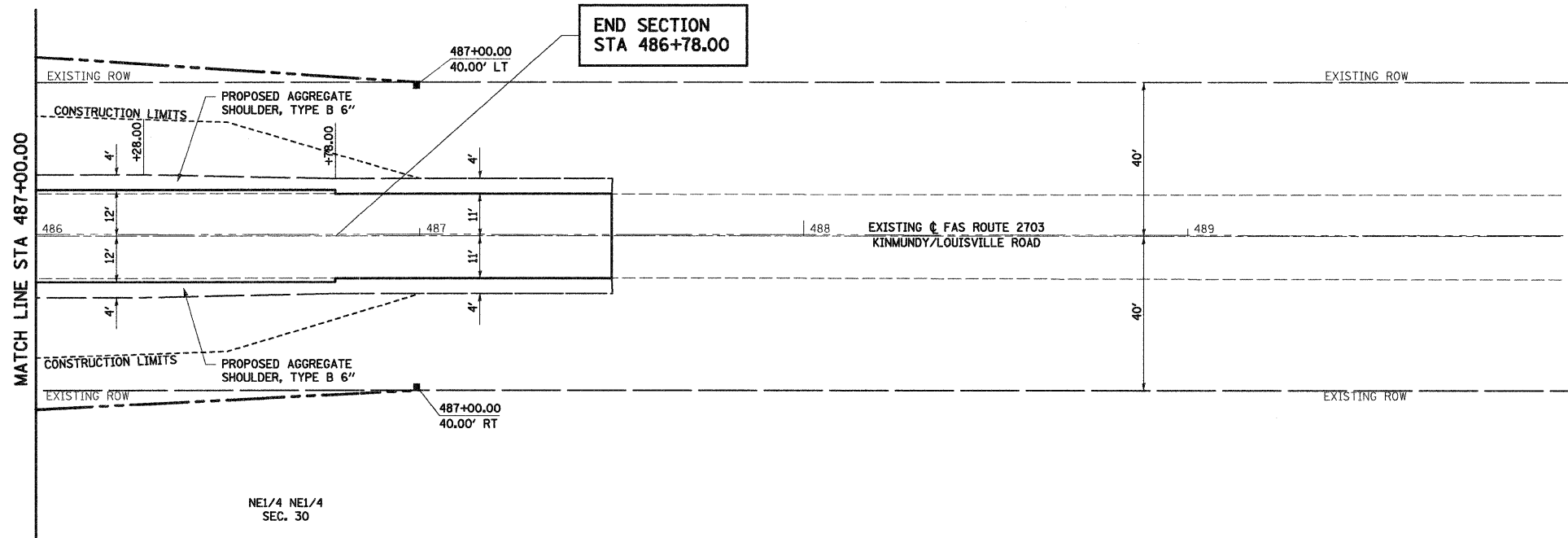

NE1/4 NE1/4
SEC. 30

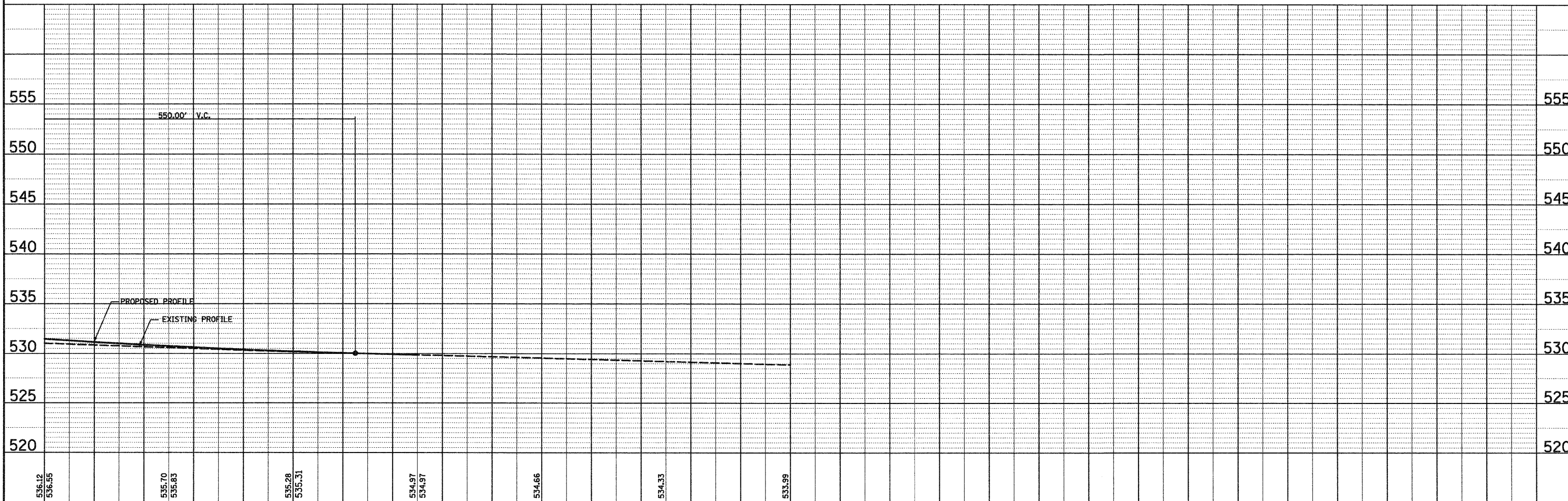
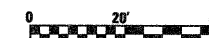

486+00	486+50	487+00	487+50	488+00	488+50	489+00	489+50
536.12 536.65	535.70 535.83	535.28 535.31	534.97 534.97	534.66	534.33	533.99	

FILE NAME =	USER NAME = paul	DESIGNED - JLS	REVISED -
PROJECT: 487-0008 (88) Dist 7 Kinmundy over IRR/DP/PP Kinmundy		DRAWN - MAB	REVISED -
	PLLOT SCALE = 20.000' / IN.	CHECKED - BRM	REVISED -
	PLLOT DATE = 12/3/2008	DATE - 4-08-08	REVISED -

STATE OF ILLINOIS DEPARTMENT OF TRANSPORTATION		PLAN AND PROFILE, KINMUNDY/LOUISVILLE ROAD	
SCALE: 1"=20'		SHEET NO. 5 OF 5 SHEETS STA. 486+00.00 TO STA. 489+50.00	
F.A.S. RTE. 2703	SECTION (9-VBR)B	COUNTY CLAY	TOTAL SHEETS 65 SHEET NO. 14
CONTRACT NO. 74136			
FED. ROAD DIST. NO. ILLINOIS FED. AID PROJECT			