

EXISTING STRUCTURE DATA
 Q STATION 854+91.19 (F.A.I. ROUTE 72)
 SKEW 42°-13'-43.7" LT. FOR.
 APPROX. LENGTH 315'-2 3/4"
 (BK.-BK. ABUTMENTS)
 APPROX. HORIZ. CLEARANCE 30'-0"
 CONSTRUCTED AS SECTION 58-66 HB-1
 STRUCTURE No. 058-0097
 DATA OBTAINED FROM OLD PLANS

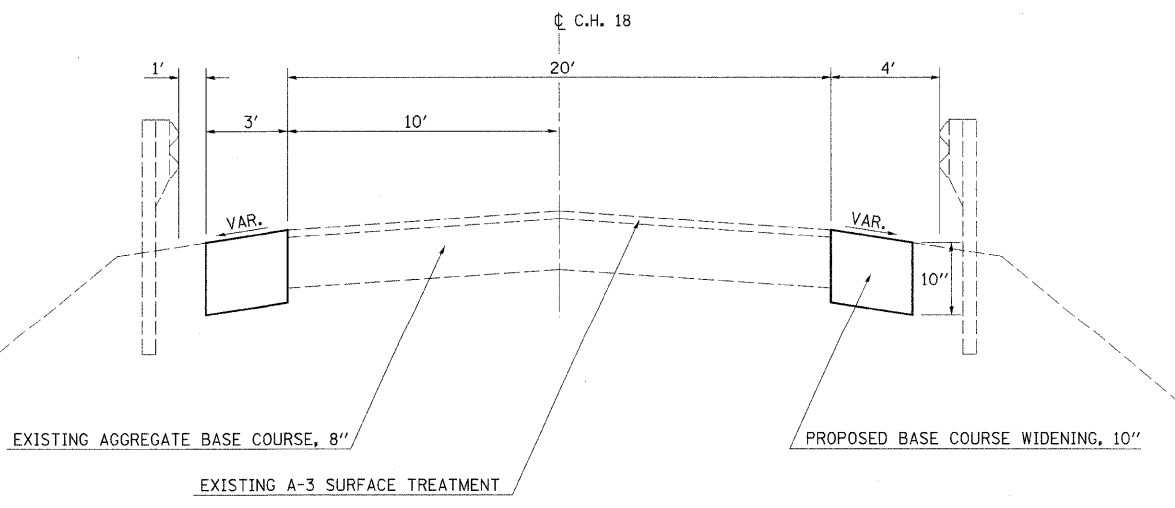
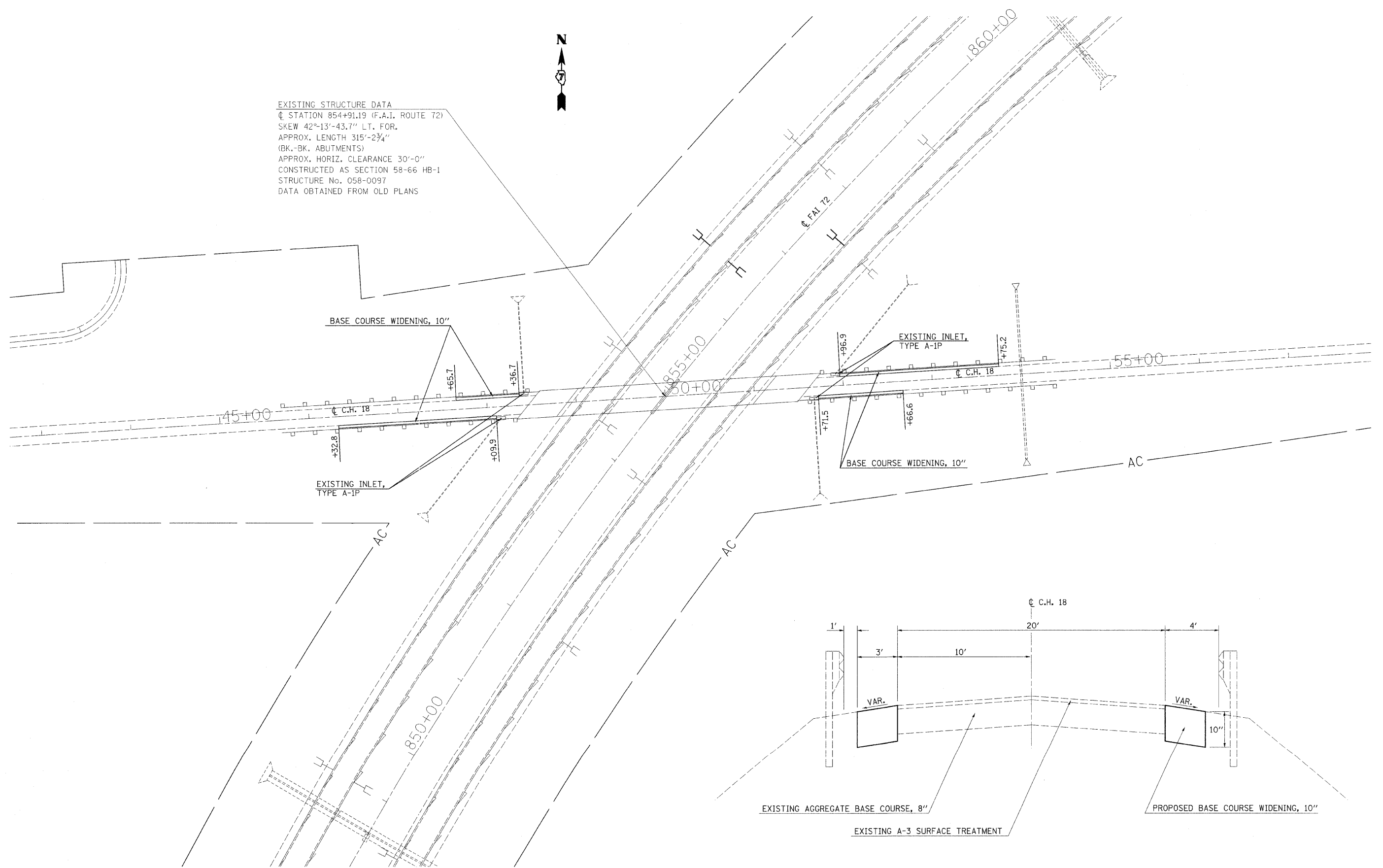

FILE NAME =	USER NAME = swartzrw	DESIGNED -	REVISED -
cr:\pw\work\PWIDOT\SWARTZRW\dms37771\vol1\shp\plan_74343.dgn		DRAWN -	REVISED -
		CHECKED -	REVISED -
		DATE -	REVISED -

**STATE OF ILLINOIS
 DEPARTMENT OF TRANSPORTATION**

C.H. 18 PLAN SHEET

SCALE: 50 SHEET NO. 3 OF 3 SHEETS STA. 43+00 TO STA. 57+00

F.A.I. RTE.	SECTION	COUNTY	TOTAL SHEETS	SHEET NO.
72	66(B,HV8,HB-1)BR	MACON	83	12
CONTRACT NO. 74343				
FED. ROAD DIST. NO. ILLINOIS FED. AID PROJECT				