

PRESTAGE CONSTRUCTION

- PRESTAGE CONSTRUCTION SHALL CONSIST OF CONSTRUCTING THE 6" CONCRETE CURB AND THE 10' WIDENING ON THE NORTH SIDE OF THE PAVEMENT FOR STAGE 1 TRAFFIC. TRAFFIC CONTROL FOR THIS WORK SHALL BE IN ACCORDANCE WITH THE APPLICABLE PORTIONS OF THE TRAFFIC CONTROL AND PROTECTION, STANDARDS 701201 AND 701326.
- ONE LANE OF TRAFFIC IN BOTH DIRECTIONS SHALL BE OPEN TO TRAFFIC AT ALL TIMES DURING THE PRESTAGE CONSTRUCTION
- THE PROPOSED WIDENING SHALL INCLUDE PLACING EARTH EXCAVATION AGAINST WIDENING TO DRAIN. THE WIDENING SHALL CONSIST OF HOT-MIX ASPHALT BASE COURSE-10".

STAGE I CONSTRUCTION

- STAGE I CONSTRUCTION SHALL CONSIST OF REMOVAL OF THE EXISTING HMA SHOULDER AND CONCRETE CURB; CONSTRUCTING THE CCC&G TYPE B6.24 AND THE 10' WIDENING FOR STAGE II TRAFFIC; REMOVAL OF THE PAVEMENT TO THE LIMITS SHOWN ON THE PLANS AND THE EXISTING INLET AND ITS ATTENDING APPURTENANCES; CONSTRUCTING THE PROPOSED BRIDGE APPROACH PAVEMENT, BRIDGE APPROACH PAVEMENT CONNECTOR, AND THE SHOULDER INLET WITH CURB ACCORDING TO STD. 610001; PLACING RIPRAP; AND STAGE I CONSTRUCTION OF THE BRIDGE.
- THE PROPOSED WIDENING SHALL INCLUDE PLACING EARTH EXCAVATION AGAINST WIDENING TO DRAIN. THE WIDENING SHALL CONSISTS OF HOT-MIX ASPHALT BASE COURSE -10".
- TRAFFIC CONTROL FOR STAGE I SHALL BE IN ACCORDANCE WITH THE APPLICABLE PORTIONS OF STANDARD 701321. ANY ADDITIONAL SIGNING OR TRAFFIC CONTROL DEVICES SHOWN IN THE STAGE CONSTRUCTION PLANS SHALL BE CONSIDERED AS INCLUDED IN THE COST OF TRAFFIC CONTROL AND PROTECTION, STANDARD 701321.

STAGE II CONSTRUCTION

- STAGE II CONSTRUCTION SHALL CONSIST REMOVAL OF THE PAVEMENT TO THE LIMITS SHOWN ON THE PLANS; CONSTRUCTING THE PROPOSED BRIDGE APPROACH PAVEMENT, BRIDGE APPROACH PAVEMENT CONNECTOR, AND THE SHOULDER INLET WITH CURB ACCORDING TO STD. 610001; PLACING THE RIPRAP; AND STAGE II CONSTRUCTION OF THE BRIDGE.
- TRAFFIC CONTROL FOR STAGE II SHALL BE IN ACCORDANCE WITH THE APPLICABLE PORTIONS OF STANDARD 701321. ANY ADDITIONAL SIGNING OR TRAFFIC CONTROL DEVICES SHOWN IN THE STAGE CONSTRUCTION PLANS SHALL BE CONSIDERED AS INCLUDED IN THE COST OF TRAFFIC CONTROL AND PROTECTION, STANDARD 701321.

NOTES:

- THE BOTTOM 6" OF THE TEMPORARY CONCRETE BARRIER SHALL BE PAINTED WITH TEMPORARY PAVEMENT MARKING "YELLOW". THE COST FOR THIS SHALL BE CONSIDERED AS INCLUDED IN THE COST OF TEMPORARY CONCRETE BARRIER.
- ALL CONFLICTING PAVEMENT MARKING SHALL BE REMOVED PRIOR TO PLACING PAVEMENT MARKING NECESSARY FOR STAGE CONSTRUCTION.
- IF THE CONTRACTOR CHOOSES THE OPTION OF SAND MODULE IMPACT ATTENUATORS THEN THE LAYOUT SHOWN BELOW SHOULD BE USED.
- THIS PROJECT WILL REQUIRE TEMPORARY RUMBLE STRIP.

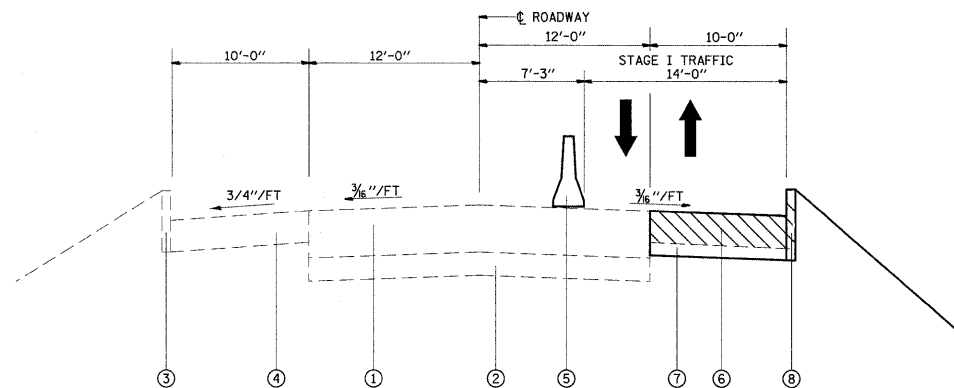

STAGE I TRAFFIC
STA. 786+90.00 TO STA. 788+65.00
STA. 799+27.30 TO STA. 801+34.00

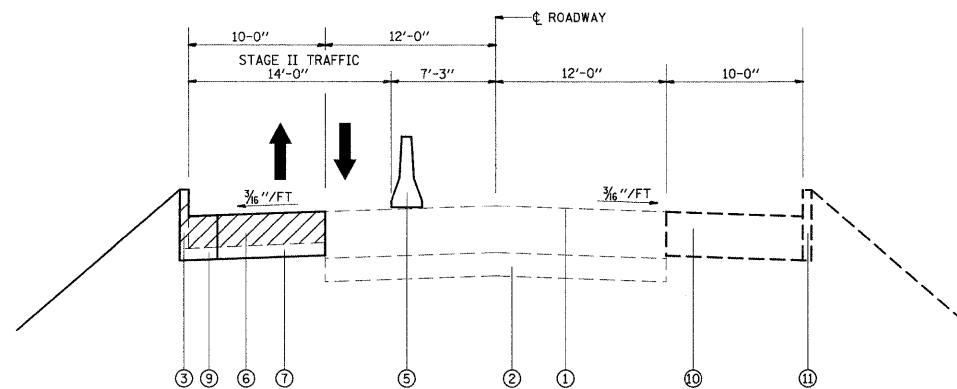

STAGE II TRAFFIC
STA. 785+89.20 TO STA. 788+65.00

NOTE: SEE BRIDGE APPROACH STANDARD FOR DETAILS REGARDING PAVEMENT BETWEEN STATION 788+65.00 TO STATION 789+11.83 AND BETWEEN STATION 798+81.75 TO STATION 799+27.30.

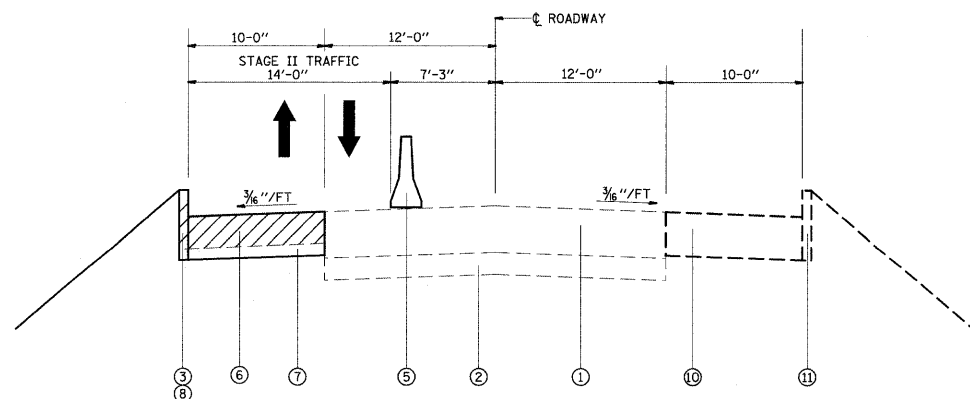

STAGE II TRAFFIC
STA. 799+27.30 TO STA. 801+34.00

LEGEND

- EXISTING PORTLAND CEMENT CONCRETE PAVEMENT - 9"
- EXISTING AGGREGATE BASE COURSE - 6"
- EXISTING CONCRETE CURB - 6"
- EXISTING HMA SHOULDER - 8"
- TEMPORARY CONCRETE BARRIER
- PROPOSED HMA SHOULDER REMOVAL
- PROPOSED HMA BASE COURSE - 10"
- PROPOSED CONCRETE CURB, TY B (DOWELLED)
- PROPOSED CCC&G, TY B6.24
- HMA BASE COURSE PLACED IN PREVIOUS STAGE
- CONCRETE CURB PLACED IN PREVIOUS STAGE

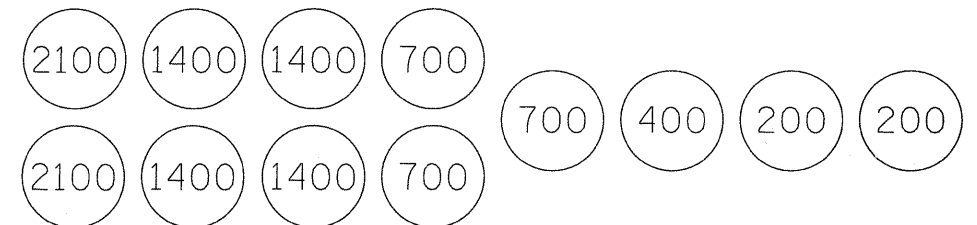

SAND MODULE IMPACT ATTENUATOR

FILE NAME =	USER NAME = manrntm	DESIGNED -	REVISED -	STATE OF ILLINOIS DEPARTMENT OF TRANSPORTATION	STAGE CONSTRUCTION			F.A.P. RTE.	SECTION	COUNTY	TOTAL SHEETS	SHEET NO.
et:\pw\work\p\idot\manrntm\dms52245\p\102205a.dgn		DRAWN -	REVISED -		312	73BR-II	RANDOLPH	51	11	CONTRACT NO. 76883		
PLOT SCALE = 20.0000' / IN.		CHECKED -	REVISED -		SCALE:			SHEET NO. 1 OF 13 SHEETS			STA.	TO STA.
PLOT DATE = 2/17/2010		DATE -	REVISED -		ILLINOIS FED. AID PROJECT							