

EXIST. CURVE C108  
 PI STA. = 27+47.92  
 $\Delta = 13^\circ 18' 44''$  (RT)  
 $D = 7^\circ 40' 32''$   
 $R = 746.46'$   
 $T = 87.11'$   
 $L = 173.43'$   
 $E = 5.07'$   
 $e = \text{-----}$   
 T.R. = -----  
 S.E. RUN = -----  
 P.C. STA. = 26+60.81  
 P.T. STA. = 28+34.25

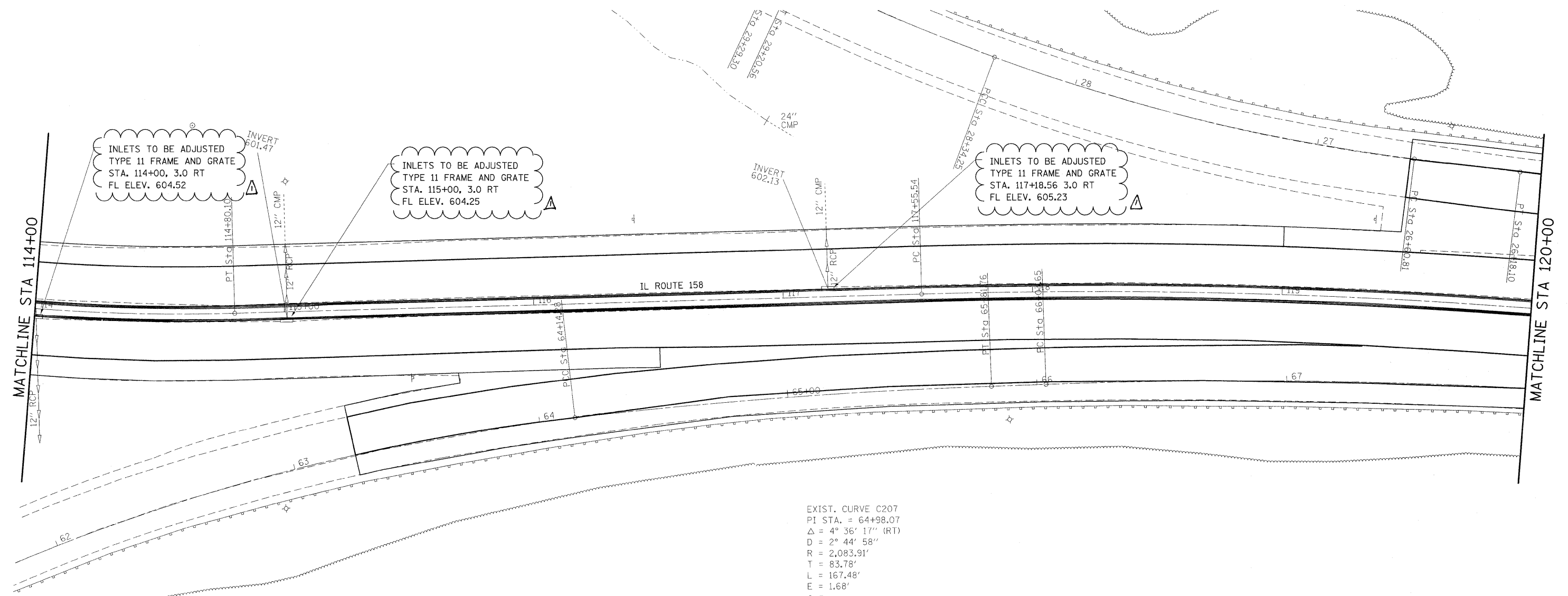

INLETS TO BE ADJUSTED  
 TYPE 11 FRAME AND GRATE  
 STA. 114+00, 3.0 RT  
 FL ELEV. 604.52

INLETS TO BE ADJUSTED  
 TYPE 11 FRAME AND GRATE  
 STA. 115+00, 3.0 RT  
 FL ELEV. 604.25

INLETS TO BE ADJUSTED  
 TYPE 11 FRAME AND GRATE  
 STA. 117+18.56 3.0 RT  
 FL ELEV. 605.23

EXIST. CURVE C206  
 PI STA. = 62+28.63  
 $\Delta = 25^\circ 49' 23''$  (RT)  
 $D = 6^\circ 50' 05''$   
 $R = 838.31'$   
 $T = 192.18'$   
 $L = 377.83'$   
 $E = 21.75'$   
 $e = \text{-----}$   
 T.R. = -----  
 S.E. RUN = -----  
 P.C. STA. = 60+36.46  
 P.T. STA. = 64+14.28

EXIST. CURVE C207  
 PI STA. = 64+98.07  
 $\Delta = 4^\circ 36' 17''$  (RT)  
 $D = 2^\circ 44' 58''$   
 $R = 2,083.91'$   
 $T = 83.78'$   
 $L = 167.48'$   
 $E = 1.68'$   
 $e = \text{-----}$   
 T.R. = -----  
 S.E. RUN = -----  
 P.C. STA. = 64+14.28  
 P.T. STA. = 65+81.76

FILE NAME =	USER NAME = owenbj	DESIGNED -	REVISED -	<b>STATE OF ILLINOIS DEPARTMENT OF TRANSPORTATION</b>	<b>DRAINAGE PLAN</b>			F.A.P. RTE.	SECTION	COUNTY	TOTAL SHEETS	SHEET NO.
ct:\pw\work\p\idot\owenbj\dms52558\p1-000006a.dgn	PLOT SCALE = 20,0000' / IN.	DRAWN -	REVISED -					809	67-1HBR	MONROE	144	50
PLOT DATE = 2/5/2010	DATE -	CHECKED -	REVISED -					CONTRACT NO. 76977				
								FED. ROAD DIST. NO. ILLINOIS FED. AID PROJECT				

Rev. 2-11-10