

DATE: _____
 BY: _____
 SURVEYED: _____
 PLAN: _____
 NOTE BOOK: _____
 RT. OF WAY CHECKED: _____
 PLOD FILE NAME: _____
 NO. _____

DATE: _____
 BY: _____
 SURVEYED: _____
 PROFILE: _____
 NOTE BOOK: _____
 GRADES CHECKED: _____
 B.M. NOTED: _____
 STRUCTURE NOTATIONS CHKD: _____
 NO. _____

BOND/HUDJ
 10-20-2009, 16:46:28
 C:\IC\WORKSPACE\BOND/HUDJ\N\F5-0844.D\TRANS.07\2282\28868-08\1\CIVIL\CD\99-ALL CONTRACTS\CONV\SHEETS\CONTRACT_03\03CONV-03-SHT-DRN\TLLI-5400.DGN

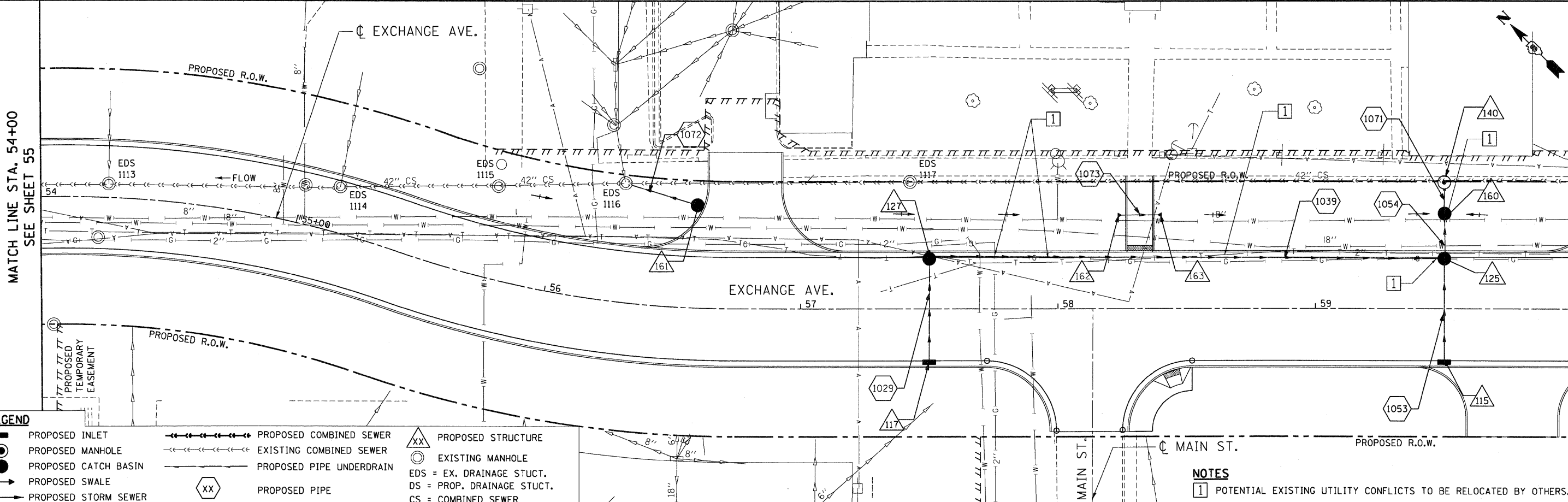

LEGEND

■ PROPOSED INLET	— PROPOSED COMBINED SEWER	△ PROPOSED STRUCTURE
● PROPOSED MANHOLE	--- EXISTING COMBINED SEWER	○ EXISTING MANHOLE
● PROPOSED CATCH BASIN	--- PROPOSED PIPE UNDERDRAIN	○ EDS = EX. DRAINAGE STUCT.
→ PROPOSED SWALE	○ PROPOSED PIPE	○ DS = PROP. DRAINAGE STUCT.
→ PROPOSED STORM SEWER		CS = COMBINED SEWER

NOTES
 1 POTENTIAL EXISTING UTILITY CONFLICTS TO BE RELOCATED BY OTHERS.

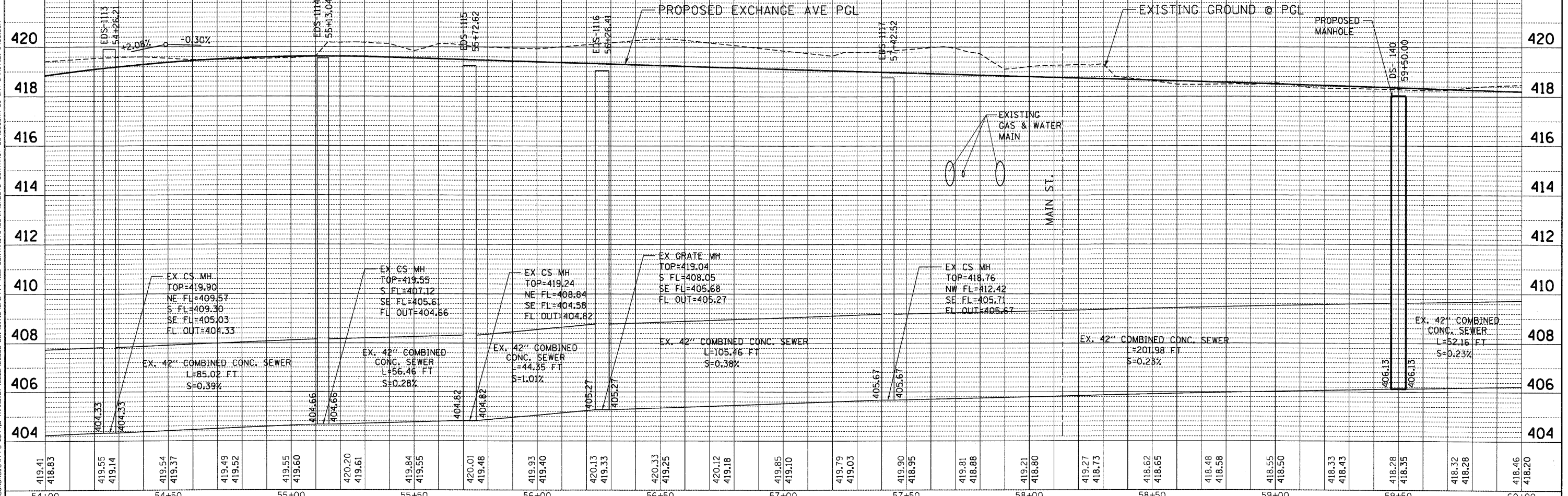

FILE NAME = #FILE#	USER NAME = #USER#	DESIGNED - MMCG	REVISED -	STATE OF ILLINOIS DEPARTMENT OF TRANSPORTATION I-70 CONNECTION	PROPOSED DRAINAGE PLAN & PROFILE EXCHANGE AVENUE STA. 54+00.00 TO STA. 60+00.00		F.A.P. RTE. 9153	SECTION 82-1K	COUNTY ST. CLAIR	TOTAL SHEETS 107	SHEET NO. 56	
PLOT SCALE = #SCALE#	CHECKED - TKL	REVISIED -	REVISIED -		SCALE: HORIZ. 1"=20'	VERT. 1"=2'	STA.	TO STA.	FED. ROAD DIST. NO. ILLINOIS	FED. AID PROJECT	CONTRACT NO. 76C40	
PLOT DATE = #DATE#	DATE 10/09/09	REVISIED -	REVISIED -									
TENG & ASSOCIATES, INC. ENGINEERS/ARCHITECTS/PLANNERS CHICAGO, ILLINOIS												