

Exist. Curve E_109_C4
 PI Sta. 126+42.03
 $\Delta = 34^\circ 34' 40''$ (RT)
 $D = 5^\circ 33' 46''$
 $T = 320.59'$
 $R = 1,030.00'$
 $L = 621.60'$
 $E = 48.74'$
 PC Sta. 123+21.44
 PT Sta. 129+43.04

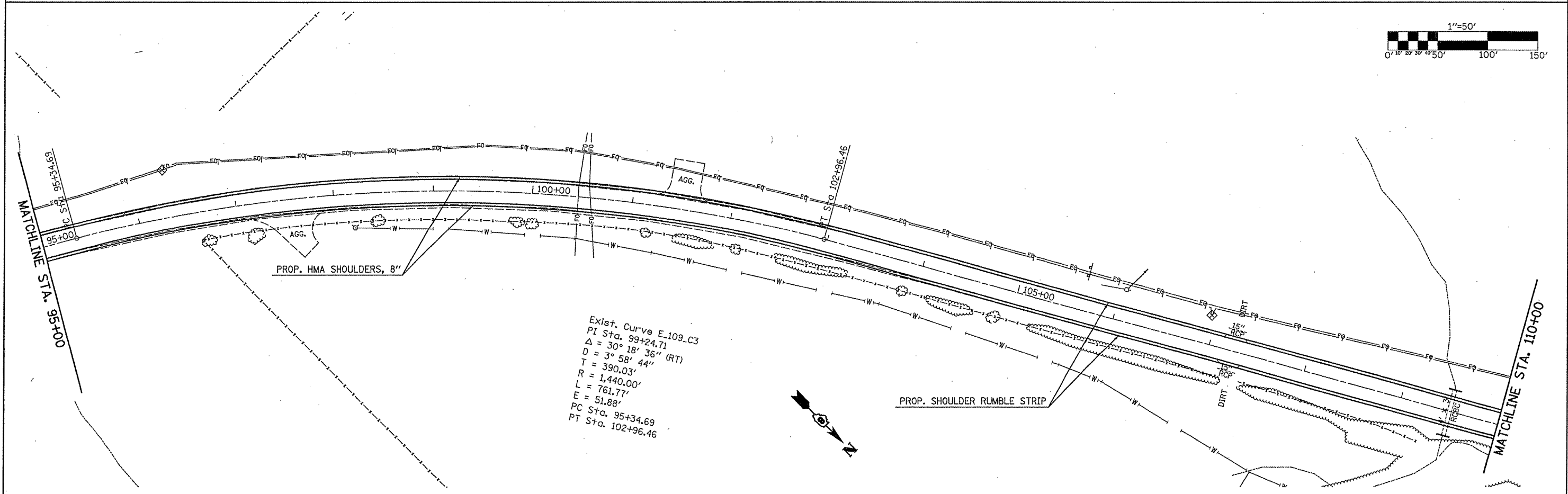
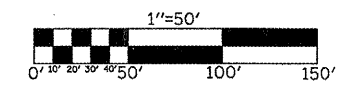

Exist. Curve E_109_C3
 PI Sta. 99+24.71
 $\Delta = 30^\circ 18' 36''$ (RT)
 $D = 3^\circ 58' 44''$
 $T = 390.03'$
 $R = 1,440.00'$
 $L = 761.77'$
 $E = 51.88'$
 PC Sta. 95+34.69
 PT Sta. 102+96.46

FILE NAME = ...AD876039-ah-plot.dgn
 Johnson, Depp & Gulesberry
 CONSULTING ENGINEERS
 Springfield, Illinois

USER NAME = PDR	DESIGNED -	REVISED -
PLOT SCALE = 1/8" = 50' / IN.	DRAWN -	REVISED -
PLOT DATE = 01/06/2010 16:23:49	CHECKED -	REVISED -
	DATE -	REVISED -

**STATE OF ILLINOIS
 DEPARTMENT OF TRANSPORTATION**

PLAN SHEET FAS 747 (ILLINOIS 109)

SCALE: 1" = 50' SHEET NO. 07 OF SHEETS STA. 95+00 TO STA. 125+00

F.A.S. RTE.	SECTION	COUNTY	TOTAL SHEETS	SHEET NO.
747	(57,58,59)-I	JERSEY	22	10
CONTRACT NO. 76D39				
ILLINOIS FED. AID PROJECT				